

quality . service
innovation . integrity

Model 73



"The color green is a registered trademark of Zoeller Pump Co."

Features

BUILDER SERIES:

The 73 model submersible pump is designed for use in residential or light commercial dewatering applications and can be used to transfer groundwater or effluent. The pump includes a cast iron motor housing with a corrosion-resistant, baked-on enamel finish and is designed to provide great heat dissipation from the motor, ensuring a long service life. As with every Zoeller pump, each one is 100% pressure-tested, submerged and run to ensure quality and reliability for years of trouble-free performance! This attention to detail is an inherent feature of every pump, making it one of the most reliable in the industry.

- Includes an integrated vertical float switch.
- Includes a plastic carrying handle for easy transport.
- Hermetically sealed to be watertight, dust-tight, and completely submersible.

Reserve Powered Design: For unusual conditions, a reserve safety factor is engineered into the design of every pump.

Specifications

Motor Characteristics

Motor	1/3 HP
Voltage	115 V
Phase	1 Ph
Hertz	60 Hz
RPM	3450
Type	Permanent split capacitor
Insulation	Class B
Amps	5.5 Amps

Pump Characteristics

Operation	Automatic
Auto On/ Off Points	6½" (16.5 cm), 2½" (6.3 cm)
Discharge Size	1½" NPT
Solids Handling	3/8" (9 mm) spherical solids
Cord Length	9' (3 m) standard
Cord Type	UL listed with 3 prong plug
Max Head	18' (5.5 m)
Max Flow Rate	38 GPM (144 LPM)
Max Operating Temp	104° F (40° C)
Cooling	Oil filled
Motor Protection	Auto reset thermal overload

Materials Characteristics

Motor Housing	Cast iron
Pump Housing	Engineered plastic
Base	Engineered plastic
Upper Bearing	Ball bearing
Lower Bearing	Ball bearing
Mechanical Seals	Carbon and ceramic
Impeller Type	Non-clogging vortex
Impeller	Engineered plastic
Hardware	Stainless steel
Motor Shaft	410 stainless steel
Gasket	NBR



PUMP COMPANY

Zoeller Family of Water Solutions™

FM2928_Ea

Updated 1114
Supersedes New

Model 73

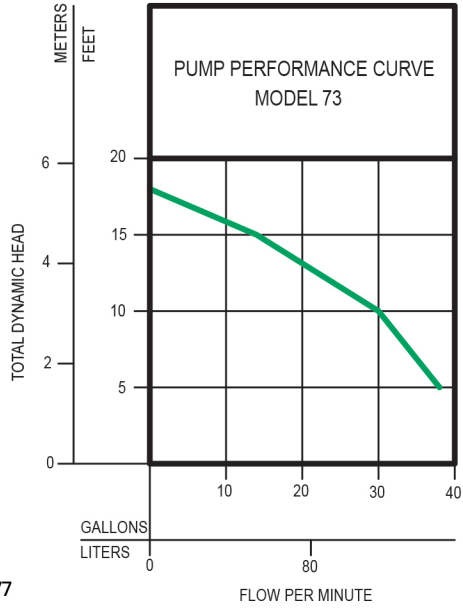

153077

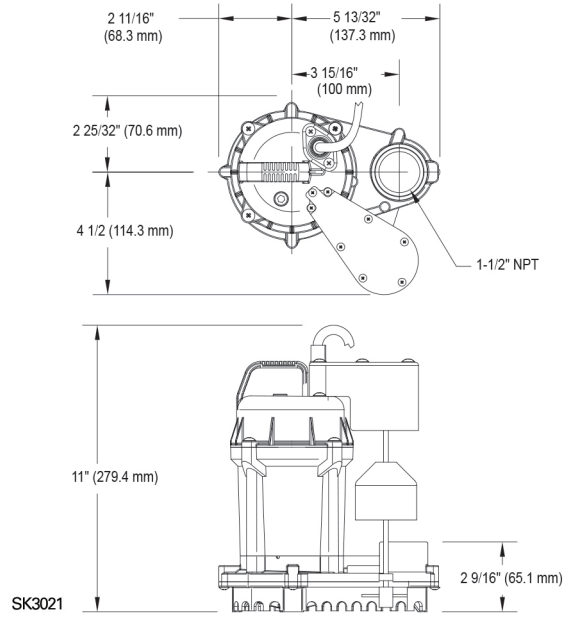

Model

Model Number	Seal	Mode	Volts	Phase	Amps	HP	Hz	Lbs	Kg
M73	Single	Auto	115	1	5.5	1/3	60	12.5	5.6

Optional pump stand (P/N 10-2421) available. The stand, made of durable, non-corrosive ABS, attaches securely to the pump and is intended to reduce clogging by debris, eliminate the need for bricks or blocks under the pump, and provide the ability to raise the intake by adding sections of 1-1/2" or 2" (DN40 or DN50) PVC.

Your Peace of Mind is Our Top Priority®

3649 Cane Run Rd | Louisville, KY 40211 USA

+1 502-778-2731 | 1-800-928-7867 | Fax: +1 502-774-3624

www.zoeller.com

Your Peace of Mind is Our Top Priority®

Product information presented here reflects conditions at time of publication. Consult factory regarding discrepancies or inconsistencies.



PUMP COMPANY

Zoeller Family of Water Solutions™

MAIL TO: P.O. BOX 16347 • Louisville, KY 40256-0347
SHIP TO: 3649 Cane Run Road • Louisville, KY 40211-1961
(502) 778-2731 • 1 (800) 928-PUMP • FAX (502) 774-3624

SECTION: 2.20.029

FM2843

0414

Supersedes

New

visit our web site:
www.zoeller.com

COMPARE THESE FEATURES

- 115V single phase/60 Hz, 1/3 HP, 5.5 Amps, 3450 RPM.
- Thermal overload protection.
- Cast-iron motor housing for maximum heat dissipation
- Powder-coated, cast-iron motor housing
- Stainless steel hardware
- Heat-dissipating, oil-filled motor
- Integral vertical mechanical switch.
- Non-clogging vortex impeller, engineered plastic
- UL Listed 9' cord standard with 3-prong plug.
- Maximum temperature for dewatering - 104°F. (40°C.)
- Passes 3/8" spherical solids.
- 1½" NPT discharge.
- On point - 6-1/2" • Off point - 2-1/2"
- Major width - 8-1/8" • Height - 11"

**ALL MODELS ARE
COMPLETELY SUBMERSIBLE
HERMETICALLY SEALED**
Watertight - dust tight.

Model 73
(For Pump Prefix Identification see News & Views 0052)

**“AQUA-MATE”
SUBMERSIBLE PUMP**
FOR
DEWATERING (SUMP)

**PASSES 3/8" SPHERICAL SOLIDS
1½" NPT DISCHARGE**

 **US**
C Tested to UL Standard UL778 & Certified to CSA Standard C22.2 No. 108

 **POWDER
COATED
TOUGH™**

**AUTOMATIC
MODEL**



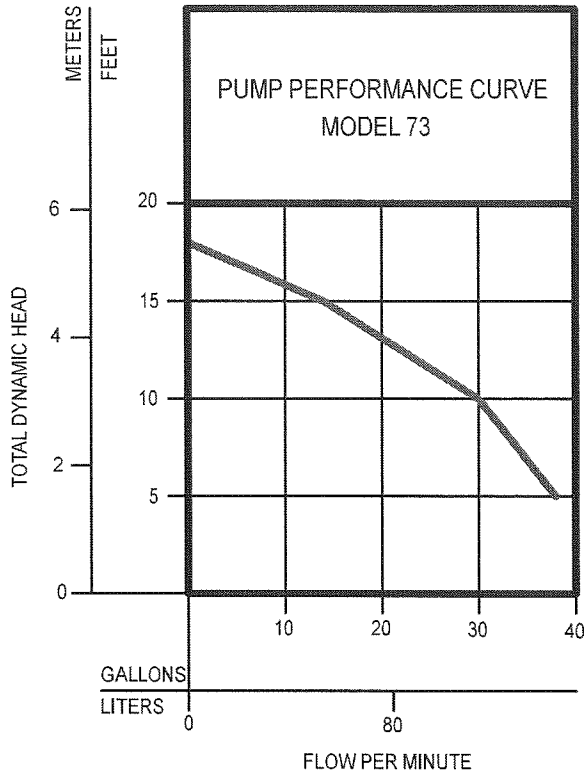

**TOTAL DYNAMIC HEAD/FLOW
PER MINUTE
DEWATERING ONLY**

MODEL		73	
Feet	Meters	Gal.	Liters
5	1.5	38	144
10	3.0	30	114
15	4.6	14	53
Shut-off Head:		18 ft. (5.5 m)	

153077

153077

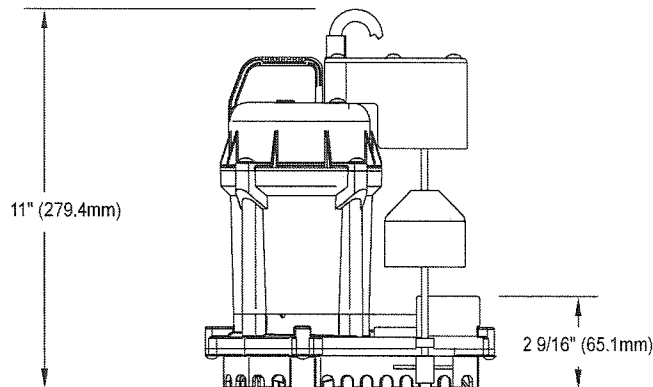
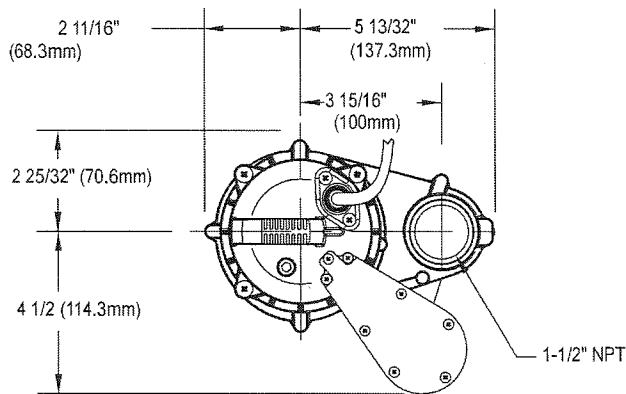

SK3021

**CONSULT FACTORY
FOR SPECIAL APPLICATIONS**

- Alarm and alternator systems available.

"Easy assembly"
(pump & discharge pipe not included.)

OPTIONAL PUMP STAND P/N 10-2421

- Reduces potential clogging by debris.
- Replaces rocks or bricks under the pump.
- Made of durable, noncorrosive ABS.
- Raises pump 2" off bottom of basin.
- Provides the ability to raise intake by adding sections of 1 1/2" or 2" PVC piping.
- Attaches securely to pump.
- Accommodates sump, dewatering and effluent applications.

NOTE: Make sure float is free from obstruction.

For information on additional Zoeller products refer to catalog on Electrical Alternator, FM0486; Mechanical Alternator, FM0495; Sump/Sewage Basins, FM0487; Single Phase Simplex Pump Control/Alarm Systems, FM0732; Residential Alternator System, FM1063.

CAUTION

All installation of controls, protection devices and wiring should be done by a qualified licensed electrician. All electrical and safety codes should be followed including the most recent National Electric Code (NEC) and the Occupational Safety and Health Act (OSHA).