

T&S BRASS AND BRONZE WORKS, INC.

2 Saddleback Cove / P.O. Box 1088
Travelers Rest, SC 29690

Model No.

B-0800

Item No.

Travelers Rest, SC: 800-476-4103 • Simi Valley, CA: 800-423-0150 • Fax: 864-834-3518 • www.tsbrass.com



ADA Compliant

This Space for Architect/Engineer Approval

Job Name _____ Date _____

Model Specified _____ Quantity _____

Customer/Wholesaler _____

Contractor _____

Architect/Engineer _____

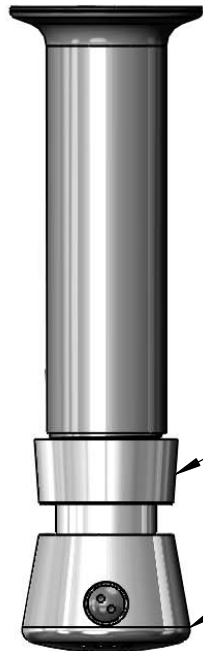

Metering Cartridge
(Requires 3/32" Hex
Key for Adjustment)

Blank Push Button Cap
& Spanner Bit

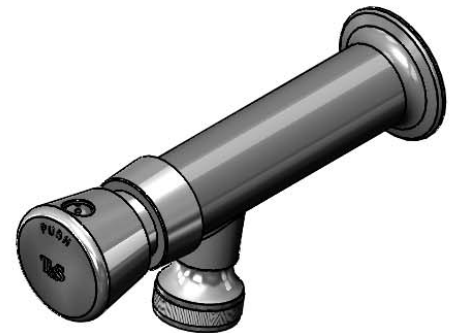

Rose Spray

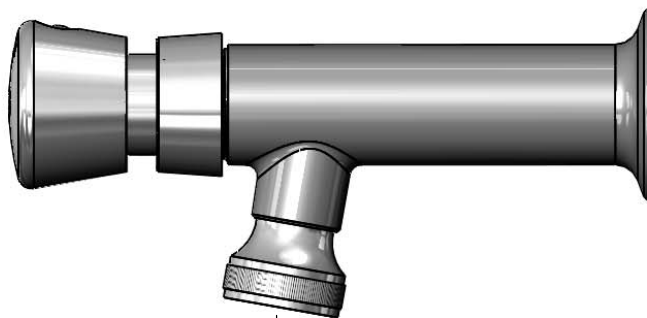

Ø 2" [51mm]
Flange w/
1/2" NPT
Female Inlet

4"
[102mm]

Product Specifications:

Wash Sink Metering Faucet w/ Rosespray, Push Button Metering Cartridge & 1/2" NPT Female Inlet

Product Compliance:

ASME A112.18.1 / CSA B125.1
NSF 61 - Section 9
NSF 372 (Low Lead Content)
ANSI A117.1 (ADA)