

VURSA kd SERIES
SHOWER STALL

Oasis®



MULTI-PIECE MODEL



SH3P-3232 (3-piece)

Rough-In Dimensions

32" wide x 33-1/4" deep x 76-1/4" high (with 4-inch dam)

Finished Dimensions

32" wide x 32" deep x 75" high (with 4-inch dam)

Unit Features



- Three - Piece Fiberglass Composite Construction
- Sanitary Grade Polyester Gelcoat Surface
- Front-Side Installation With Minimal Sealant Requirements
- 3-3/8" Dia. Center Drain
- Anti-Drip Front Dam Ledge
- Back Wall Shelving
- Textured Floor Pattern
- 1/2-inch Balsa Wood Core Floor Structure

Special Notes

- Optional ABF Model (provides 3-inches of drain clearance)
- 'QwikClic' Technology (Patents Pending)
- Factory Applied Reinforcement Packages Available (see following pages)
- SH3P-3232 Provides Less Than 900 sq. Inches Of Floor Area

Order No.:SH3P-3232 (4" dam)

Order No.:SH3P-3232 ABF (6" dam)

32" x 32", 3-piece gelcoated fiberglass shower with 'QuikClic', front side installation, 4" low profile dam (1" drain clearance) upper-level back wall shelves and center drain.

SH3P-3232 ABF (illustrated)

| | Std Unit | ABF Unit |
|---|----------|----------|
| A | 76-1/4" | 78-1/4" |
| B | 75" | 77" |
| C | 4" | 6" |
| D | 1" | 3" |
| E | - | - |
| F | 24" | 26" |

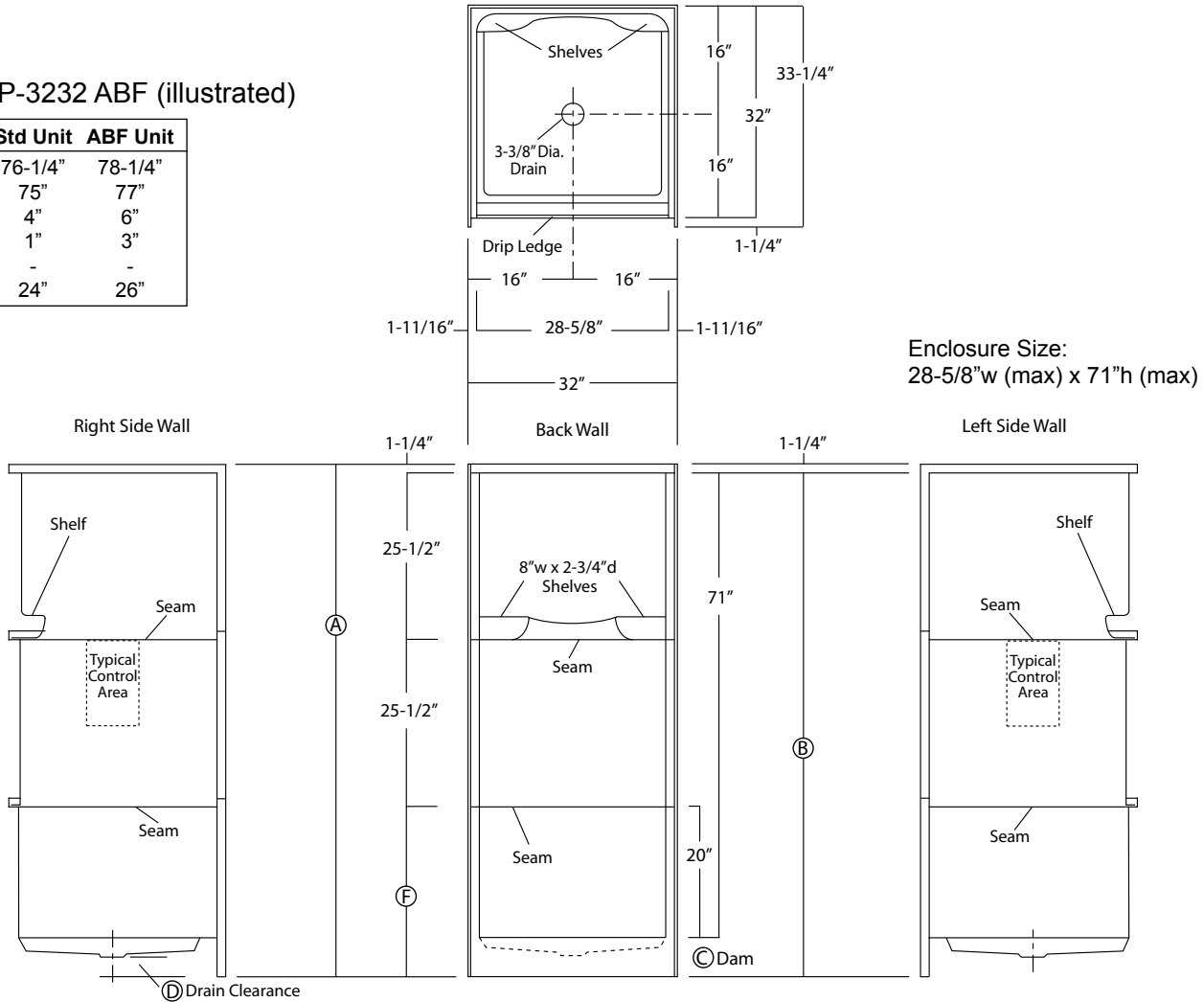

NOTE: This model is non-conforming in size and has less than a 900 square-inch interior area.

Package Order No.: FH (Fair Housing wall reinforcement)

Package Includes: Factory applied, HUD-FHA compliant (Fair Housing), structurally reinforced wall areas (as shown).

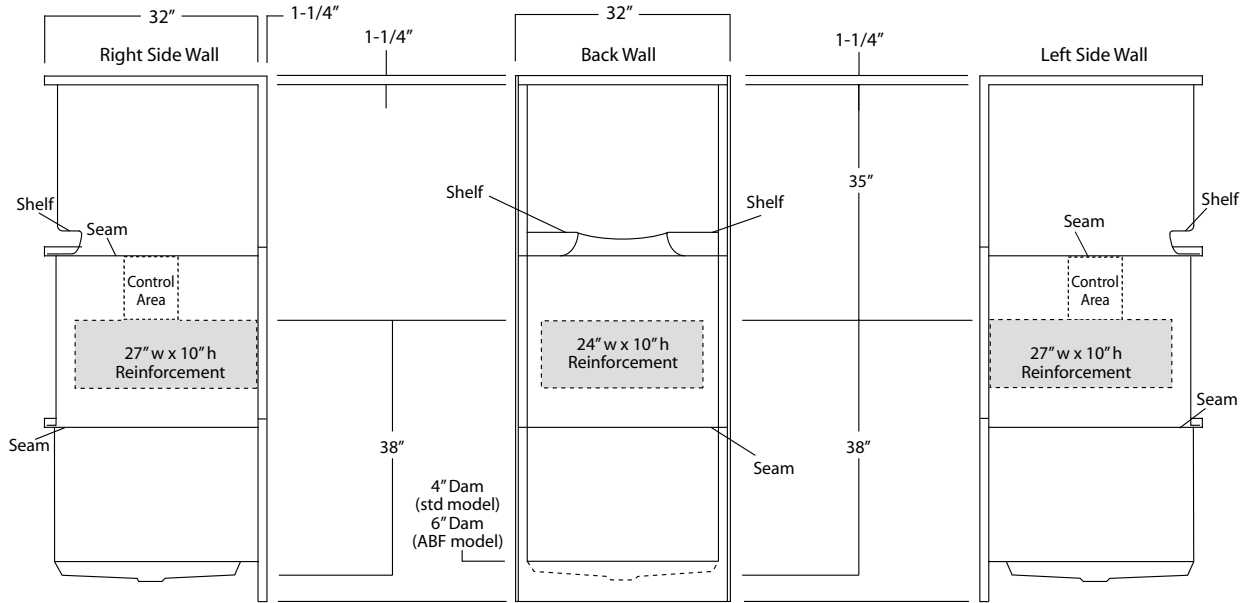

Package Order No.: 3SM (3-side, mid-level wall reinforcement)

Package Includes: Factory applied, 3-side, mid-level, structurally reinforced wall areas (as shown), exceeding 'Fair Housing' (HUD/FHA) requirements.

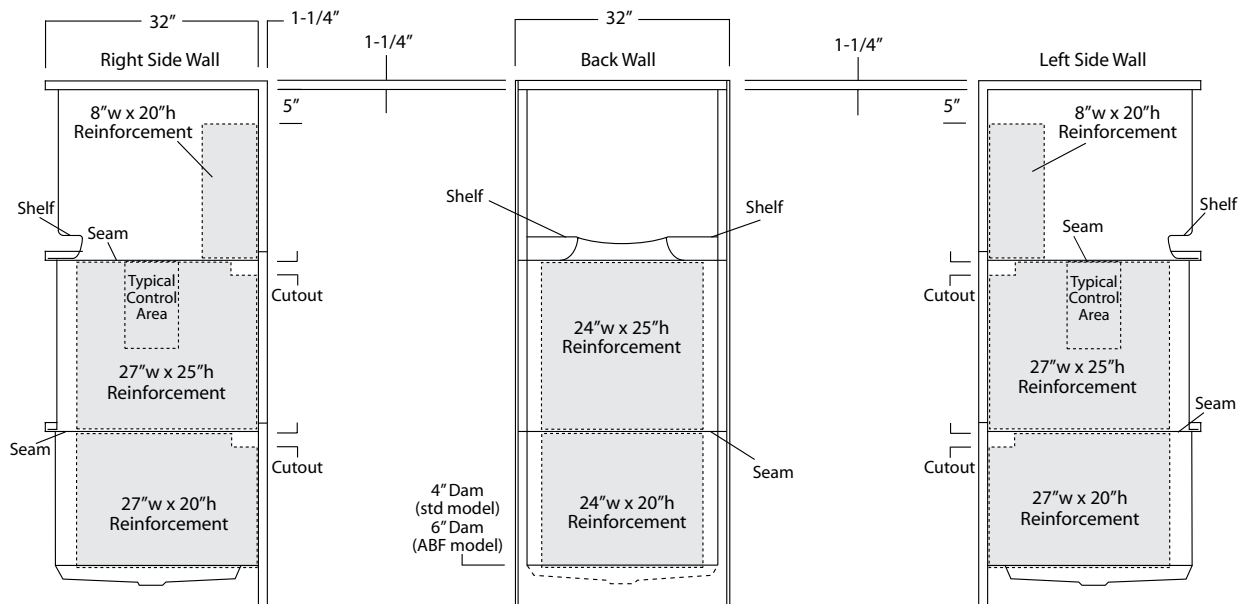

Package Order No.: 3SF (3-side, full-wall reinforcement)

Package Includes: Factory applied, 3-side, full-wrap, structurally reinforced wall areas (as shown), exceeding 'Fair Housing' (HUD/FHA) requirements.

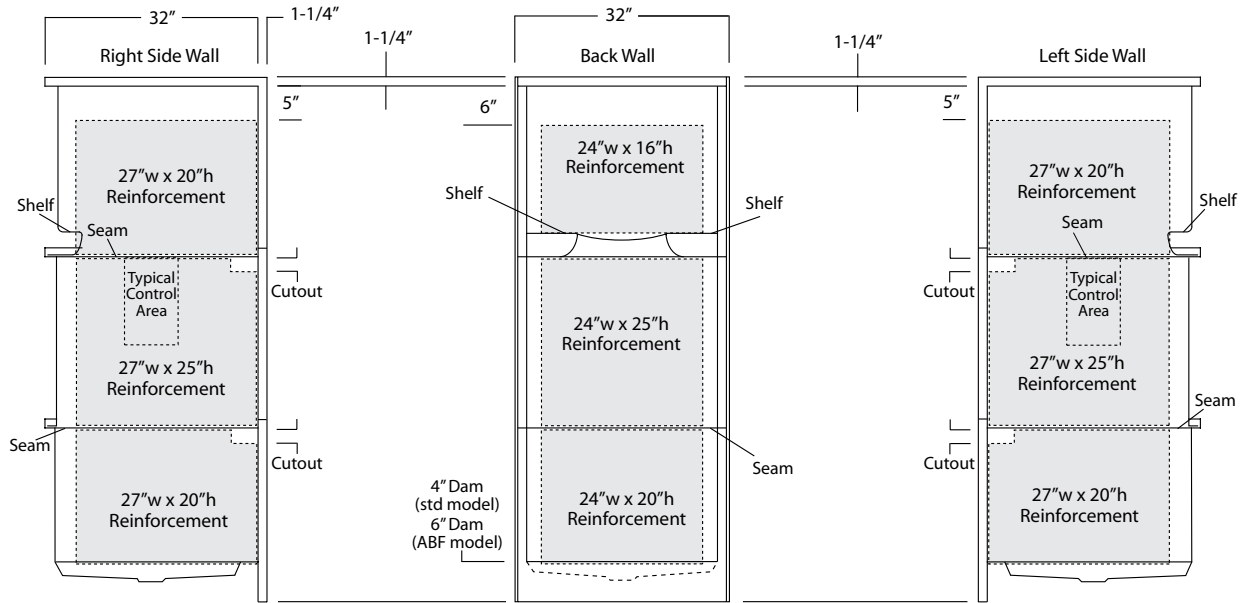

Photographic images may include optional components and appear different than actual product.
 Dimensions shown are maximum. Due to the nature of the materials involved, actual unit dimensions can vary (tolerances: +0 / -3/8 inch).
 Oasis reserves the right to modify or discontinue product and/or associated equipment without prior written or verbal notification or obligation.