

MAAX SUBMITTAL SPECIFICATIONS

CS P6

MODEL NUMBER 103566

DIMENSIONS: 72" x 42" x 20" Acrylic



Project :
Contractor :
MAAX Representative : Tel :
Date :

Vivez l'expérience
MAAX[®]
Enjoy the experience

STANDARD FEATURES

- Styled for lasting, timeless appeal. Available in tub only and an array of True Whirlpool Systems, Aeroeffect Air Systems and Combination True Whirlpool and Aeroeffect Air Systems. Options include cable-operated waste and overflow, in-line heater, chromatherapy and pillow. Drop-in or undermount installation.

OPTIONS

- None

UNIQUE FEATURES

- None

SYSTEMS

- None

DOOR SELECTION

Combine with MAAX's complete shower door offering visit www.maax.com

CERTIFICATIONS

Maax products adhere to one or more of the following certifications:



www.maax.com

2014-03-24

MAAX SUBMITTAL SPECIFICATIONS

CS P6

MODEL NUMBER 103566

TECHNICAL DRAWINGS

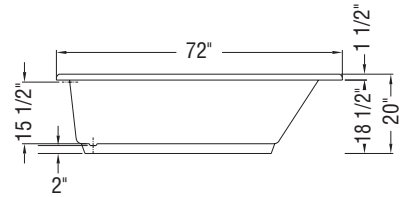
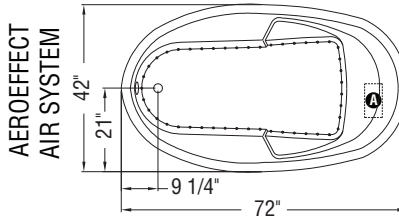
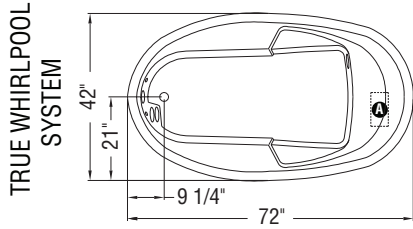

- (A) : Indicates pump or blower positioning
- (O) : Indicates True Whirlpool jets positioning
- (•) : Indicates Aeroeffect airjet positioning