



## Z6912

### AquaSense Battery Powered Faucet



Shown with -CP4 option

### Flow Control Options

- ☐ -F 0.5 gpm/1.9 Lpm Vandal-Resistant Non-Aerated
- ☐ -J 1.5 gpm/5.7 Lpm Vandal-Resistant Laminar Flow
- ☐ -K 1.0 gpm/3.8 Lpm Vandal-Resistant Laminar Flow
- ☐ -L 1.0 gpm/3.8 Lpm Vandal-Resistant Aerator
- ☐ -M 0.35 gpm/1.3 Lpm Vandal-Resistant Non-Aerated

### Power Supply Choices (Sold Separately)

- ☐ -ACA 6 VDC Plug-In Power Converter
- ☐ -HW6 Hardwired Power Converter

### Optional Power Supply Accessories

- ☐ -CWB Connector Wire for Hardwire Install
- ☐ -MJ Mini Junction Box

**NOTE: For Hardwire applications furnish P6000-HW6 power converter. Order P6000-HW6 power converter separately.**

**The P6000-HW6 and P6000-MJ will power up to 8 sensor faucets.**

ZURN INDUSTRIES, LLC. ♦ COMMERCIAL BRASS OPERATION  
5900 ELWIN BUCHANAN DRIVE ♦ SANFORD NC 27330  
Phone: 1-800-997-3876 ♦ Fax: 919-775-3541  
www.zurn.com

In Canada: ZURN INDUSTRIES LIMITED  
3544 Nashua Drive ♦ Mississauga, Ontario L4V1L2  
Phone: 905-405-8272 Fax: 905-405-1292

AquaSense® is a registered trademark of Zurn Industries, LLC.

### Engineering Specification

ADA compliant, battery powered, chrome plated sensor faucet for retrofit and new construction.

- Flow Rate  
1.5 gpm Vandal Resistant Aerator
- Occupant Detection  
Infrared convergence-type proximity sensor  
Thirty Second Time out feature
- Spout module  
Chrome Plated Cast Brass
- Also Includes  
In-line filter  
4 "AA" batteries  
Inlet for a 1/2"[13] ball riser  
Single supply hose

### Accessories

- ☐ -ADM Above Deck Mixer
- ☐ -ADM-1 Above Deck Mixer w/4" Cover Plate
- ☐ -ADM-2 Above Deck Mixer w/8" Cover Plate
- ☐ -CG CareGuard Aerator
- ☐ -CP4 Cover Plate 4"[102] Centers
- ☐ -CP8 Cover Plate 8"[203] Centers
- ☐ -DSA Drug Screening Applications
- ☐ -H4 Wrist Blade Handle for ADM
- ☐ -MT Mixing Tee
- ☐ -MV Temperature Mixing Valve
- ☐ -SH Supply Hoses for Mixing Valve
- ☐ -TMV Thermostatic Mixing Valve for Multiple Faucets
- ☐ -TMV-1 Thermostatic Mixing Valve for Single Faucets
- ☐ -\_\_\_\_\_ Other

Careguard currently only available with -E, 1.5 Vandal Resistant Laminar Aerator.

Architectural/Engineering Approval

The information contained in this document is subject to change without notice.  
Please contact Zurn for most up to date information.

# TYPICAL Z6912 AquaSense Battery Powered Faucet

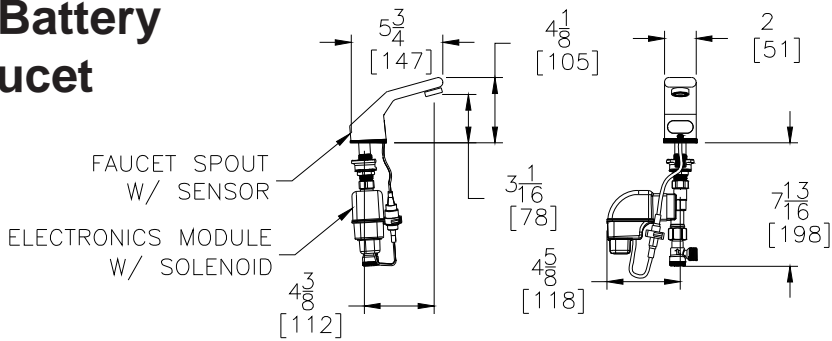

# TYPICAL Z6912-ACA AquaSense Plug-In Powered Faucet

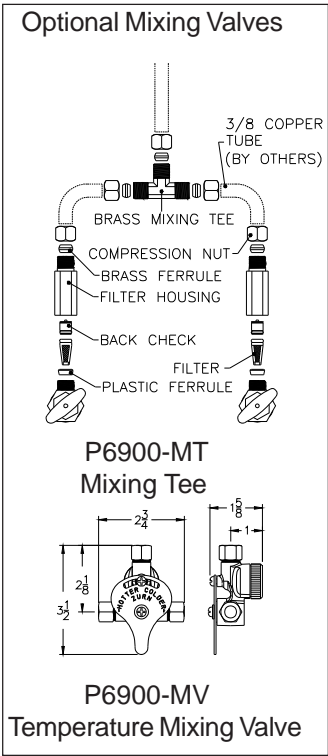
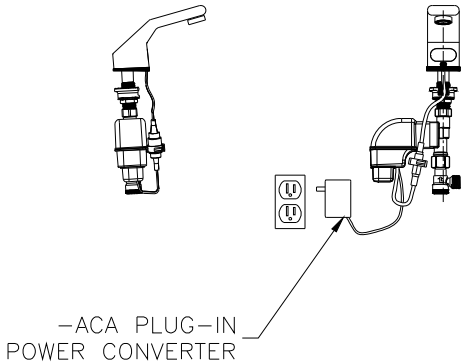

# TYPICAL Z6912-CWB AquaSense Hardwire Powered Faucet

Optional:  
\* Optional -MJ mini junction box for connecting up to 8 faucets

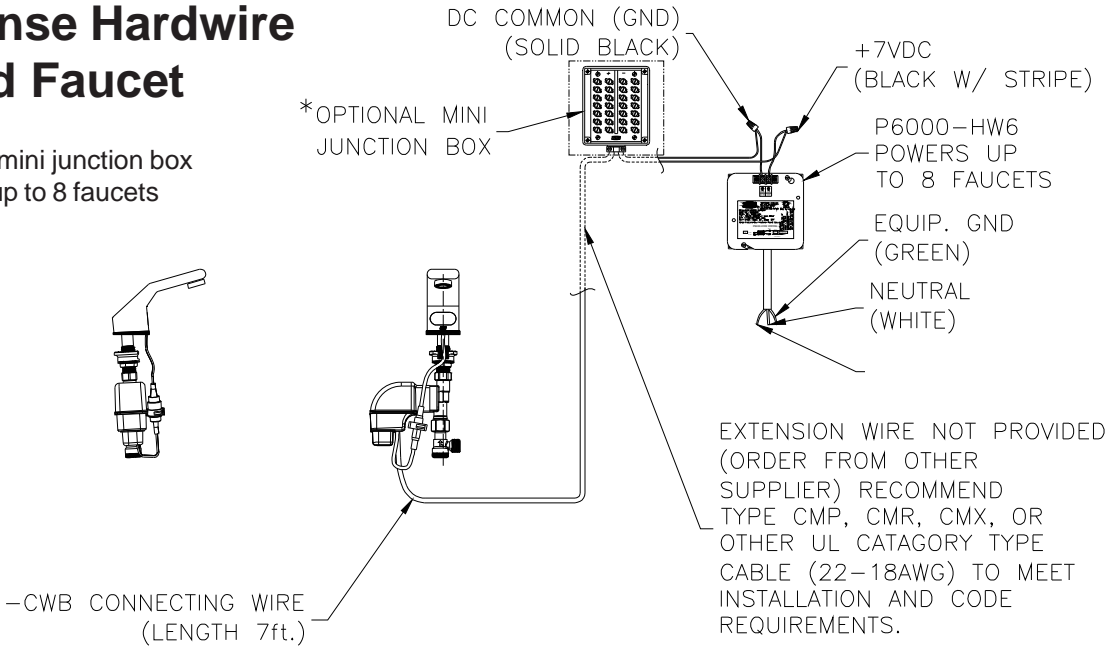

**NOTE: MUST USE EITHER ZURN P6000-HW6 HARDWIRE POWER CONVERTER OR ZURN P6000-PC6 PLUG-IN POWER CONVERTER TO ENSURE PROPER OPERATION. USING A POWER CONVERTER OTHER THAN ZURN MAY RESULT IN OPERATION MALFUNCTION OR UNIT FAILURE.**