



Z541

12 [305] DIAMETER HEAVY-DUTY DRAIN

SPECIFICATION SHEET

TAG _____

Dimensional Data (inches and [mm]) are Subject to Manufacturing Tolerances and Change Without Notice

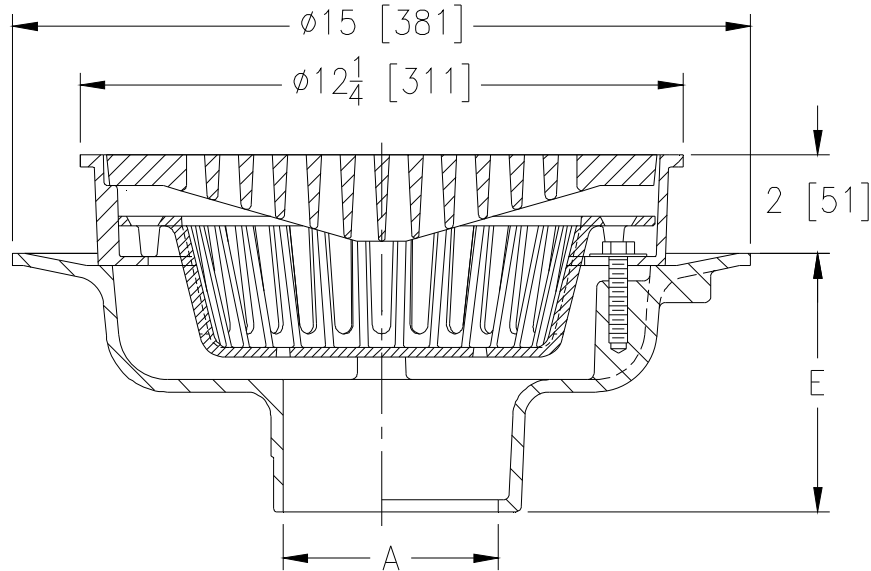

A- Pipe Size In.	Approx. Wt. Lbs. [kg]	Grate Open Area Sq. In. [cm ²]
2-3-4 [51-76-102]	51 [19]	30 [194]
5-6 [127-152]	52 [19]	
8-10 [203-254]	53 [20]	

ENGINEERING SPECIFICATION: ZURN Z541

12 [305] Diameter top drain. Dura-Coated cast iron body with bottom outlet, seepage pan and combination membrane flashing clamp and frame for anti-tilt heavy-duty slotted grate with suspended polypropylene sediment bucket.

OPTIONS (Check/specify appropriate options)

PIPE SIZE

- 2 thru 6, 8, 10 [51 thru 152, 203, 254]
- 2 thru 4, 6 [51 thru 102, 152]
- 2 thru 6, 8, 10 [51 thru 152, 203, 254]
- 2 thru 6, 8, 10 [51 thru 152, 203, 254]
- 2 thru 4 [51 thru 102]

(Specify size/type) **OUTLET**

- ___ IC Inside Caulk
- ___ IG Inside Gasket
- ___ IP Threaded
- ___ NH No-Hub
- ___ NL Neo-Loc

'E' BODY HT. DIM.

- 5-1/4 [133]
- 5-1/4 [133]
- 3-3/4 [95]
- 5-1/4 [133]
- 4-5/8 [117]

PREFIXES

- ___ Z D.C.C.I. Body and Top*
- ___ ZB D.C.C.I. Body with Polished Bronze Top (Add 3/16 [5] to 2 [51] Dim and 3/4[19] to 12-1/4[311] Dim.)
- ___ ZN D.C.C.I. Body with Polished Nickel Bronze Top (Add 3/16 [5] to 2 [51] Dim and 3/4[19] to 12-1/4[311] Dim.)

SUFFIXES

- | | |
|---|--|
| <ul style="list-style-type: none"> ___ -AR Acid Resisting Epoxy Coated Cast Iron ___ -D Dome Grate (D.C.C.I. only) ___ -DG Duresist Grate ___ -DX Dex-o-tex Flange ___ -G Galvanized Cast Iron ___ -H Hinged Grate ___ -HP Heel-Proof Grate ___ -LY (Less) Sediment Bucket ___ -P Trap Primer Connection ___ -PH Packing House Grate ___ -S Secondary Strainer ___ -SA Stabilizer Assembly (See Z1036) ___ -SS Stainless Mesh Liner for Bucket | <ul style="list-style-type: none"> ___ -TC Neo-Loc Test Cap Gasket (2 [51] - 4 [102] NL Bottom Outlet Only) ___ -TG Tractor Grate ___ -TS Top Secured with Slotted Screws ___ -V Backwater Valve (See Z1099) ___ -VP Vandal-Proof Secured Top ___ -WS Wide Slotted Grate (50 sq. in open) ___ -YC Cast Iron Sediment Bucket ___ -90 90° Threaded Side Outlet Body (2 thru 6 [51 thru 152]) |
|---|--|

*REGULARLY FURNISHED UNLESS OTHERWISE SPECIFIED

REV. G	DATE: 12/17/10	C.N. NO. 110162
DWG. NO. 58944		PRODUCT NO. Z541