



Z325

INDIRECT WASTE FUNNEL WITH INTEGRAL BACKWATER VALVE

SPECIFICATION SHEET

TAG _____

Dimensional Data (inches and [mm]) are Subject to Manufacturing Tolerances and Change Without Notice

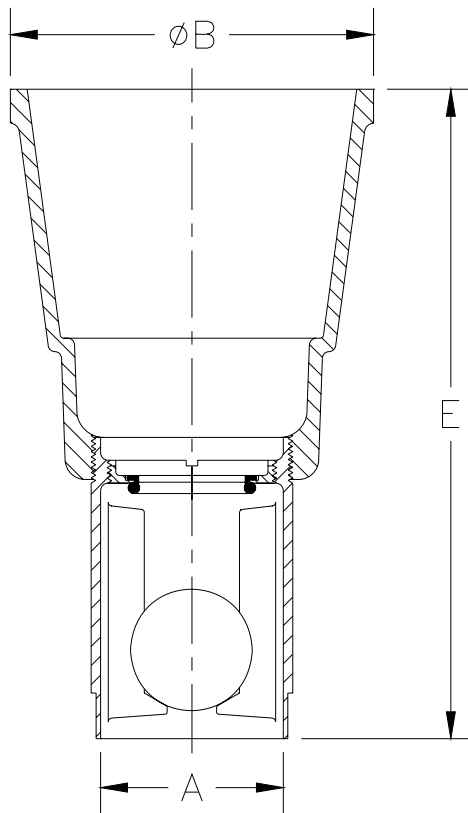

A-Pipe Size Inches	B	Approx. Wt. Lbs. [kg]
2 [51]	6-3/4 [171]	13 [6]
3 [76]		16 [7]
4 [102]	8-5/8 [219]	20 [9]
6 [152]		37 [17]

ENGINEERING SPECIFICATION: ZURN Z325
7 [178] or 9 [229] Diameter Indirect Waste funnel with Dura-coated cast iron body, plastic ball float, bronze backwater valve bushing and a replaceable neoprene seat.

OPTIONS (Check/specify appropriate options)

PIPE SIZE

2-3 [51-76]
4-6 [102-152]

(Specify size) **OUTLET**

____ NH No-Hub
____ NH No-Hub

'E' BODY HT. DIM.

12-3/4 [324]
15-1/4 [387]

PREFIXES

____ Z D.C.C.I. Body*

SUFFIXES

____ -DB Bottom Dome Strainer
____ -G Galvanized Cast Iron
____ -S Secondary Strainer

REV. D	DATE: 11/08/10	C.N. NO. 120318
DWG. NO. 59232	PRODUCT NO. Z325	

*REGULARLY FURNISHED UNLESS OTHERWISE SPECIFIED