

Vittra



EverGreen

PRESERVING WATER AND PERFORMANCE



We hold dear the things that are important to us. Let water be one of them.



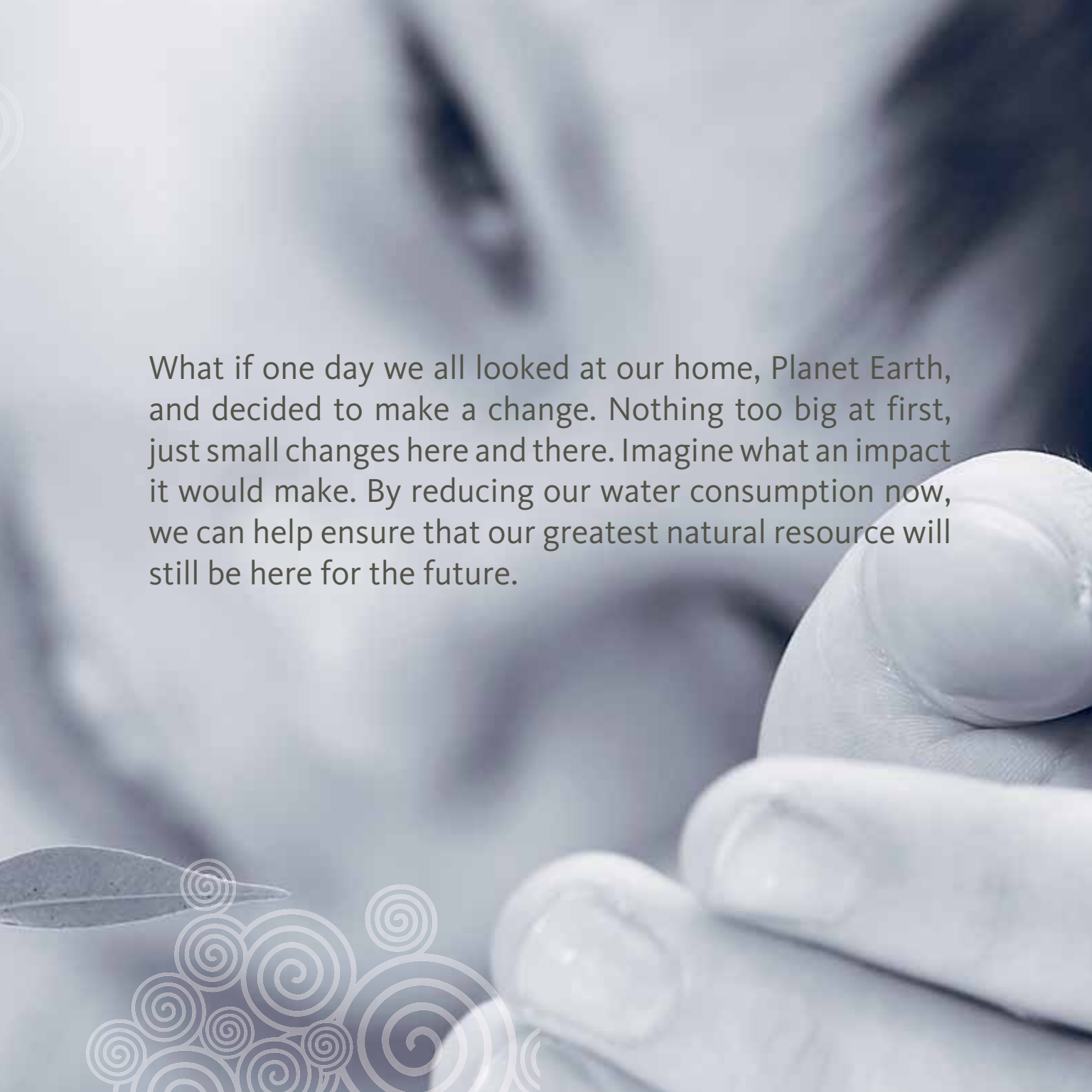

What if one day we all looked at our home, Planet Earth, and decided to make a change. Nothing too big at first, just small changes here and there. Imagine what an impact it would make. By reducing our water consumption now, we can help ensure that our greatest natural resource will still be here for the future.





Traditional toilets use up to 19 gallons of water each day (per person, or 95 gallons for a family of five)—by far the largest consumer of water in the home according to the American EverGreen Foundation. By switching to a water-conserving, High-Efficiency Toilet (HET), those gallons of water can be reduced to some 12 gallons a day.

At Vitra, we believe that creating well-designed and superbly-engineered bathroom products doesn't have to come at the cost of the environment. For the past 60 years, we have dedicated ourselves to making the world's highest performing toilets while keeping intact our rigorous standards for water efficiency. In fact, Vitra was the first manufacturer to partner with the EPA's WaterSense Program to protect the future of our nation's water supply by promoting and enhancing the market for water-efficient products and services. The Vitra EverGreen line of high efficiency toilets and urinals meets and exceeds water conservation standards set out by the EPA's WaterSense Program.

Whether you are specifying products to earn LEED water-efficiency points or meeting the demands of an environmentally-conscious homeowner, our EverGreen line offers you flexible options that will perform perfectly every time.



1.2 GPF
GRAVITY HET



0.8-1.6 GPF
DUAL FLUSH HET

Making the best bathroom products isn't enough. We want to be a part of the change that will make a world of difference, today and in the future.



1.0 GPF
PRESSURE ASSIST HET



URINAL 0.25
GPF HEU

EverGreen 1.2 HET

VitrA's newest addition, the 1.2 GPF Gravity Flush HET saves 25% more water annually compared to the industry standard 1.6 GPF toilets.

FEATURES AND BENEFITS:

- First of its kind – VitrA's HET uses just 1.2 GPF, which brings an additional 7% savings on the flush volume compared to other gravity flush HETs
- Available in elongated and round front extended height bowls
- Operates in a quiet environment due to silent gravity flush
- Available in 10", 12" and 14" rough dimensions
- ASME, CSA, and LADWP approved
- Meets ADA requirements
- Excellent performance results on Map Testing (Maximum Performance Testing) up to 800 grams solid discharge
- Large and clean footprint offers remodeling convenience
- Fully glazed trapway



VitrA's 1.2 GPF HET can save a family of five 20,000 gallons of water annually over standard 1.6 GPF models.

1.2 GPF Gravity Flush high efficiency toilet (HET)



Shown in
Dual Flush Elongated

Dual Flush

VitrA's EverGreen Dual Flush toilets give you two powerful options: a 0.8 or 1.6 GPF, depending on the necessary amount needed for flushing.

FEATURES AND BENEFITS:

- Flexibility: choice of using either 0.8 for liquid or 1.6 GPF for solid discharge
- Achieves discharge in 3.5 seconds, refills in about 25 seconds
- Operates between 10-80 psi
- Available in elongated extended height or round front bowls
- ASME, CSA and LADWP approved
- Meets ADA requirements (Elongated only)
- Easy to clean concealed trapway
- Fully glazed trapway
- Large & clean footprint offers remodeling convenience



VitrA's Dual Flush system saves up to 2,500 to 15,000 gallons of water annually. Compared to older 3.0 GPF systems, our Dual Flush conserves 67% more water.



0.8 - 1.6 GPF DUAL FLUSH high efficiency toilet (HET)



Shown in
Dual Flush Elongated

1.0 GPF PRESSURE ASSIST high efficiency toilet (HET)



PRESSURE ASSIST

The 1.0 GPF Pressure Assist system uses a specialized flushing mechanism that provides added force to water used during flushing to significantly increase the performance of traditional siphonic discharge. This added pressure enhances the discharge and bowl cleaning functions without increasing the GPF.

FEATURES AND BENEFITS:

- A pioneering low flush toilet – 1.0 GPF
- Available elongated, extended height model
- ASME, CSA and LADWP approved
- Meets ADA requirements
- Fully glazed trapway



If all U.S. households installed water-efficient appliances, the country would save more than 3 trillion gallons of water and more than \$17 billion dollars per year.

0.25 GPF HIGH EFFICIENCY



URINAL

VitrA's new 0.25 GPF High Efficiency Urinal is perfect for commercial and residential use.

The water conserving urinal is uniquely designed to save 75% more water than a typical urinal.

FEATURES AND BENEFITS:

- ASME and CSA Approved
- Meets ADA requirements
- Offers efficient cleaning & waste removal



75% of the earth's surface consists of water, but only 1% is actually usable. The rest is stored under glaciers and ice caps. So please, use water wisely.

The background of the entire page is a soft-focus, black and white photograph of numerous soap bubbles floating in the air. The bubbles vary in size and are scattered across the frame, creating a clean and airy atmosphere. The lighting is diffused, highlighting the spherical shapes and the way light reflects off their surfaces.

VitrA hygiene VitrA clean

It's a very clean world with VitrA. Water environments are magnets for bacteria and dirt ... Luckily you have VitrAhygiene and VitrAclean on your side.

VitrAhygiene is a superior glazing technology available exclusively on all VitrA's ceramics. This durable defense mechanism fights against germs by adding silver ions to the raw glaze, offering 99.9% resistance to bacteria treated on ceramic surfaces. VitrAhygiene's anti-bacterial resistance is effective for the lifetime of the product.

Say goodbye to pesky lime scale build-up and other staining with our unique VitrAclean technology. VitrAclean is a special double glazing process that increases surface tension on the product so that dirt is washed away along with water. Our VitrAclean glaze eliminates the need for harsh cleaning materials, and keeps your VitrA products stain-free for years to come.





BE AWARE OF HOW MUCH WATER YOU USE!

The average person uses fifty gallons of water per day on the following activities:

Toilet - 19 gallons per day
Bathing and hygiene - 15 gallons per day
Laundry - 8 gallons per day
Kitchen - 7 gallons per day
Housekeeping - 1 gallon per day

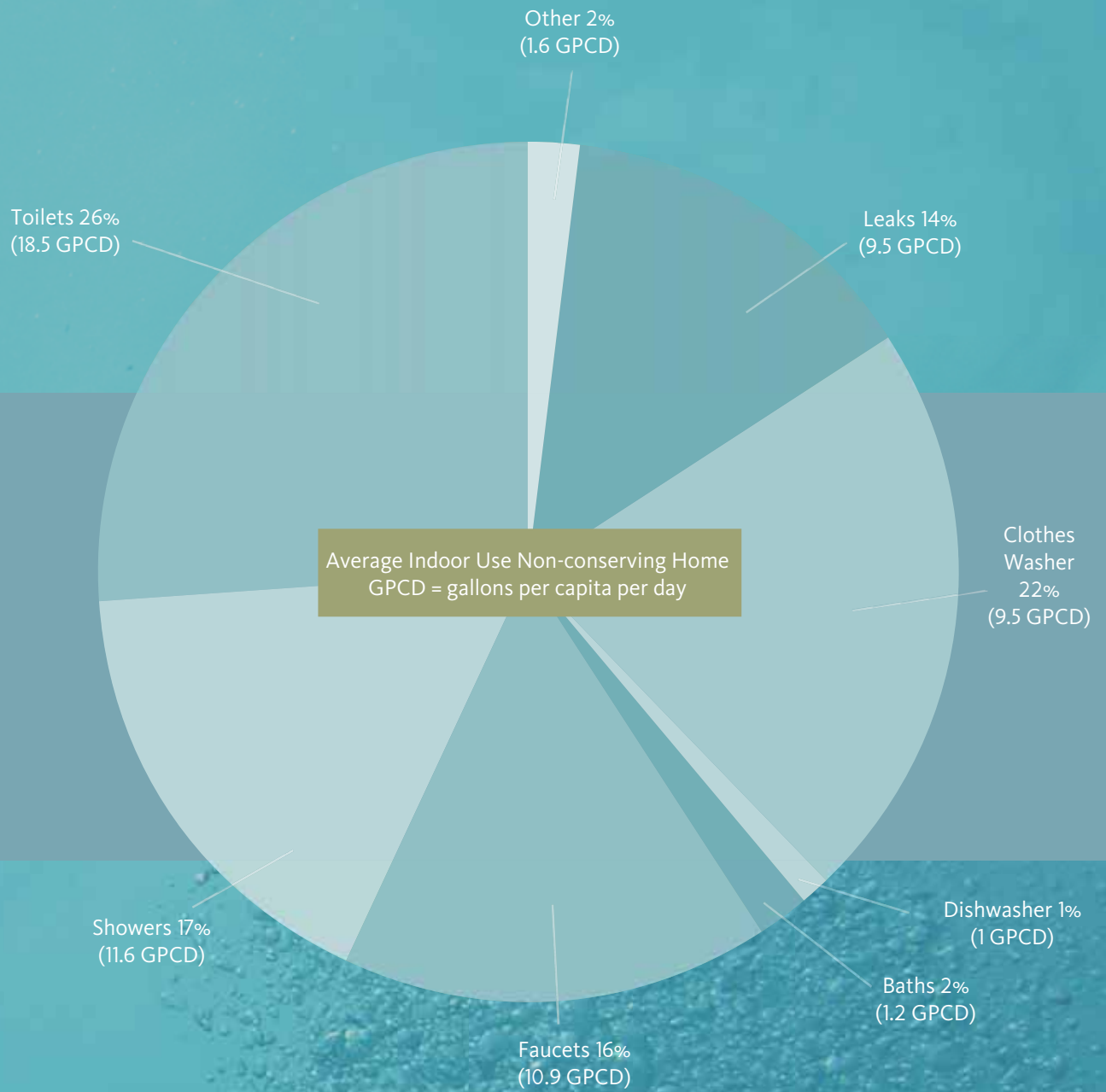

Source: Handbook of Water Use and Conservation

1.2 GPF HET elongated



5195-XXX-0075 bowl
 5402-XXX-5250 tank w/chrome lever (12")
 5402-XXX-5249 tank w/white lever (12")
 5400-XXX-5250 tank w/chrome lever (10")
 5400-XXX-5249 tank w/white lever (10")
 5404-XXX-5250 tank w/chrome lever (14")
 5404-XXX-5249 tank w/white lever (14")

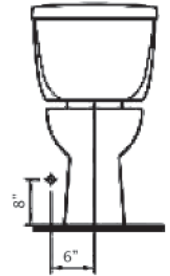
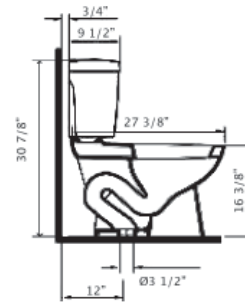
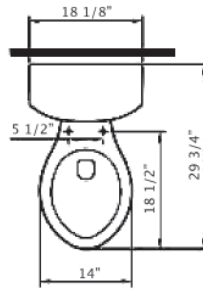

1.2 GPF HET round



5196-XXX-0075 bowl
 5402-XXX-5250 tank w/chrome lever (12")
 5402-XXX-5249 tank w/white lever (12")
 5400-XXX-5250 tank w/chrome lever (10")
 5400-XXX-5249 tank w/white lever (10")
 5404-XXX-5250 tank w/chrome lever (14")
 5404-XXX-5249 tank w/white lever (14")

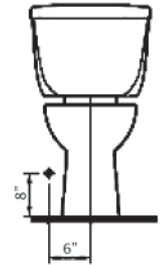
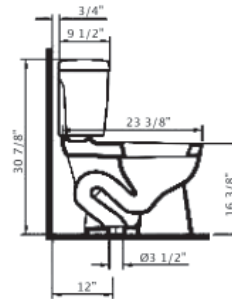
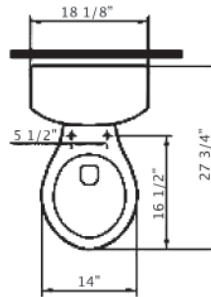

DUAL FLUSH round front



5076-XXX-0075 bowl
 5055-XXX-5137 tank
 0.8 GPF / 1.6 GPF

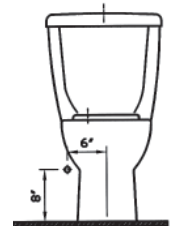
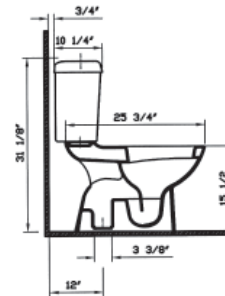
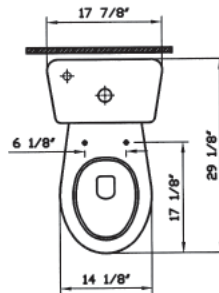



DUAL FLUSH elongated

5074-XXX-0075 bowl
5055-XXX-5137 tank

0.8 GPF / 1.6 GPF

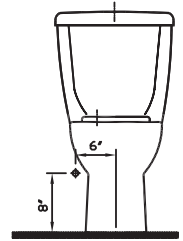
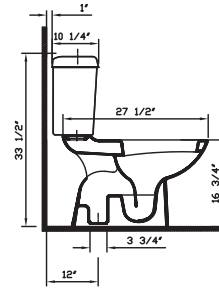
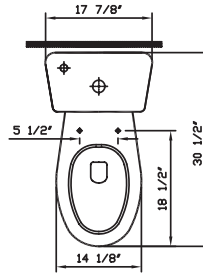

PRESSURE ASSIST

5065-XXX-0101
elongated bowl

5066-XXX-5280 tank
w/chrome plated lever on left

5066-XXX-5281 tank
w/chrome plated lever on right

1.0 GPF

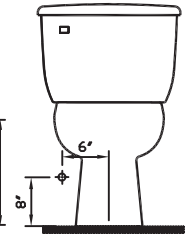
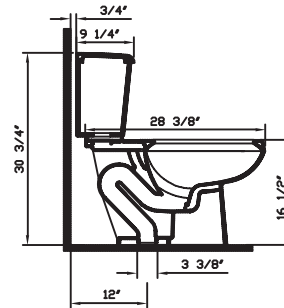
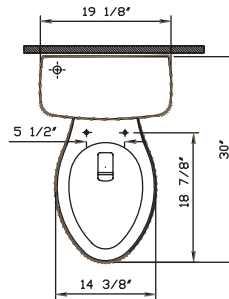

0.25 GPF URINAL

5231-XXX-0198 urinal top spud
5231-XXX-0199 urinal rear spud

Low consumption,
wash out urinal
0.25 GPF

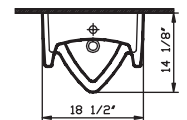
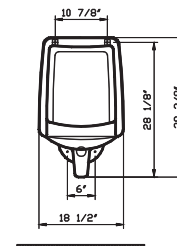
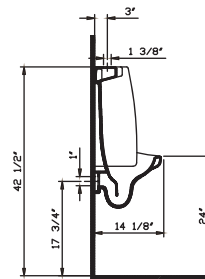

As a manufacturer we are delighted to be in the unique position of offering today's consumers a range of products that offer not only aesthetic options and reliable performance but that also serve to help protect the environment as well. In an era of increasing global awareness of how our daily lives can cause lasting long-term effects on our environment, Vitra recognizes the importance of doing everything possible to protect our earth's natural resources. The growing need for clean water in so many parts of our world, and the shortages that are looming on the horizon for so much of the USA, has impressed upon us the urgency of being proactive in the fight to protect the environment. With the development of new technologies that use less water, but that still maintain or exceed the current performance levels in existing models, we can present today's consumers with a product that they can feel good about on a socially conscious level and still be confident it will perform to the highest standards.



VitrA has a long-standing commitment to producing products that promote healthy-based living and doing whatever possible to help serve the Global Community through an absolute commitment to Corporate Citizenship and VitrA is proud to add their water conservation products into this category. We are committed as a company to continuing the development of even more products that serve to protect our natural resources and will strive to be a leader in the future development of water conscious products.

ABOUT VitrA

A leading global brand of contemporary bathroom products for home and commercial use, VitrA is proud to be the first manufacturer to partner with WaterSense in 2007. VitrA draws upon its 60-plus years of global presence in over 75 countries.

Since 1998, VitrA is an ISO 14001-certified manufacturer with its environmental management system.



VitrA

VitrA

VitrA USA
305 Shawnee North Drive, Suite 600
Suwanee, GA 30024
Telephone: (770) 904-6830
Fax: (770) 904-6891
TOLL FREE 1-877-65-VITRA
www.vitra-usa.com