





Counter Lavatories

Product	Product Code	Description	White Color USD	Cubes (cu.ft.)	Approx Weight (lbs)
 	6069BXXX-0012	21" x 16" Undercounter lavatory (without faucet hole) ADA Compliant	105	2.2	21
 	6039BXXX-0012	16" x 13" Undercounter lavatory (without faucet hole) ADA Compliant	91	2.0	12
	6130BXXX-0001	22 5/8" x 18 7/8" Semicounter lavatory (Single-hole faucet drilling)	170	2.3	31
	6130BXXX-0030	22 5/8" x 18 7/8" Semicounter lavatory (4" faucet drilling)	170	2.3	31
	6130BXXX-0033	22 5/8" x 18 7/8" Semicounter lavatory (8" faucet drilling)	170	2.3	31

- 10 year warranty is offered only for plumbing fixtures. • 2 year warranty is offered for the toilet seats and bathroom furniture.
- "XXX" indicates the color. The color surcharge is an additional 20 % for basic colors of the product's price.
For basic and special colors offered for each suite, refer to page no. 62
- VitrAclean glazing surcharge is \$79 per product. VitrAhygiene glazing surcharge is \$79 per product.

Technical Drawing

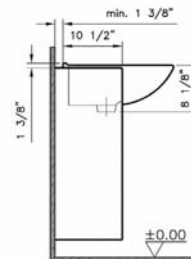
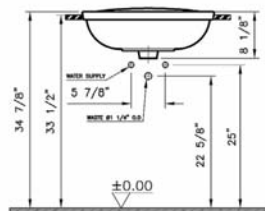
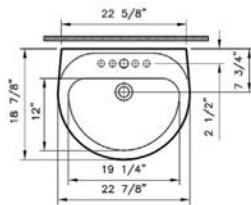
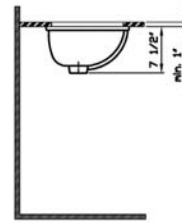
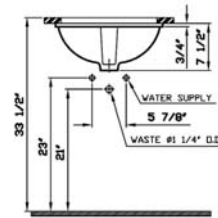
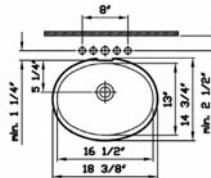
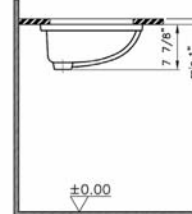
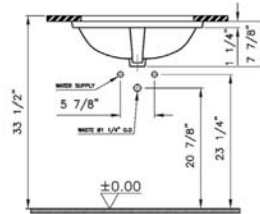
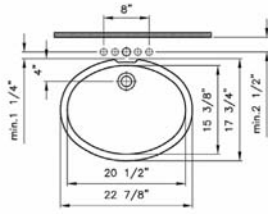

Colors

VitrA

Plumbing Fixtures



	003 White	017 Bone*	068 Biscuit**
Corina	●	●	●
EverGreen	●	●	●
Atlantis	●	●	●

- The color surcharge is an additional 20% for basic colors of the product's price.
- Basic colors : 017 Bone, 068 Biscuit
- The first zero of the color codes should be replaced for ordering VitrAclean and/or VitrAhygiene.
- VitrAclean : 4xx
- VitrAhygiene : 6xx
- VitrAclean & VitrAhygiene: 7xx

* New orders from the factory require a minimum order quantity of 10 pcs per product.

** New orders from the factory require a minimum order quantity of 5 pcs per product.