

LOCKTAB® FEATURE FOR TYPE "B" RV GAS VENT

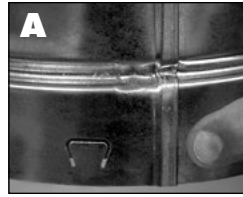

To use the
LockTab® feature:

Our non-positional lock system on the Selkirk® RV Gas Vent is the best lock system on the market today. The incorporation of the LockTab® feature simply improves our lock system by adding flexibility and meeting market needs.



The Locktab is located on the female end of the gas vent.

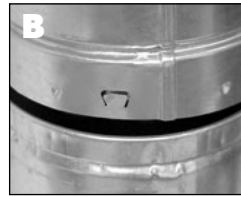

Assemble the gas vent sections

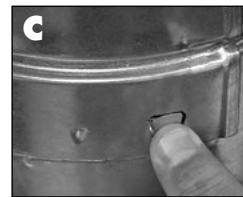

The Locktab is then depressed with a thumb or blunt object such as a screwdriver into the lock channel of the male end

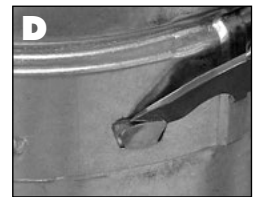

To disengage the Locktab, pry it up by using a screwdriver or knifeblade

RV 3" THROUGH 8"

The RV line of Selkirk round vent pipe and fittings is designed for use on approved gas appliances in residential and light commercial and industrial applications. Round vents for large appliances will be found in the QC section which follows.

NOTE: Size refers to the inside diameter of the pipe or fitting. The outside diameter of RV is approximately 1/2" larger. Outer material is 28 GA galvanized steel. Inner liner is aluminum.

LOCKTAB – You no longer have to use sheet metal screws to secure pipe connections if local codes require you to. Just press the "LockTab" and you are done.

VENT PIPE

ROUND PIPE

- Available in 6 sizes
- Easy to assemble and can be combined to obtain the required installation height
- Sectional overlap of 1.5". Hence, net assembled length is 1.5" less than listed lengths

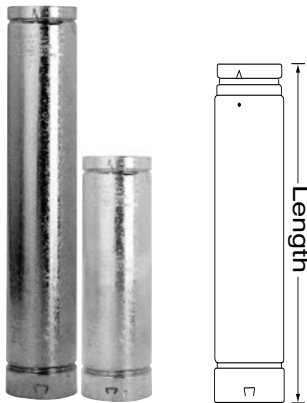

Size	Product No.	Part No.	Lengths
3"	103060	3RV-5	Pipe - 5'
	103048	3RV-4	Pipe - 4'
	103036	3RV-3	Pipe - 3'
	103024	3RV-2	Pipe - 2'
	103018	3RV-18	Pipe - 18"
	103012	3RV-12	Pipe - 12"
4"	103006	3RV-6	Pipe - 6"
	104060	4RV-5	Pipe - 5'
	104048	4RV-4	Pipe - 4'
	104036	4RV-3	Pipe - 3'
	104024	4RV-2	Pipe - 2'
	104018	4RV-18	Pipe - 18"
	104012	4RV-12	Pipe - 12"
	104006	4RV-6	Pipe - 6"

Size	Product No.	Part No.	Lengths
5"	105060	5RV-5	Pipe - 5'
	105048	5RV-4	Pipe - 4'
	105036	5RV-3	Pipe - 3'
	105024	5RV-2	Pipe - 2'
	105018	5RV-18	Pipe - 18"
	105012	5RV-12	Pipe - 12"
	105006	5RV-6	Pipe - 6"

Size	Product No.	Part No.	Lengths
6"	106060	6RV-5	Pipe - 5'
	106048	6RV-4	Pipe - 4'
	106036	6RV-3	Pipe - 3'
	106024	6RV-2	Pipe - 2'
	106018	6RV-18	Pipe - 18"
	106012	6RV-12	Pipe - 12"
	106006	6RV-6	Pipe - 6"

Size	Product No.	Part No.	Lengths
7"	107060	7RV-5	Pipe - 5'
	107048	7RV-4	Pipe - 4'
	107036	7RV-3	Pipe - 3'
	107024	7RV-2	Pipe - 2'
	107018	7RV-18	Pipe - 18"
	107012	7RV-12	Pipe - 12"
	107006	7RV-6	Pipe - 6"

Size	Product No.	Part No.	Lengths
8"	108060	8RV-5	Pipe - 5'
	108048	8RV-4	Pipe - 4'
	108036	8RV-3	Pipe - 3'
	108024	8RV-2	Pipe - 2'
	108018	8RV-18	Pipe - 18"
	108012	8RV-12	Pipe - 12"
	108006	8RV-6	Pipe - 6"

ADJUSTABLE LENGTH

- Used in combination with a straight length, this component assures that an exact required vent length can be achieved
- Allows for easy disassembly and can absorb the linear expansion of longer pipe lengths
- 12" Length adjusts from 3 1/2" to 10 1/2"
- 18" Length adjusts from 6" to 16"



Size	Product No.	Part No.	Lengths
3"	103082	3RV-AJ12	12"
	103084	3RV-AJ18	18"
4"	104082	4RV-AJ12	12"
	104084	4RV-AJ18	18"

Size	Product No.	Part No.	Lengths
5"	105082	5RV-AJ12	12"
	105084	5RV-AJ18	18"

Size	Product No.	Part No.	Lengths
6"	106082	6RV-AJ12	12"
	106084	6RV-AJ18	18"

Size	Product No.	Part No.	Lengths
7"	107082	7RV-AJ12	12"

Size	Product No.	Part No.	Lengths
8"	108082	8RV-AJ12	12"

RV

3" THROUGH 8"

VENT PIPE

EZ ADJUSTABLE LENGTH

- Used in combination with a straight length, assures an exact length can be achieved
- 12" Length adjusts from 3 1/2" to 10 1/2"
- 18" Length adjusts from 6" to 16"

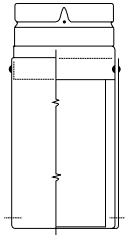

Size	Product No.	Part No.	Lengths
3"	103086	3RV-EZAJ12	12"
	103090	3RV-EZAJ18	18"
4"	104086	4RV-EZAJ12	12"
	104090	4RV-EZAJ18	18"

Size	Product No.	Part No.	Lengths
5"	105086	5RV-EZAJ12	12"
	105090	5RV-EZAJ18	18"

Size	Product No.	Part No.	Lengths
6"	106086	6RV-EZAJ12	12"
	106090	6RV-EZAJ18	18"

Size	Product No.	Part No.	Lengths
7"	107086	7RV-EZAJ12	12"

Size	Product No.	Part No.	Lengths
8"	108086	8RV-EZAJ12	12"

ELBOWS, TEES AND WYES

90° ADJUSTABLE ELBOW

- Used when an offset is required to avoid obstructions such as rafters, joists and other construction obstacles
- Used to orient pipe between vertical and horizontal orientation
- Four piece adjustable elbow twists for easy offsets

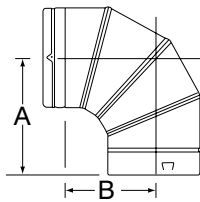

Size	Product No.	Part No.	a	b
3"	103230	3RV-90	6 3/8"	4 1/16"
4"	104230	4RV-90	6 3/8"	4 1/16"
5"	105230	5RV-90	6 3/8"	4 1/16"
6"	106230	6RV-90	6 3/8"	4 1/16"
7"	107230	7RV-90	8"	6 1/2"
8"	108230	8RV-90	8 1/4"	6 3/4"

NOTE: 3", 4", 5", 6" - 90° Elbow - Four Gore
7", 8" - 90° Elbow - Three Gore

45°/60° ADJUSTABLE ELBOW

- Used when an offset is required to avoid obstructions such as rafters, joists and other construction obstacles
- Three piece adjustable elbow twists for easy offsets

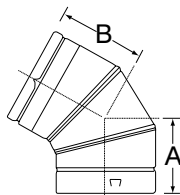

45° Adjustable Elbow

Size	Product No.	Part No.	Outer	a	b
7"	107215	7RV-45	7 1/2"	3 3/16"	7 1/2"
8"	108215	8RV-45	8 1/2"	3 3/4"	8 1/2"

45°/60° Adjustable Elbow

Size	Product No.	Part No.	Outer	a	b
3"	103222	3RV-60	3 1/2"	4 3/8"	4 1/16"
4"	104222	4RV-60	4 1/2"	4 3/8"	4 1/16"
5"	105222	5RV-60	5 1/2"	4 3/8"	4 1/16"
6"	106222	6RV-60	6 1/2"	4 3/8"	4 1/16"

STANDARD TEE

- Used to transition system from horizontal to vertical orientation
- Provides easy access for inspection and maintenance
- Tee Cap sold separately

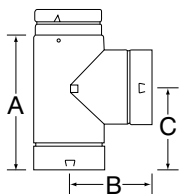

Size	Product No.	Part No.	a	b	c
3"	103100	3RV-TS	6 5/8"	4 1/4"	4 1/4"
4"	104100	4RV-TS	8 1/2"	4 3/4"	5"
5"	105100	5RV-TS	9 1/2"	5 1/4"	5 1/2"
6"	106100	6RV-TS	10 1/2"	5 3/4"	6"
7"	107100	7RV-TS	11 1/2"	6 1/4"	6 1/2"
8"	108100	8RV-TS	12 1/2"	6 3/4"	7"

NOTE: Reduction Tee Available.

TEE CAP

- Used at bottom of Tee
- Removable for easy system maintenance



Size	Product No.	Part No.
3"	103180	3RV-TC
4"	104180	4RV-TC
5"	105180	5RV-TC
6"	106180	6RV-TC
7"	107180	7RV-TC
8"	108180	8RV-TC

FIXED WYE

- Used to transition system from horizontal to vertical orientation
- Provides better flue gas flow than a traditional Tee

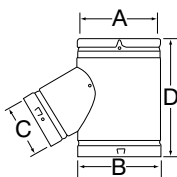

Size	Product No.	Part No.	a	b	c	d
4" x 3"	104133	4RV3-FY	4"	4"	3"	10"
4" x 4"	104134	4RV4-FY	4"	4"	4"	10"
5" x 3"	105133	5RV3-FY	5"	5"	3"	10"
5" x 4"	105134	5RV4-FY	5"	5"	4"	10"
5" x 4" x 3"	1051343	5RV4-3FY	5"	4"	3"	11.5"
5" x 4" x 4"	1051344	5RV4-4FY	5"	4"	4"	11.5"
6" x 3"	106133	6RV3-FY	6"	6"	3"	11"
6" x 4"	106134	6RV4-FY	6"	6"	4"	11"
6" x 5"	106135	6RV5-FY	6"	6"	5"	11"

TOPS, SUPPORTS AND FIRESTOPS

TOP (BIRD PROOF*)



- These tops cannot be used for wood burning applications
- Helps prevent rain and debris from entering the vent
- External screen prevents entry of most bird species

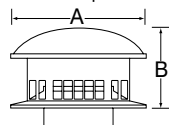

Size	Product No.	Part No.	a	b
3"	103800	3RV-RT	6"	3 1/4"
4"	104800	4RV-RT	8"	4 1/4"
5"	105800	5RV-RT	10"	5 1/4"
6"	106800	6RV-RT	12"	6 1/4"
7"	107800	7RV-RT	14"	7 1/2"
8"	108800	8RV-RT	16"	8 1/2"

HI-WIND TOP

- Used in high wind environments
- Improves flue gas flow to prevent downdrafts

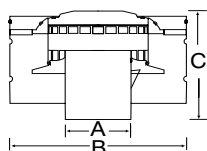

Size	Product No.	Part No.	a	b	c
3"	103802	3RV-HWT	3"	8"	5 1/2"
4"	104802	4RV-HWT	4"	10"	6"
5"	105802	5RV-HWT	5"	12"	7"
6"	106802	6RV-HWT	6"	14"	7 1/2"

SUPPORT ASSEMBLY

- Support Plate should be installed above the joist
- Support Plate also serves as a firestop
- Will support a maximum of 35' of gas vent

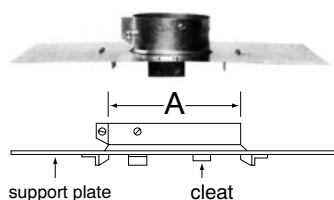

Size	Product No.	Part No.	a	Support Plate Dim
3"	103400	3RV-GVS	3 5/8"	17" x 10"
4"	104400	4RV-GVS	4 5/8"	17" x 10"
5"	105400	5RV-GVS	5 5/8"	17" x 12"
6"	106400	6RV-GVS	6 5/8"	17" x 12"
7"	107400	7RV-GVS	7 5/8"	17" x 14"
8"	108400	8RV-GVS	8 5/8"	17" x 14"

GAS VENT SUPPORT COLLAR & HARDWARE

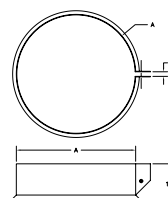

Size	Product No.	Part No.	a
3"	103402	3RV-GVSB	3 5/8"
4"	104402	4RV-GVSB	4 5/8"
5"	105402	5RV-GVSB	5 5/8"
6"	106402	6RV-GVSB	6 5/8"
7"	107402	7RV-GVSB	7 5/8"

WALL THIMBLE

- Used to ensure clearance to combustibles is maintained
- Wall Thimble also serves as a firestop
- Adjusts from 4 - 1/8" to 7" to fit thickness of wall

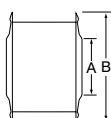

Size	Product No.	Part No.	a	b
3"	187703	3RV-WT	3 5/8"	7"
4"	187704	4RV-WT	4 5/8"	8 1/4"
5"	187705	5RV-WT	5 5/8"	9 1/2"
6"	187706	6RV-WT	6 5/8"	10 3/4"
7"	187707	7RV-WT	7 3/4"	11"
8"	187708	8RV-WT	8 3/4"	12 1/2"

WALL SUPPORT/BAND ASSEMBLY

- Used to support and stabilize the pipe against an outside wall
- Will support up to 35'

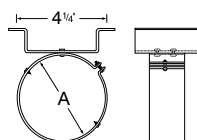

Size	Product No.	Part No.	a
3"	103430	3RV-WS/B	3 5/8"
4"	104430	4RV-WS/B	4 5/8"
5"	105430	5RV-WS/B	5 5/8"
6"	106430	6RV-WS/B	6 5/8"
7"	107430	7RV-WS/B	7 5/8"
8"	108430	8RV-WS/B	8 5/8"

WALL BAND

- Used to stabilize the pipe against an outside wall
- Must be installed just above the Tee and every 6' thereafter

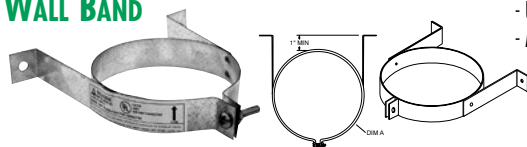

Size	Product No.	Part No.	a
3"	103431	3RV-WB	3 1/2" min
4"	104431	4RV-WB	4 1/2" min
5"	105431	5RV-WB	5 1/2" min

GAS VENT FIRESTOP SPACER

- Used to protect combustible materials where pipe passes through a ceiling or wall
- Extended bottom flange

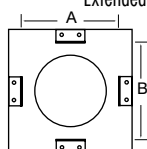
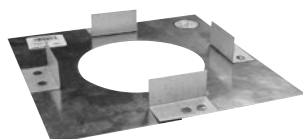

Size	Product No.	Part No.	Framing Size a & b
3"	103461	3RV-FS	5 1/2"
4"	104461	4RV-FS	6 1/2"
5"	105461	5RV-FS	7 1/2"
6"	106461	6RV-FS	8 1/2"
7"	107461	7RV-FS	9 1/2"
8"	108461	8RV-FS	10 1/2"

RV

3" THROUGH 8"

TOPS, SUPPORTS AND FIRESTOPS

QUICK GRIP FIRESTOP/SUPPORT

- Used to support and protect combustible materials where the pipe passes through a ceiling

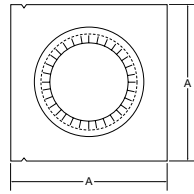
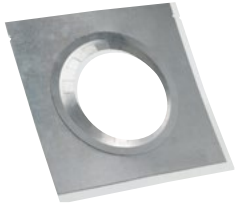

Size	Product No.	Part No.	a
3"	103406	3RV-FSP	9"
4"	104406	4RV-FSP	10"
5"	105406	5RV-FSP	11"
6"	106406	6RV-FSP	12"

Size	Product No.	Part No.	UL Model
3"	103404	3RV-FSPU	9"
4"	104404	4RV-FSPU	10"
5"	105404	5RV-FSPU	11"
6"	106404	6RV-FSPU	12"

NOTE: UL-listed model includes an attached spacer ring to ensure 1" clearance to combustibles.

PIPE COLLAR

- Provides a decorative/finished appearance
- Pipe collar also acts as a firestop

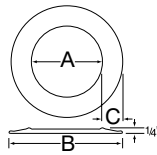

Size	Product No.	Part No.	a	b	c
3"	103460	3RV-GC	3 3/4"	8 1/2"	2 3/8"
4"	104460	4RV-GC	4 3/4"	9 1/2"	2 3/8"
5"	105460	5RV-GC	5 3/4"	10 1/2"	2 3/8"
6"	106460	6RV-GC	6 3/4"	11 1/2"	2 3/8"
7"	107460	7RV-GC	7 3/4"	12 1/2"	2 3/8"

NOTE: May be used as firestop for openings in floors, ceilings and walls.

FLASHINGS AND STORM COLLAR

ADJUSTABLE ROOF FLASHING

- Used where the vent passes through a roof

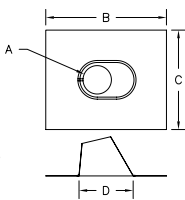
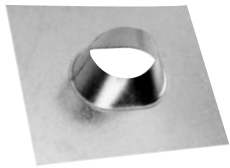

Size	Product No.	Part No.	a	b	c	d
3"	103825	3RV-AF	3 1/2"	14 7/8"	12 1/4"	6 11/16"
4"	104825	4RV-AF	4 1/2"	16"	13 3/4"	7 3/4"
5"	105825	5RV-AF	5 1/2"	16 15/16"	14 1/4"	8 7/8"
6"	106825	6RV-AF	6 1/2"	18"	15 1/4"	10"
7"	107825	7RV-AF	7 1/2"	19 1/8"	16"	11 1/8"
8"	108825	8RV-AF	8 1/2"	20 1/4"	16 15/16"	12 1/4"

Size	Product No.	Part No.	a	b	c	d
3"	103830	3RV-AF12	3 1/2"	18"	15 1/4"	10 1/4"
4"	104830	4RV-AF12	4 1/2"	19 1/8"	16"	11 1/8"
5"	105830	5RV-AF12	5 1/2"	20 1/4"	16 15/16"	12 1/4"
6"	106830	6RV-AF12	6 1/2"	24 1/4"	20"	15 5/8"
7"	107830	7RV-AF12	7 1/2"	24 1/4"	20"	15 5/8"
8"	108830	8RV-AF12	8 1/2"	25"	19 1/2"	17 1/8"

TALL CONE ADJUSTABLE ROOF FLASHING

- Used where the vent passes through a roof
- Adjustable to 6/12 pitch

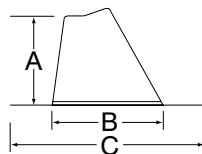
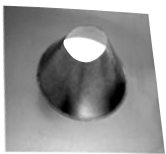

Size	Product No.	Part No.	a	b	c
3"	103820	3RV-TFA	8 3/4"	11"	19 1/2"
4"	104820	4RV-TFA	8 3/4"	11"	19 1/2"
5"	105820	5RV-TFA	8 3/4"	11"	19 1/2"
6"	106820	6RV-TFA	8 3/4"	11"	19 1/2"
7"	107820	7RV-TFA	8 3/4"	14"	22"
8"	108820	8RV-TFA	8 3/4"	15 3/16"	23"

TALL CONE FLAT ROOF FLASHING

- Used on flat roof surfaces

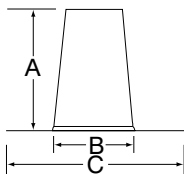

Size	Product No.	Part No.	a	b	c
3"	103815	3RV-TF	12"	7 1/2"	16 1/2"
4"	104815	4RV-TF	12"	7 1/2"	16 1/2"
5"	105815	5RV-TF	12"	7 1/2"	16 1/2"
6"	106815	6RV-TF	12"	11"	19 1/2"
7"	107815	7RV-TF	12"	11"	19 1/2"
8"	108815	8RV-TF	12"	11"	19 1/2"

STORM COLLAR

- Used to provide a weather proof seal to pipe above roof line
- Used above the Flashing
- Seal inner edge with hi-temp silicone sealant

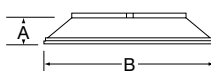

Size	Product No.	Part No.	a	b
3"	103810	3RV-SC	1 1/16"	6 5/8"
4"	104810	4RV-SC	1 1/16"	7 5/8"
5"	105810	5RV-SC	1 1/16"	8 5/8"
6"	106810	6RV-SC	1 1/16"	9 5/8"
7"	107810	7RV-SC	1 1/16"	10 3/4"
8"	108810	8RV-SC	1 1/16"	11 3/4"

NOTE: See instructions for use/limitations

ADAPTERS, CONNECTORS AND INCREASERS

DRAFT HOOD CONNECTOR

- Connects single wall Vent to B Vent
- Used to connect pipe to draft hood at appliance

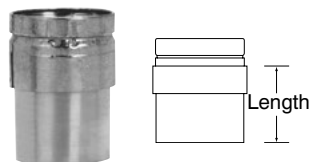

Size	Product No.	Part No.	Lengths
3"	103240	3RV-DH	4½"
4"	104240	4RV-DH	4½"
5"	105240	5RV-DH	4½"
6"	106240	6RV-DH	4½"
7"	107240	7RV-DH	7"
8"	108240	8RV-DH	8"

DRAFT HOOD CONNECTOR LONG

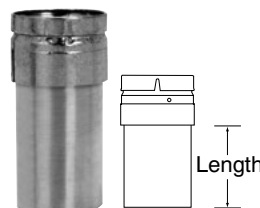

Size	Product No.	Part No.	Lengths
4"	104243	4RV-DHCL	5"

UNIVERSAL ADAPTERS

- Used to connect B Vent to/from 1/4" Type B Gas Vent
- Allows Selkirk B Vent to be used in conjunction with other brands of existing vent.

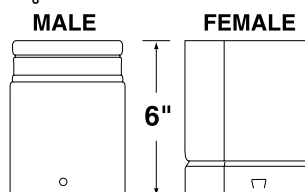

Universal Adapter - Male

Size	Product No.	Part No.
3"	103081	3RV-UAM
4"	104081	4RV-UAM
5"	105081	5RV-UAM
6"	106081	6RV-UAM
7"	107081	7RV-UAM
8"	108081	8RV-UAM

NOTE: Male adapter used to adapt to Selkirk pipe toward termination.

Universal Adapter - Female

Size	Product No.	Part No.
3"	103080	3RV-UAF
4"	104080	4RV-UAF
5"	105080	5RV-UAF
6"	106080	6RV-UAF
7"	107080	7RV-UAF
8"	108080	8RV-UAF

NOTE: Female adapter used to adapt to Selkirk pipe toward appliance.

APPLIANCE INCREASERS

- Increase 3" to 4" only

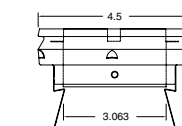
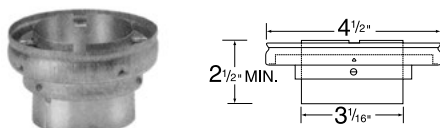

Rheem/Rudd Appliance Adapter

Size	Product No.	Part No.
3" x 4"	103244	3RV-AI4
3" x 4"	104248*	4RV-3RA

* Only for use with Rheem / Rudd appliances

DOUBLE WALL INCREASER

- Used to increase pipe diameter

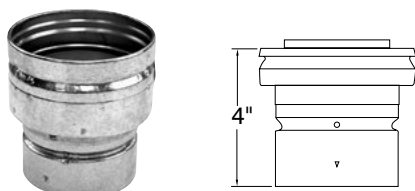

Size	Product No.	Part No.
3"	103324	3RV-14DW
3"	103325	3RV-15DW
4"	104325	4RV-15DW
4"	104326	4RV-16DW
5"	105326	5RV-16DW

LOW PROFILE DOUBLE WALL INCREASER

- Used to increase pipe diameter
- Used for tight installations to optimize space

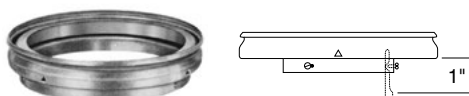

3"	Size	Product No.	Part No.	4"	Size	Product No.	Part No.	5"	Size	Product No.	Part No.	6"	Size	Product No.	Part No.
	3" x 4"	103304	3RV-I4		4" x 5"	104305	4RV-I5		5" x 6"	105306	5RV-I6		6" x 7"	106307	6RV-I7
	3" x 5"	103305	3RV-I5		4" x 6"	104306	4RV-I6		5" x 7"	105307	5RV-I7		6" x 8"	106308	6RV-I8
	3" x 6"	103306	3RV-I6		4" x 7"	104307	4RV-I7		5" x 8"	105308	5RV-I8		7" x 8"	107308	7RV-I8
	3" x 7"	103307	3RV-I7		4" x 8"	104308	4RV-I8						8" x 10"	108310	8RV-I10
	3" x 8"	103308	3RV-I8												

NOTE:

Other sizes available for project work on special order. Allow 30 working days after placing order. Maximum screw size 3/8"

REDUCER

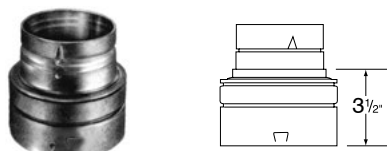

NOTE: One step only

Size	Product No.	Part No.	1 Step
4"	104363	4RV-R3	4" x 3"
5"	105364	5RV-R4	5" x 4"
6"	106365	6RV-R5	6" x 5"
7"	107366	7RV-R6	7" x 6"
8"	108367	8RV-R7	8" x 7"