

MAAX SUBMITTAL SPECIFICATIONS

Vivez l'expérience

MAAX®

Enjoy the experience

CS P5

MODEL NUMBER 103567

DIMENSIONS: 60" x 42" x 20" Acrylic

Water Capacity: Maximum 57 G Minimum 38 G



STANDARD FEATURES

- Styled for lasting, timeless appeal. Available in tub only and an array of True Whirlpool Systems, Aeroeffect Air Systems and Combination True Whirlpool and Aeroeffect Air Systems. Options include cable-operated waste and overflow, chromatherapy and pillow. Drop-in or undermount installation.

OPTIONS

- n/a

UNIQUE FEATURES

- n/a

SYSTEMS

DOOR SELECTION

Combine with MAAX's complete shower door offering visit www.maax.com

Project :

Contractor :

MAAX Representative : Tel :

Date :

CERTIFICATIONS

Maax products adhere to one or more of the following certifications:



MAAX SUBMITTAL SPECIFICATIONS

CS P5

MODEL NUMBER 103567

TECHNICAL DRAWINGS

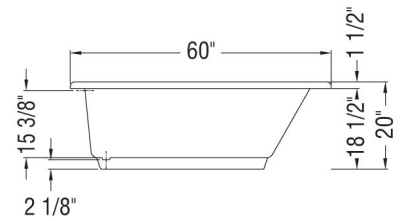
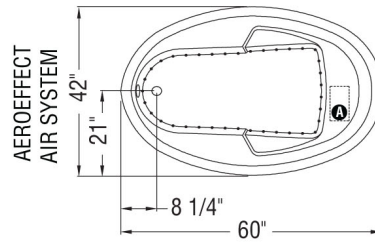
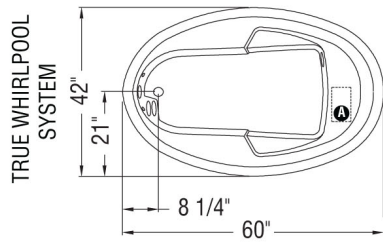

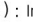
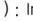
- A** : Indicates pump or blower positioning
- () : Indicates True Whirlpool jets positioning
- () : Indicates Aerofeel airjet positioning