

### Features

- Brass construction.
- Dual control wall-mounted.
- Lever handles are ADA compliant.
- Less drain.
- Stationary spout.
- 4-9/16" (116 mm) min to 6-1/16" (154 mm) max spout from the wall to center of the outlet.
- 1.5 gal/min (5.7 l/min) maximum flow rate [max at 60 psi (4.14 bar)].

### Required Accessories

K-410-K Wall-mount Valve



For complete listing of available colors, go to [kohler.com](http://kohler.com).



### Codes/Standards

ASME A112.18.1/CSA B125.1

NSF 61

NSF 372

ADA

ICC/ANSI A117.1

DOE - Energy Policy Act 1992

EPA WaterSense®

All applicable US Federal and State material regulations

### KOHLER® Faucet Lifetime Limited Warranty

See website for detailed warranty information.

### Product Specification

Bathroom sink faucet trim shall be 4-9/16" (116 mm) min to 6-1/16" (154 mm) max spout from the wall to center of the outlet. Bathroom sink faucet trim shall be brass construction. Bathroom sink faucet trim shall be lever handles. Bathroom sink faucet trim shall be stationary spout. Bathroom sink faucet trim shall be dual control wall-mount installation. Bathroom sink faucet trim shall be KOHLER Model K-T944-4.

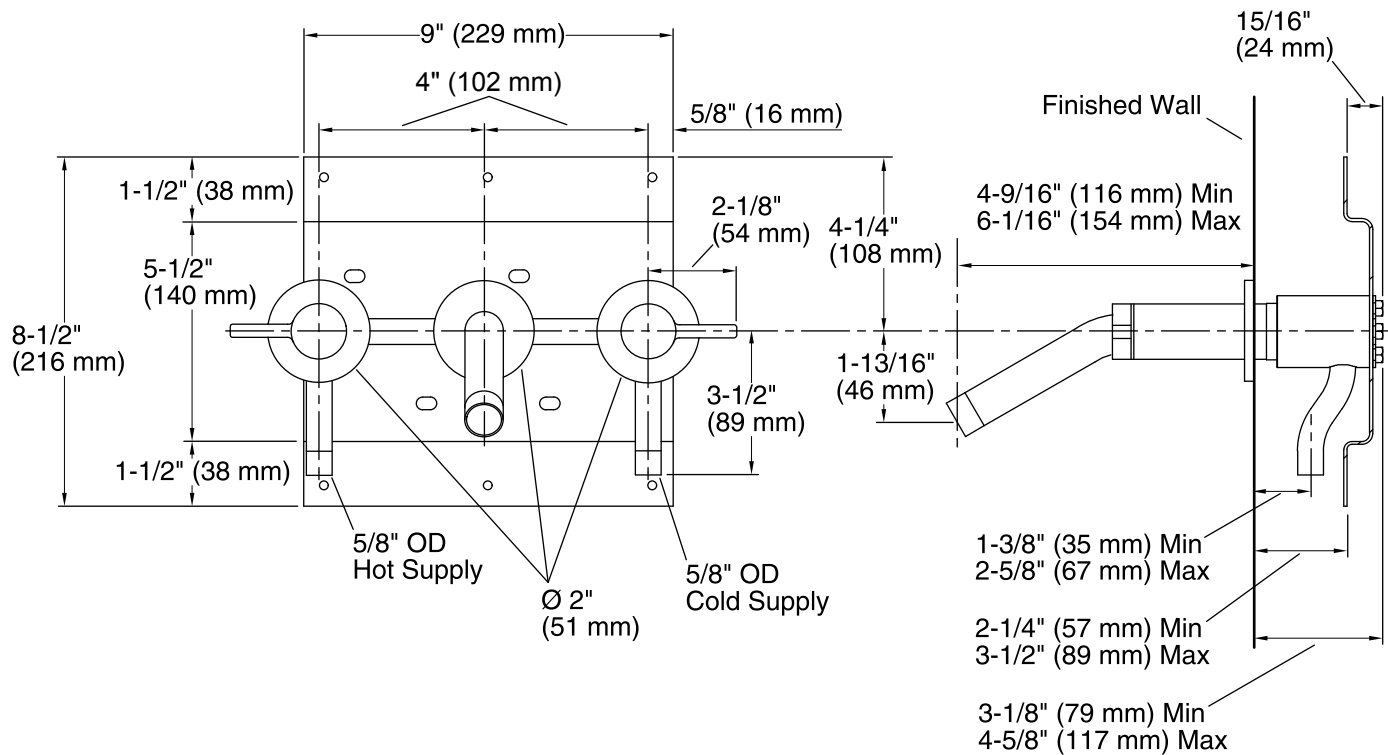

## Technical Information

All measurements are nominal.

### Faucet:

Flow rate: 1.5 gal/min (5.7 l/min)  
Pressure: 60 psi (4.1 bar)

## Installation Notes

Install this product according to the installation guide.

A minimum of 4" (102 mm) must be maintained between the bottom of the spout and the top of the fixture rim.

Three 1-1/2" (38 mm) diameter holes are required for the spout and handles.

ADA compliant when installed to the specific requirements of these regulations.