

Applicable product:		
Countertop lavatory, less soap dispenser hole; with overflow	K-2196-8	shown
Countertop lavatory with soap dispenser hole on left; with overflow	K-2196-8L	
Countertop lavatory with soap dispenser hole on right; with overflow	K-2196-8R	
Countertop lavatory, less soap dispenser hole; less overflow	K-2196-8N	not shown
Countertop lavatory with soap dispenser hole on right; less overflow	K-2196-8K	
Countertop lavatory with soap dispenser hole on left; less overflow	K-2196-8F	
Lavatory is ADA compliant when installed according to the ADA guidelines.		

ADA

Holes	Spout	Faucet	Soap dispenser
	1-3/8" (3.5 cm) D.	1-3/8" (3.5 cm) D.	1-1/4" (3.2 cm) D.

Included components:	
Cut-out template	1002970-7

Install this product according to the installation guide.

NOTICE: Countertop manufacturer or cutter **must** use the cut-out template provided with the product, or a current one provided by Kohler Co. (call 1-800-4-KOHLER). Kohler Co. is not responsible for cutout errors when the incorrect cut-out template is used.

Fixture dimensions are nominal and conform to tolerances in ASME Standard A112.19.2.

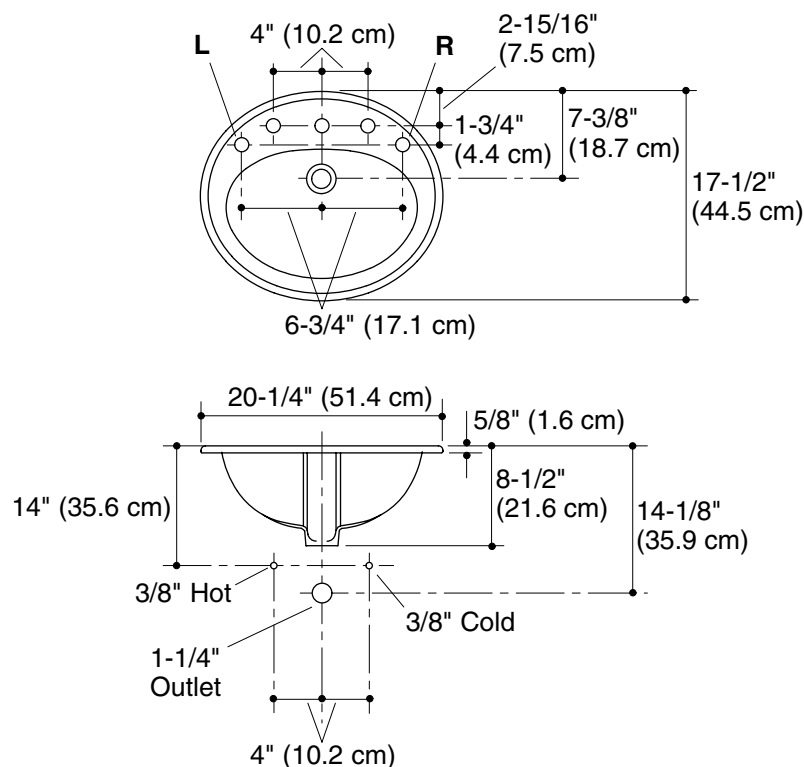

24" (61 cm)

3" (7.6 cm)

32" (81.3 cm)
-34" (86.4 cm)

27" (68.6 cm)
Min

8" (20.3 cm)
Min

6" (15.2 cm)
Max

9" (22.9 cm)
Min

Recommended ADA Clearance