

Features

- Metal construction
- Brass valve bodies
- Flexible connections for easy installation
- For 8" (20.3 cm) or 16" (40.6 cm) centers
- Stationary spout
- Less drain
- 4-1/4" (10.8 cm) spout reach
- Quarter-turn washerless ceramic disc valves
- Available with red and blue index washers [-4]
- Available with sculpted acrylic handles [-7] or ADA compliant lever handles [-4]
- 1.5 gallons (5.7 liters) per minute maximum flow rate



Codes/Standards Applicable

Specified model meets or exceeds the following at date of manufacture:

- ADA with lever handles only
- ASME A112.18.1/CSA B125.1
- ICC/ANSI A117.1
- NSF 61
- Energy Policy Act of 1992
- EPA WaterSense®
- All applicable US Federal and State material regulations

WIDESPREAD LAVATORY FAUCET K-15265

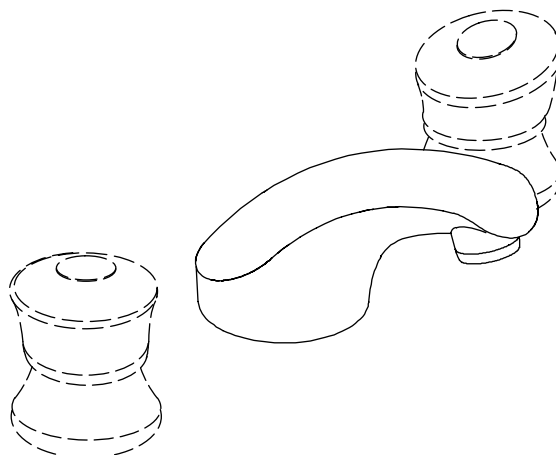



Colors/Finishes

- CP: Polished Chrome

Accessories

- NA: None applicable

Specified Model

Model	Description	Lever Handles 	Sculpted Acrylic Handles 
K-15265-4	Widespread lavatory faucet – ADA compliant lever handles, red and blue index washers	<input type="checkbox"/> CP	
K-15265-7	Widespread lavatory faucet – sculpted acrylic handles (shown)		<input type="checkbox"/> CP

Product Specification

The two-handle widespread lavatory faucet shall be made of metal construction with brass valve bodies. Product shall have a maximum flow rate of 1.5 gallons (5.7 liters) per minute. Product shall feature quarter-turn washerless ceramic disc valves, flexible connections for easy installation, a 4-1/4" (10.8 cm) spout reach, and a stationary spout. Product shall be for 8" (20.3 cm) or 16" (40.6 cm) centers. Product shall be less drain. Product shall be available with sculpted acrylic handles [-7] or ADA compliant lever handles [-4]. Product shall be available with red and blue index washers [-4]. Faucet shall be Kohler Model K-15265-____-____.

CORALAIS®

Optional Accessories

Additional flow options are available (refer to the Kohler Price Book)

☐ NA

Installation Notes

Install this faucet following the installation instructions provided.

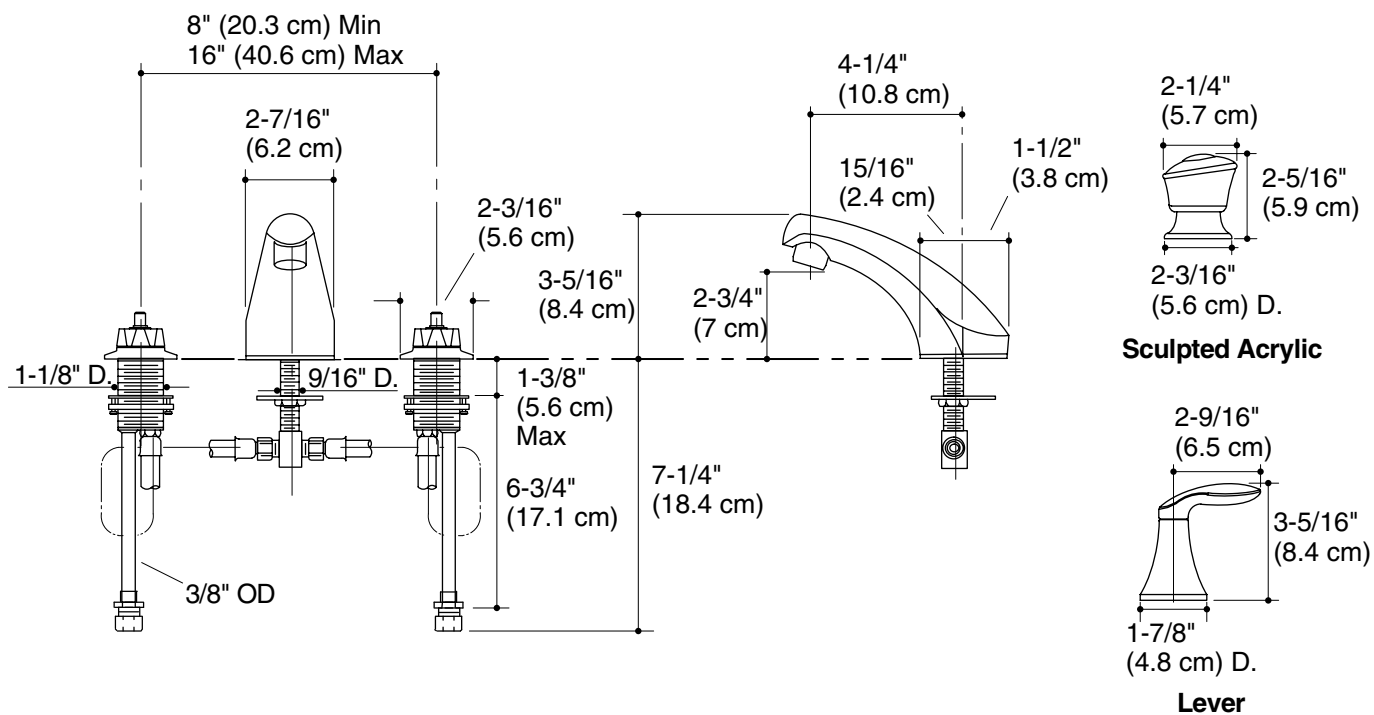

Product Diagram