

# KOHLER®

## Roughing-In

### K-1154, K-1154-F PROFLEX® 5454 ACRYLIC BATH WHIRLPOOL

#### Product Information

Applicable product:	
Bath whirlpool, drop-in rim style, right-hand pump	K-1154
Bath whirlpool, tile flange, right-hand pump	K-1154-F
Recommended accessories:	
Drain	K-11677
Fixture*:	
Basin area:	
Bathing well	44" (111.8 cm) x 36" (91.4 cm)
Top area	56" (142.2 cm) x 43" (109.2 cm)
To overflow:	
Water depth	15" (38.1 cm)
Capacity	76 gal (287.7 L)
Weight	65 lbs (29.5 kg)
* Approximate measurements for comparison only.	

Pump:	Hp	V	Hz	A
1-speed	1.25	120	60	7.5
Minimum access panel pump/control:				
20" (50.8 cm) W x 15" (38.1 cm) H				required

#### Required Electrical Service

Dedicated circuit required, protected with Class A Ground-Fault Circuit-Interrupter (GFCI):	
Pump/control	120 V, 15 A, 60 Hz
Locate the outlet behind the whirlpool and within 24" (61 cm) of the pump.	

#### Installation Notes

Install this product according to the installation guide.

Floor support under whirlpool must provide for a minimum of 80 lbs/square foot (390 kg/square meter) loading.

This fixture conforms to ANSI Standard Z124.1.2. All dimensions are nominal.

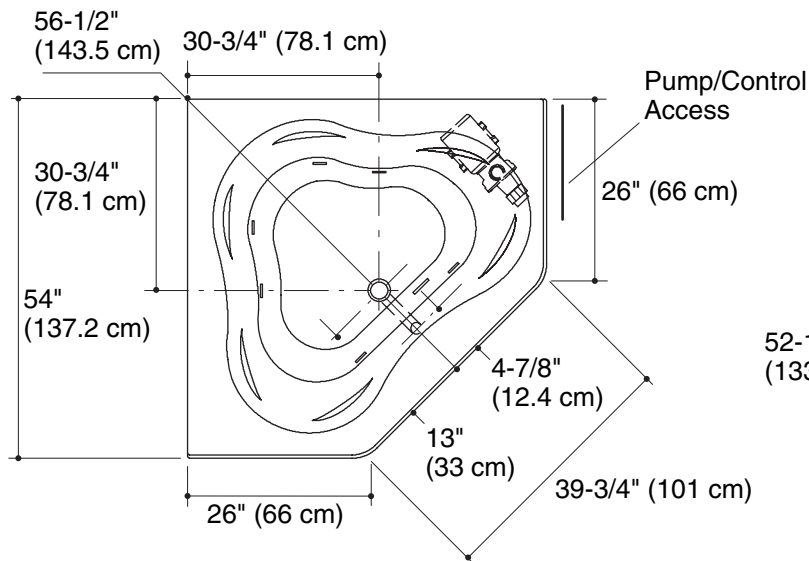

No change in measurements if connected with drain illustrated. (K-11677 or K-11677M)

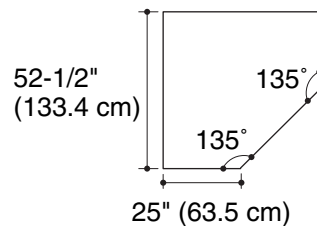

Drop-in Rim Style  
Cut-out Detail

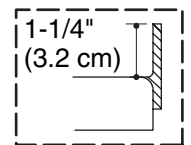

Tile Flange  
Detail

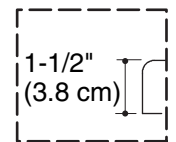
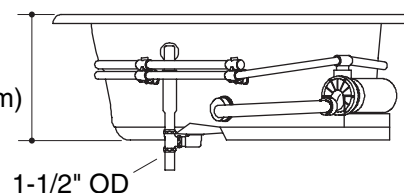
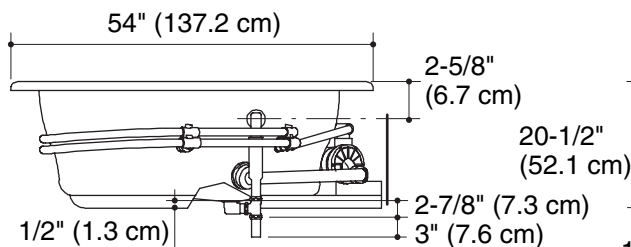

Drop-in Rim  
Detail