

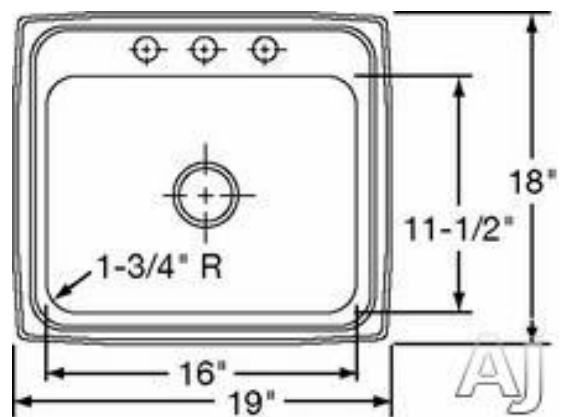

MLR1918-3



Elkay Lustertone Collection MLR1918-3

19" Top Mount Single Bowl Stainless Steel Sink with Type 316 Corrosion Resistant, 18-Gauge, 7-5/8" Bowl Depth, 18" Length, Self-Rim and Coved Corners

Discontinued

Specifications

Specifications

Single Bowl:	Yes
Faucet and Accessories:	Not Included
Gauge:	18
Type:	316 Stainless Steel
Bowl Depth:	7 5/8"
Coved Corners:	1 3/4" Vertical and Horizontal Radius
Bowl and Faucet Deck Recess:	3/16" Below Outside Edge of Sink
Finish:	Exposed Surfaces are Hand Blended to a Lustrous Highlighted Satin Finish
Underside:	Fully Undercoated to Dampen Sound and Prevent Condensation
Drain Opening:	3 1/2"
Dimensions	
Overall Width:	19"
Overall Length:	18"
Bowl Width:	16"
Bowl Length:	11 1/2"
Bowl Depth:	7 5/8"

Cutout Width: 18 3/8"
Cutout Length: 17 3/8"
Min. Cabinet Size: 24"

Features

- Single Bowl.
- 18 Gauge.
- Type 316-Self Rim.
- More corrosion resistant.
- Highest quality.
- Seamlessly drawn from nickel bearing stainless steel.
- Bowl depth: 7 5/8".
- 1 3/4" radius coved corners.
- Exposed surfaces hand blended to a lustrous highlighted Lustertone satin finish.
- Bowl and faucet deck are recessed 3/16" below outside edge of sink.
- Underside is fully undercoated.
- Drain opening is 3 1/2".

HOLE DRILLING CONFIGURATIONS

