

Instant Comfort...Endless Savings

Made In USA 

## ELECTRIC TANKLESS WATER HEATERS

7/10

### MODELS:

#### “STAGED” Models (Twin Module) Thermostatic Control

TC = Turns on in stages based on hot water demand.

Min. flow, 0.7 GPM, max 3 GPM

#### APPLICATIONS

- Multi fixture
- Residential Showers
- Commercial/Industrial
- Photo Processing
- Adjustable, Precise Temperature Setting +/- 1°F (ambient to 180°)
- Anti Scald Protection
- Solar backup

Models	Options	Volts	kW	Amps
EX120TC	FS,ML,S	240V	11.5kW	48A
EX144 TC	FS,ML,S	240V	15kW	64 (2x32)A
EX190TC	FS,ML,S	240V	19kW	80 (2x40)A
EX023240TC	FS,ML,S	240V	23kW	96 (2x48)A
EX1608TC	FS,ML,S	208V	16.6kW	80 (2x40)A
EX160TC	FS,ML,S	277V	16kW	58 (2x29)A
EX200TC	FS,ML,S	277V	20kW	72 (2x36)A

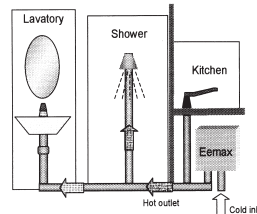

Multi Outlet



(T2)

#### THERMOSTATIC SPECIFICATION OPTIONS

- TC = Hot or cold water feed, “staged” turn on
- ML = Multi lavs .5 turn on. staged up to 4 lavs 105°-110° temp setting
- S = Sanitation 180°
- FS = Factory set ambient to 180°
- Nema 4 Enclosure (option)

#### “PARALLEL” Models (Twin Module) Thermostatic Control

T2 = Parallel turn on. Min. flow, 1.5 GPM, max 4 GPM

#### APPLICATIONS:

- Single high volume fixture
- Commercial Dishwashers
- Booster (Solar backup, jetted bathtub)
- Commercial/Industrial
- Adjustable, Precise Temperature Setting +/- 1°F (ambient up to 180°)
- Anti Scald Protection

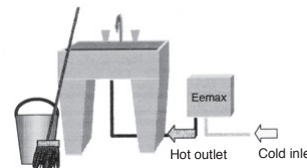

Mop Sink

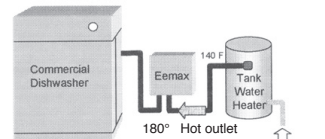

Booster



(TC)

#### THERMOSTATIC SPECIFICATION OPTIONS

- T2 = Hot or cold water feed “parallel” turn on
- EE = Emergency eye/face wash ANSI Z358.1 tepid water
- S = Sanitation 180°
- FS = Factory set ambient to 180°
- Nema 4 Enclosure (option)

#### Thermostatic

Model	Options	Volts	kW	Amps
EX120T2	EE,S,FS	240V	11.5kW	48A
EX144T2	EE,S,FS	240V	15kW	64 (2x32)A
EX190T2	EE,S,FS	240V	19kW	80 (2x40)A
EX023240T2	EE,S,FS	240V	23kW	96 (2x48)A
EX1608T2	EE,S,FS	208V	16.6kW	80 (2x40)A
EX160T2	EE,S,FS	277V	16kW	58 (2x29)A
EX200T2	EE,S,FS	277V	20kW	72 (2x36)A

### QUALITY FEATURES

- **On Demand Hot Water** - no delay.
- **Continuous Hot Water** - no storage capacity to run out.
- **Reduces Installation Cost** - no T&P relief valve needed (check local codes).
- **Easy Installation** - integral 3/4 npt fittings on bottom (no sweat connections).
- **Cut Energy Waste** - flow switch activates heater only on demand (no standby heat loss).
- **Anti Scald Protection(s)**
- **Meets ANSI Z358.1 tepid water requirement (T2EE)**
- **Reduces calcification.**
- **Ni Chrome Element** - a unique, patented flow path ensures optimum heat transfer and extended element life.
- **Compact Size** - dimensions; 10”x10.5”x3” weight 8 lbs
- **Field Serviceable Elements** - replaceable cartridge elements. (1 year warranty)
- **Designed for Durability; Warranty** - 1 year parts, 5 years leaks
- **Mounting** - Unit must be mounted on wall
- **High Temperature Limit Switch** - protects against element burn out, with reset button
- **LEED Certified**

# SUGGESTED SPECIFICATION

Thermostatic Series Two

- Spec Options:  T2 = Hot or cold water feed "parallel" turn on  
 TC = Hot or cold water feed "staged" turn on  
 EE = Tepid water 70° - 90° ANSI Z358.1 compliant (T2)  
 S = Sanitation 180° (T2)  
 ML = Multi lav temp setting 105° - 110° .5 GPM turn on up to 4 lavs  
 FS = Factory set ambient to 180°  
 Nema 4 enclosure (option)

Tankless Water Heater shall be an Eemax

"Series Two" Model \_\_\_\_\_ with \_\_\_\_\_ kW,  
model # kW rating  
 \_\_\_\_\_ vac, and \_\_\_\_\_ to heat \_\_\_\_\_ GPM  
voltage amperage

@ a temperature rise of \_\_\_\_\_ degrees F. Heater shall have two heating modules. Element shall be replaceable cartridge insert. Unit shall have a replaceable filter in the inlet connector. Heater shall be fitted with 3/4 npt water connections. Maximum operating pressure of 150 psi. Hot water storage tanks prohibited. Unit shall be Eemax or approved equal.

NOTE: Refer to rating chart for product information.

# SPECIFICATIONS:

Dimensions: 10" x 10.5" x 3"

Weight: 10.5 lbs.

Materials:

Cover: Enameled Steel.  
 Glass Reinforced Heater Body  
 and Ni Chrome Element

Color: White

Element: Dual replacement  
 cartridge inserts

Pipe-Fittings: 3/4 npt fittings at bottom of unit.

Operating Pressure: min. 40 PSI, max 150 PSI

U.S. Patent #s: 4,960,976

4,762,980

UL Listing: E 36887(M)

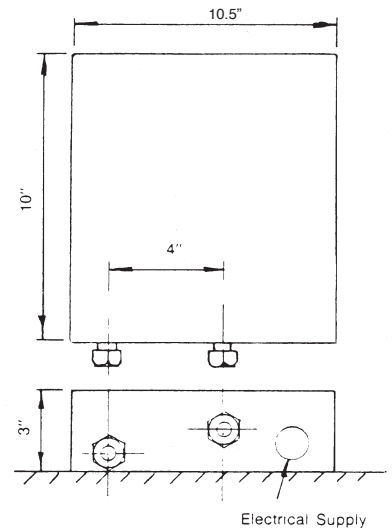

Electrical Supply



MADE IN USA



# RATINGS OF "SERIES TWO" MODELS

## "STAGED" Models (Twin Module)

With Thermostatic Control - Hot or cold water feed - "Staged" turn on, min flow .7 GPM, max 3 GPM

- TC = Hot or cold water feed "Staged" turn on  
 FS = Factory set ambient to 180°  
 ML = Multi lavs .5 turn on, staged up to 4 lavs 105°-110° temp setting  
 S = Sanitation 180°

MODEL	THERMOSTATIC OPTIONS	VOLTS	kW	AMPS	TEMPERATURE RISE °F				Recommended WIRE SIZE
					1.5GPM	2.0GPM	2.5GPM	3.0GPM	
EX144TC	FS,ML,S	240V	15kW	64 (2*x32)A	68°	51°	41°	34°	8AWG per module
EX190TC	FS,ML,S	240V	19kW	80 (2*x40)A	87°	65°	52°	43°	8AWG per module
EX023240TC	FS,ML,S	240V	23kW	96 (2*x48)A	105°	79°	62°	52°	6AWG per module
EX1608TC	FS,ML,S	208V	16.6kW	80 (2*x40)A	75°	57°	45°	38°	8AWG per module
EX160TC	FS,ML,S	277V	16kW	58 (2*x29)A	73°	55°	44°	36°	10AWG per module
EX200TC	FS,ML,S	277V	20kW	72 (2*x36)A	91°	68°	54°	46°	8AWG per module

- T2 = Hot or cold feed "parallel" turn on  
 FS = Factory set ambient to 180°

- EE = Emergency eye/face wash ANSI Z358.1 tepid water  
 S = Sanitation 180°

## "PARALLEL" Models (Twin Module)

With Thermostats Controls - Hot or Cold Water Feed - "Parallel" turn on - min flow 1.5 GPM, max 4 GPM

MODEL	THERMOSTATIC OPTIONS	VOLTS	kW	AMPS	TEMPERATURE RISE °F					Recommended WIRE SIZE
					1.5GPM	2.0GPM	2.5GPM	3.0GPM	4.0GPM	
EX144T2	EE,S,FS	240V	15kW	64 (2*x32)A	68°	51°	41°	34°	25°	8AWG per module
EX190T2	EE,S,FS	240V	19kW	80 (2*x40)A	87°	65°	52°	43°	32°	8AWG per module
EX023240T2	EE,S,FS	240V	23kW	96 (2*x48)A	105°	79°	62°	52°	39°	6AWG per module
EX1608T2	EE,S,FS	208V	16.6kW	80 (2*x40)A	75°	57°	45°	38°	28°	8AWG per module
EX160T2	EE,S,FS	277V	16kW	58 (2*x29)A	73°	55°	44°	36°	27°	10AWG per module
EX200T2	EE,S,FS	277V	20kW	72 (2*x36)A	91°	68°	54°	46°	34°	8AWG per module

\* The unit must have 2 independent electrical circuits using correctly rated wire and 2 circuit breakers.

**SPECIAL DESIGN SERVICE** INQUIRIES FOR UNITS FOR UNIQUE APPLICATIONS ARE WELCOME. CALL OUR TECHNICAL SERVICE DEPT. 1-800-543-6163.

## EEMAX SUBMITTAL

Engineer/Architect: \_\_\_\_\_  
 Job Name/Customer: \_\_\_\_\_  
 Location: \_\_\_\_\_  
 Contractor: \_\_\_\_\_  
 Representative: \_\_\_\_\_  
 HEATER SPECIFICATIONS:  
 Series Two Model # EX \_\_\_\_\_ Option \_\_\_\_\_ Quantity \_\_\_\_\_ kW \_\_\_\_\_ Voltage \_\_\_\_\_ AMPS \_\_\_\_\_ GPM \_\_\_\_\_



www.eemax.com

353 CHRISTIAN STREET, OXFORD, CT 06478

Telephone: (203) 267-7890  
 TOLL FREE: 1-800-543-6163  
 FAX: (203) 267-7975

EX09001-11