



WS-1X Individual Pivoting Wall Shower

- Industry Unique Hinge Design for Quick & Easy Installation and Maintenance
- Completely Preassembled and Ready to Mount to a Wall
- Flexible Supply Connections

Specifications

Materials

Shower panel is type 300 Series stainless steel. All other exposed parts are stainless steel or chrome-plated brass. Supply inlets are flexible stainless steel hoses.

Standard Equipment

Shower Panel

Shower panel is constructed of 18 gauge stainless steel. Top and bottom covers are riveted onto shower panel.

Hinges

Stainless steel barrel hinges to mount shower to wall.

Showerhead

Showerhead is chrome plated brass with 1.5 GPM (5.7 LPM) flow control, ball joint and adjustable spray pattern control(B).

Control Valve

All exposed parts are chrome plated or stainless steel. Control valve can be hot & cold type, single temperature type or metering.

Supply Inlets

Supply inlets are 24" flexible, stainless steel hoses with 1/2" NPT connections. Inlets are accessible through back of shower or through knockouts in the top and bottom covers.

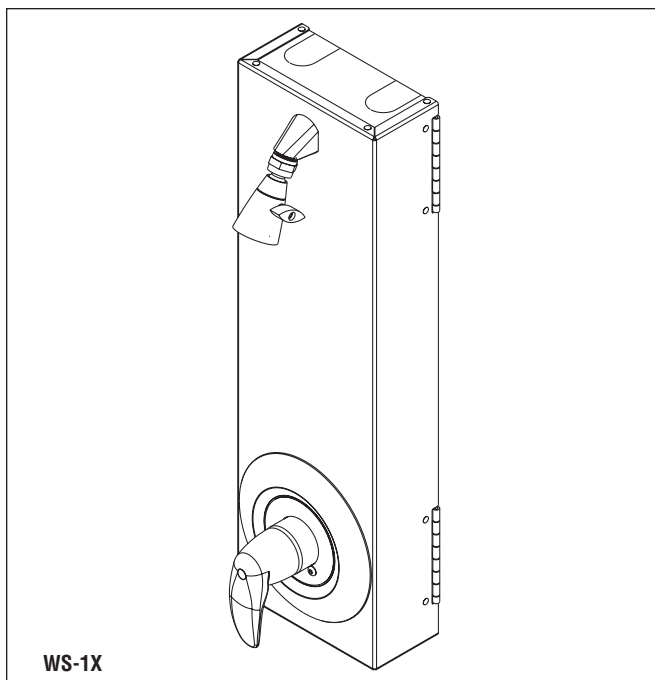

Standard Selections (Must select one from each category)

Showerhead Type

- ☐ **B** Axis Showerhead w/ Ball Joint (Flow Rate = 1.5 GPM/5.7 LPM)
- ☐ **S15** Standard Showerhead (Flow Rate = 1.5 GPM/5.7 LPM)
- ☐ **S20** Standard Showerhead (Flow Rate = 2.0 GPM/7.6 LPM)

Valve Type (select one)

Hot/Tempered and Cold Supplies

- ☐ **EF** Equa-Flo Pressure Balancing Valve
- ☐ **HD** Equa-Flo HD Pressure Balancing Valve
- ☐ **TMV** Thermostatic Mixing Valve

Single Tempered/Cold Supply

- ☐ **AST** Air Metering Valve
- ☐ **TT** TouchTime® Metering Valve**§

Optional Selections

Ball Joint (only available on S15 and S20 showerheads)

- ☐ **LBJ** Lockable Ball Joint

Miscellaneous

- ☐ **SB** Slide Bar (WS-1X-HN only)
- ☐ **B30** 30" Slide Bar (WS-1X-HN only)
- ☐ **SL** Sloped Top
- ☐ **SD** Wall Mounted Cake Soap Dish
- ☐ **SHV** Vertical Shroud
 - Showerhead Height _____
 - Floor to Ceiling Height _____
- ☐ **SHH** Horizontal Shroud* †
- ☐ **VS** Vandal Resistant Screws

*Non-cancelable, non-returnable

**TT valves require optional 24V Class 2 transformers, available as a separate item from Bradley. PT (S83-134) 24V Plug In Transformer (1/2 amp) Up to 2 showers.

† Submittal drawings required.

§ Please visit www.bradleycorp.com/dc for important information regarding a regulatory requirement to convert Bradley's TT activations from AC to DC starting in late 2016.

Verify all rough-in dimensions prior to installation.

Consult local and national codes: conformity and compliance to local and national codes is the responsibility of the installer.



Rough-Ins

WS-1X Individual Pivoting Wall Shower

(mm)

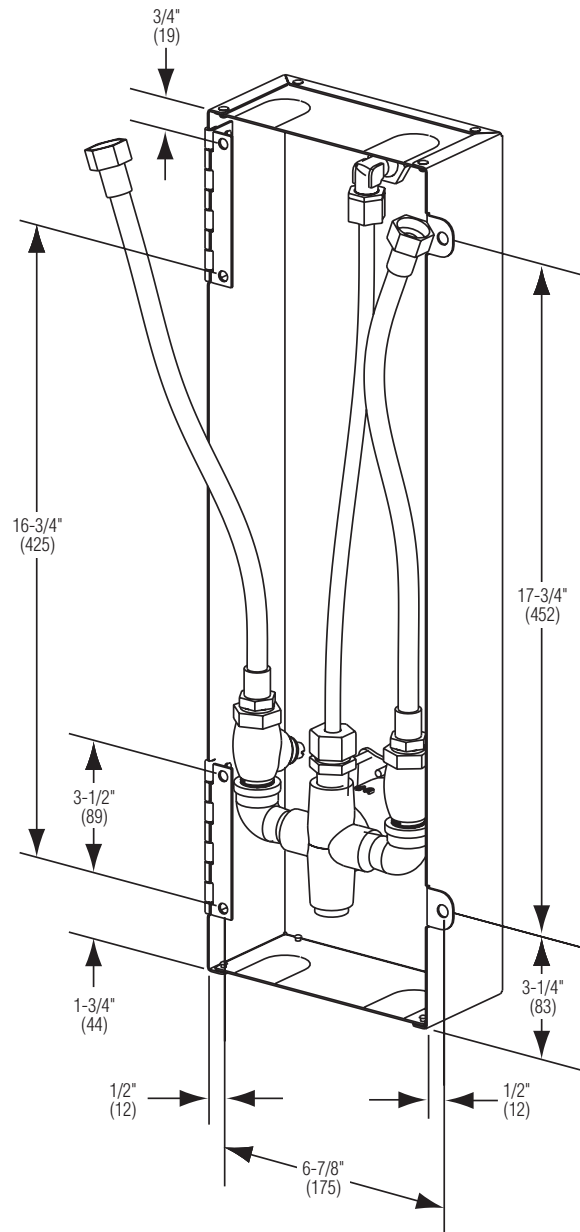
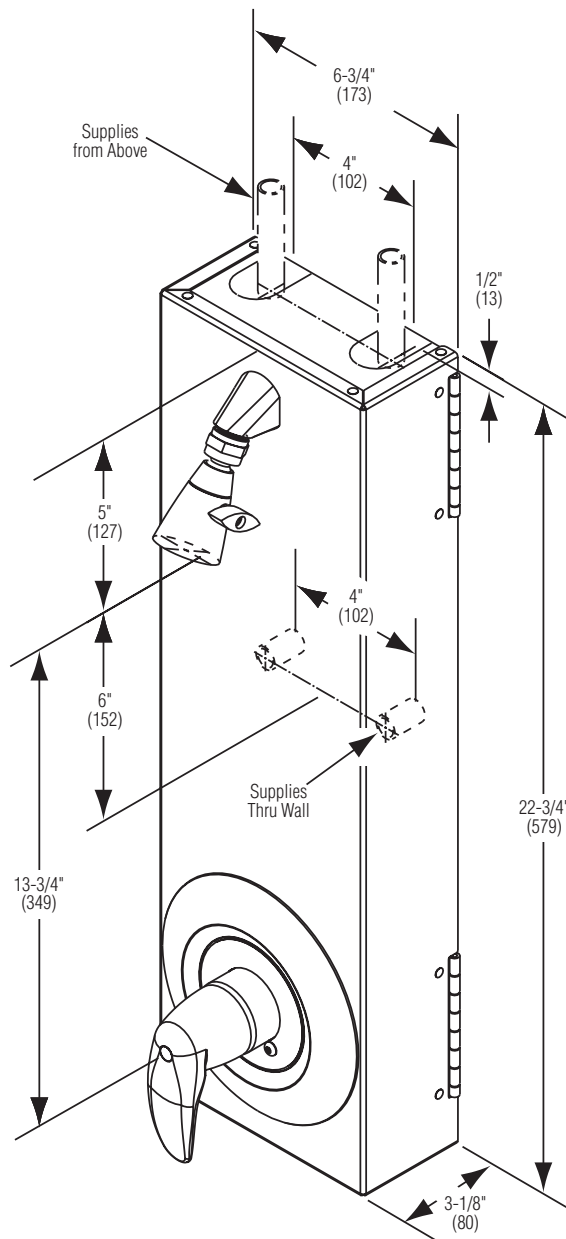

Equa-Flo Valve shown. Valve location and rough-ins same for other valves.