

Commercial 3 Element Energy Saver Electric Water Heater



Photo is of
E31-50S-3

The Electric Models Feature:



Bradford White is ISO registered to the 9001-9004 standard.

- **Fully Automatic Controls**—Fast acting surface-mount thermostat for automatic temperature control. Factory installed sensitive manual reset energy cut-off for safety to prevent overheating (Maximum thermostat setting is 185°F (85°C)).
- **Direct Heat Transfer With Three Immersed Incoloy Elements**—Transfers heat directly and efficiently to the water. Screw-in style element.
- **Factory Installed Hydrojet[®] Total Performance System**—Cold water inlet sediment reduction device helps minimize sediment build up in tank. Increases first hour delivery of hot water while minimizing temperature build up at top of tank.
- **Vitraglas[®] Lining**—Bradford White water heater tanks are protected from the corrosive effects of hot water by an exclusive ceramic porcelain-like coating. The Bradford White high silica Vitraglas[®] lining provides a tough interior surface for our hot water tanks.
- **1" (25mm) Non-CFC Foam Insulation**—Covers the side and top of tank, reducing the amount of heat loss. This results in less energy consumption, improved operation efficiencies and jacket rigidity (Except E32-80R and E32-120R has 2" (51mm)).
- **Factory Installed Dielectric Waterway Fittings**—All heaters, equipped with special water heater nipples for longer life.
- **Protective Magnesium Anode Rod**—Provides added protection against corrosion for long trouble-free service.
- **T&P Relief Valve**—Factory installed.
- **Brass Drain Valve.**

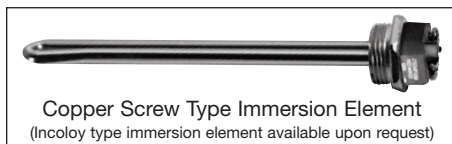

3-Year Limited Tank Warranties / 1-Year Limited Warranty on Component Parts.

For more information on warranty, please visit www.bradfordwhite.com

For products installed in USA, Canada and Puerto Rico. Some states do not allow limitations on warranties. See complete copy of the warranty included with the heater.

Commercial Electric Water Heater

Commercial Energy Saver Models

Meet or exceed ASHRAE 90.1b (current standard) C.E.C. Listed

Model Number	Capacity		A Floor to Heater Top in.	B Jacket Dia. in.	C Floor to Water Conn. in.	D Floor to T&P Conn. in.	Approx. Shipping Weight lbs.
	U.S. Gal.	Imp. Gal.					
E31-50L-3	47	39	32 ⁷ / ₈	24	33 ⁷ / ₈	34	143
E31-50S-3	50	42	47	20	48	48 ³ / ₁₆	142
E31-65R-3	65	54	59 ³ / ₄	20	60 ³ / ₄	60 ⁷ / ₈	146
E32-80R-3	80	67	59 ³ / ₄	22	60 ³ / ₄	60 ⁷ / ₈	174
E32-120R-3	119	99	63	28 ¹ / ₄	64	64 ¹ / ₈	300

Model Number	Capacity		A Floor to Heater Top mm.	B Jacket Dia. mm.	C Floor to Water Conn. mm.	D Floor to T&P Conn. mm.	Approx. Shipping Weight kg.
	Liters						
E31-50L-3	178		834	610	860	863	65
E31-50S-3	189		1195	508	1221	1224	65
E31-65R-3	246		1518	508	1543	1547	66
E32-80R-3	303		1518	559	1543	1547	79
E32-120R-3	450		1600	730	1626	1629	136

Specify kW, voltage and wiring phase when ordering.

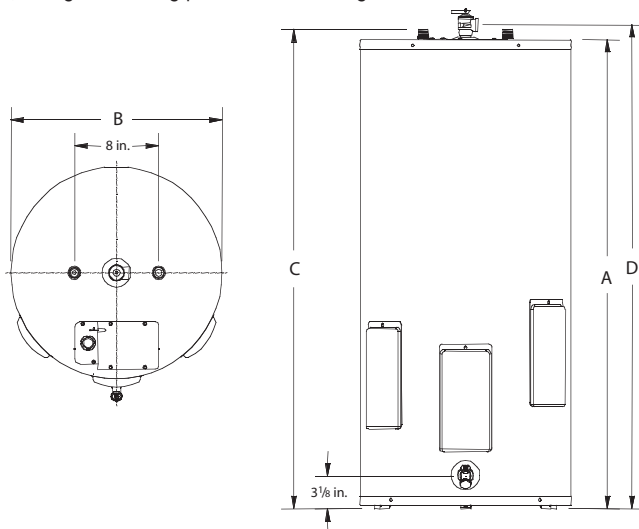

Input kW	Full Load Amperes - (Single Phase / Three Phase)					
	208V	240V	277V	380V	415V	480V
6	28.8/16.6	25/14.4	21.6	10	8.3	12.5/7.2
9	43.2/25	37.5/21.6	32.4	14	12.5	18.7/10.8
12	57.6/33.3	50/28.9	43.3	19	16.7	25/14.4
13.5	64.9/37.5	56.2/32.5	48.7	21	18.8	28.1/16.2
15	72.1/37.5	62.5/36.1	54.1	23	20.9	31.2/18
18	86.5/50	75/43.4	64	28	25	37.5/21.6

Standard Element Availability Chart

Watts	Voltage						
	120V	208V	240V	277V	380V	415V	480V
2000	yes	yes	yes	yes	yes	yes	yes
3000	yes	yes	yes	yes	yes	yes	yes
4000	no	yes	yes	no	yes	yes	yes
4500	no	yes	yes	yes	yes	yes	yes
5000	no	yes	yes	yes	yes	yes	yes
6000	no	yes	yes	yes	yes	yes	yes

Incoloy Element Availability Chart

Watts	Voltage						
	120V	208V	240V	277V	380V	415V	480V
2000	no	yes	yes	yes	yes	yes	yes
3000	no	yes	yes	yes	yes	yes	yes
4000	no	yes	yes	yes	yes	yes	yes
4500	no	yes	yes	yes	yes	yes	yes
5000	no	yes	yes	no	yes	yes	yes
6000	no	yes	yes	yes	yes	yes	yes

Sample Specification

Water heater shall be a Bradford White model with a rated storage capacity of not less than _____ gallons/liters, a minimum kW input of _____, and a minimum recovery of _____ GPH/LPH at 100°F (56°C) temperature rise. It shall be designed certified either with or without a separate storage tank. The tank shall be lined with Vitraglas® vitreous enamel. The tank should consist of three screw type elements with a combined maximum input of 18 kW. The tank shall have one magnesium anode rod. The heater shall be insulated with not less than 1" (25.4mm) of Non-CFC foam. This water heater shall be equipped with an ASME rated T&P relief valve. The entire installation shall be made in compliance with state and local codes and ordinances.

General

All water connections, 1½" (32mm) NPT. All electrical connections, ¾" (19mm). All models certified at 300 psi test pressure (2068 kPa), 150 psi working pressure (1034 kPa).

Dimensions and specifications subject to change without notice in accordance with our policy of continuous product improvement.



For U.S. and Canada field service, contact your professional installer or local Bradford White sales representative.

Sales 800-523-2931 • Fax 215-641-1670 / Technical Support 800-334-3393 • Fax 269-795-1089 • Warranty 800-531-2111 • Fax 269-795-1089

International: Telephone 215-641-9400 • Telefax 215-641-9750 / www.bradfordwhite.com

BRADFORD WHITE-CANADA INC. Sales / Technical Support 866-690-0961 / 905-238-0100 • Fax 905-238-0105 / www.bradfordwhite.com

Built to be the Best™

©2010, Bradford White Corporation. All rights reserved.