

**BROCTON  
68" CAST IRON  
ROLL TOP TUB**

Cat. No.  
CTR67



L: 68"  
W: 30 1/2"  
H: 23 1/4" (from floor to top of tub)  
18 5/8" (from bottom of tub to top of tub)

**The following is recommended for CTR67 tubs with faucet holes:**

- Tub wall-mounted faucets or hand-held showers: part# **4022, 4025, 4035**
- Tub wall-mounted faucets for use with risers: part# **4001, 4013, 4023, 4030, 0431**
- Double offset bath supplies: part **#5576**
- Leg tub drain: part **#5599**
- Complete shower unit: part# **4124, 4143**

Gallon Capacity: 57  
Shipping Weight: 502 lbs.  
Empty Weight: 309 lbs.  
Filled Weight: 785 lbs.

**Features:**

- ▶ Inside finish is white enamel
- ▶ Ball and claw feet available in 6 finishes or unfinished
- ▶ Tub exterior is white (epoxy)
- ▶ 3 3/8" centers in tub wall
- ▶ Non-skid strips
- ▶ Feet are attached and leveled before shipment
- ▶ Tub is thoroughly inspected before shipment

**Foot Finishes:**

**BP** Polished Brass  
**CP** Polished Chrome  
**PN** Polished Nickel  
**SN** Brushed Nickel  
**WH** White  
**ORB** Oil-rubbed Bronze

Meets or exceeds the following specifications: A112-19-1M 1994.

**Extra Paint Charge** (inside of tub is always white enamel):

**Bisque Paint** - \$160

**Black Paint** - \$160

Bathtubs painted in bisque or black are considered "special order" and are not returnable.

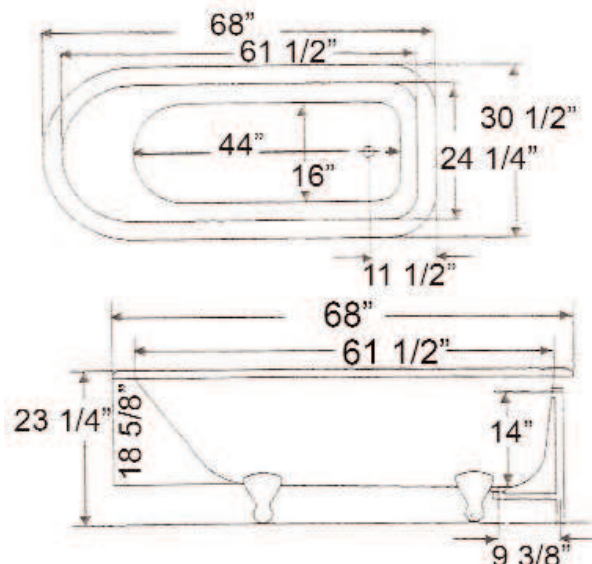

Dimensions of fixture are nominal and may vary within the range of tolerances established by ANSI Standard A112.19.2. Dimensions and specifications subject to change without notice.