

PRODUCT SHEET

ELEGANCIA 6642

66" X 42" X 21"



THERMOMASSEUR® BATH	\$
THERMASENS™ BATH	\$
SOAKER BATH	\$

THERMOMASSEUR (TMU)	
Jets	38
1 heated backrest	included
MiaPlus® Control	included
Geysair™	\$
AromaCloud™	\$
Chromatherapy - LED	\$

THERMASENS (TMSU)	
AromaCloud™	included
Chromatherapy - LED	included
WarmTouchShell™	included
2 DOT controls (standard location)	included
2nd WarmTouchShell	\$

FEATURES INCLUDED			
Installation type	Drop-in & Alcove (3 walls) for C12		
No. of bathers		Armrests	4
US gallons	53	Grab bars (color match)	2
Imp. gallons	44		

SKIRTS (WITH C12)	MULTIFIT	ELEGANCE	SJ-1
Skirts	\$	\$	\$
Optional colors	\$	\$	\$

OPTIONAL UPCHARGE APPLICABLE

COLORS	
Standards	
	White
	Bone
	Biscuit
	Almond
Optionals	
	Black
	Mexican sand
	Cashmere
	Sandbar
	Gray
	\$

CONTROL (TMU ONLY)	
MiaMulti®	\$

GRAB BARS	CHROME & BRASS	BRUSHED & POLISHED NICKEL
G11 Metallic	\$	\$
Clear acrylic (With Chrome, Brass or Brushed nickel inserts)	\$	

DRAIN & OVERFLOW	D14* (ELEGANCIA)	D13 (BALNEO®)
Chrome	\$	\$
White, Biscuit & Bone	\$	N/A
Brass	\$	\$
Brushed nickel & Polished nickel	\$	\$
Unplated & Oil-rubbed bronze	N/A	\$

TILE FLANGE (FOR C12 CONTOUR)	
Ordered with bath, uninstalled	\$
Factory-installed	\$

DON'T FORGET TO SELECT A CONTOUR AMONG THE 5 AVAILABLE TO CHOOSE FROM. AND IF YOU ORDER THE METALLIC GRAB BARS, PLEASE SPECIFY THE FINISH. * PIPING IS NOT INCLUDED FOR THIS MODEL (D14).

1 800 463.2187 info@bainultra.com

From 8 a.m. to 8 p.m. Monday to Thursday (EST)
From 8 a.m. to 5 p.m. on Friday (EST)

BainUltra®
The quest for your wellness™
www.bainultra.com

ELEGANCIA 6642 66" X 42" X 21"

ACCESSORIES (OPTIONAL)

CUTTING TEMPLATE

90000043 (C11, C13 & C14)

OTHER

- Optional tile flange for C12 contour
(specify front or back).

TOTAL PRICE

\$

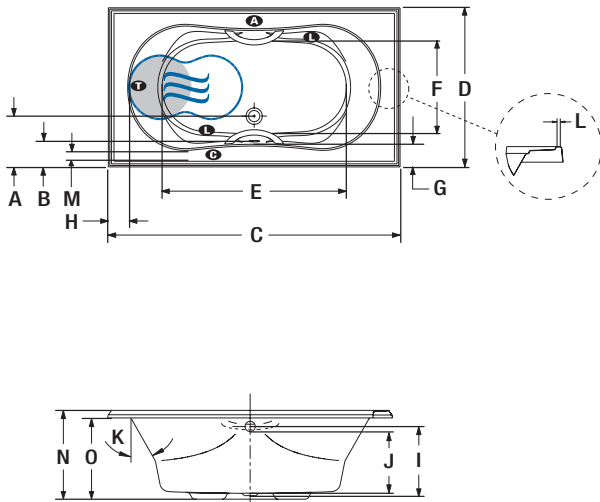

LETTER	DESCRIPTION	MEASURE
A	Outside edge to center drain	12 1/2"
B	Outside edge to overflow	6 1/2"
C	Total length	66"
D	Total width	42"
E	Bathing well length	41 3/4"
F	Bathing well width	25 3/8"
G	Deck width at backrest end (widest point)	6 1/8"
H	Deck width at backrest end	4 3/4"
I	Height from drain to center of overflow	16"
J	Maximum water level	14 3/8"
K	Slope of backrest	30°
L	Flat contour width (narrowest point) C12 ONLY	0 5/8"

- Indicates turbine position (TMU)
- Indicates LED light position
- Indicates heated backrest (TMU)
- Indicates control position when factory-installed
- Indicates WarmTouchShell position (TMSU)
- Indicates AromaCloud position

When tiling flange is added, the AromaCloud will automatically be installed on the opposite side of the flange.

CHOOSE YOUR CONTOUR

LETTER	DESCRIPTION	C10	C11	C12	C13	C14
M	Deck width (narrowest point)	2 7/8"	3 1/4"	2 1/4"	2 5/8"	2 3/4"
N	Height from bottom of tub to top deck	20 3/4"	20 5/8"	21"	20 5/8"	20 3/4"
O	Height from bottom of tub to bottom of lip	18"	17 1/8"	19"	18 5/8"	18"



TECHNICAL SPECIFICATIONS

Hot water supply required	Should be 70% of water capacity of tub or greater.
Turbine	Access to the pump must be at least 18" X 22". Standard connection is 15 A. 120 V, 60 hz, dedicated line with a Ground-Fault Circuit Interrupter (GFCI). With Geysair, upgrade to 20 A. 120 V, 60 hz, dedicated line GFCI is needed. For any additional option with the Geysair, a second line is needed 15 A. 120 V, 60 hz, dedicated line with a GFCI. Air vent necessary: 2" X 4" minimum.

Our products must be installed by certified professionals only and according to our Owner's Manual as well as federal, provincial/state and local building codes and regulations (www.bainultra.com/documentations).

Approx. shipping weight	140 lbs
Turbine power	755 W
Air heater	700 W

WARRANTY

Controls-LED-Geysair*	5 years
Bath & turbine*	20 years

*Some restrictions apply | www.bainultra.com/warranty

The specifications shown indicate the outer edge dimension and the inside bathing capacity dimension measured at air jets' height. The manufacturer accepts a 1/4" [0.64 cm] variance. There are variations on each product and specifications are subject to change as we improve upon our product as required. The dimensions needed for site preparation and structure building will differ. BainUltra® assumes no responsibility for preparatory work done prior to the product being on site.

