

## AR2321-D9

### Premium 16 Gauge 304 Stainless Steel Single Bowl Undermount Sink



**Model: AR2321-D9**

#### Dimensions

- Overall Size: 23 1/2" x 21"
- Bowl Size: 21-1/2" x 19" x 9" D
- Drain Opening: 3 1/2"

#### Optional Accessories

- Single Grid: BG21S
- Sink Strainer

#### Features

- Heavy 16 gauge 304 stainless steel
- Proprietary V-Therm Shield™
  - Provides superior sound deadening and thermal retention.
- High luster brush satin finish
- Stain and corrosion resistant

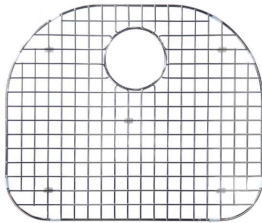

**BG21S GRID**  
Optional



**Sink Strainer**  
Optional



Complies with ASME A112.19.3-2000

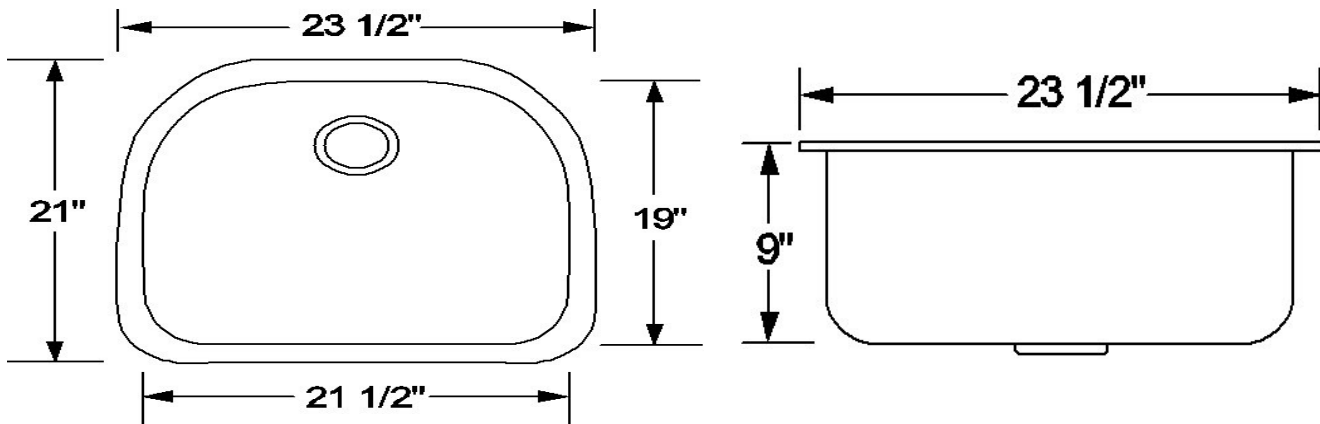

#### Product Specification

The undermount sink shall be 23 1/2" in length and 21" in width. Sink shall be made of 16 gauge stainless steel. Sink shall have brushed finished rim. Sink shall be a single bowl. Sink shall be an Artisan model AR2321-D9.