



Backflow Protected Automatic Draining Freezeless Wall Faucet Model 27 / 27CC

For Non-Freeze
Areas ONLY

The Model 27 faucet drains as handle is shut off even if hose is attached. This faucet is designed for residential outside water service applications.

The Model 27CC is designed for use in non-freeze areas and fits within 2" X 4" stud wall. The 27CC is available with C Inlet only.

SPECIFICATIONS:

HOSE CONNECTION BACKFLOW PREVENTER –

- NIDEL Model 37HA with 3/4 inch male hose thread
- ASSE Standard 1052 approved
- IAPMO listed
- Field Testable
- Two check valves
- No spray-back with pressurized hose

EXTERIOR FINISH - Brass

VALVE – Molded nitrile suitable for hot water.

NO LEAD SOLDER - All solder joints.

PLUNGER – Hemispherical cushion type.

STEM SCREW – DELRIN

HEAD NUT – Brass

HANDLE – Metal. (Optional tee Key)

INLETS – As shown.

MAX PRESSURE – 125 p.s.i.

MAX TEMPERATURE - 120 F

NOTICE - To close and drain, turn handle clockwise until seated and water drains out of drain hole or faucet may freeze and burst. Backflow Preventer replacement is recommended every 3-5 years.

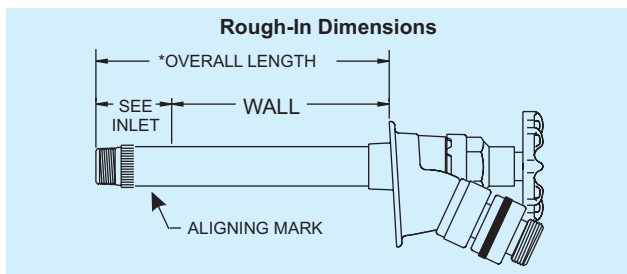

Model 27																			
Wall Thickness CC	4	6	8	10	12	14	16	18	20	22	24								
Shipping Wt.	22	22	23	24	25	26	27	29	31	33	35	37							

Approx. Shipping Weight (lbs.) per master carton of ten faucets.

*Overall Length Dimension: Add wall thickness and inlet option length shown in chart at the right. Overall length for 27CC is 2 3/4".



INLET DESCRIPTIONS

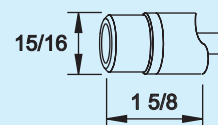

C Inlet
COMBINATION
Copper Sweat Fitting
1/2" K, L or M Inside
3/4" M Only Outside

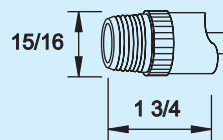

CP Inlet
COMBINATION
1/2" Male Pipe Thread
1/2" Female Sweat

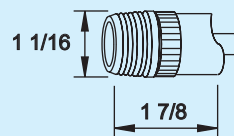

CP3 Inlet
COMBINATION
3/4" Male Pipe Thread
3/4" Female Sweat

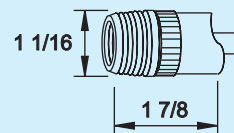

P Inlet
COMBINATION
1/2" Female Pipe Thread
3/4" Male Pipe Thread

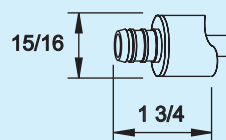

PX Inlet
1/2" PEX Tube Fitting

When ordering, specify model number, inlet, and wall thickness.

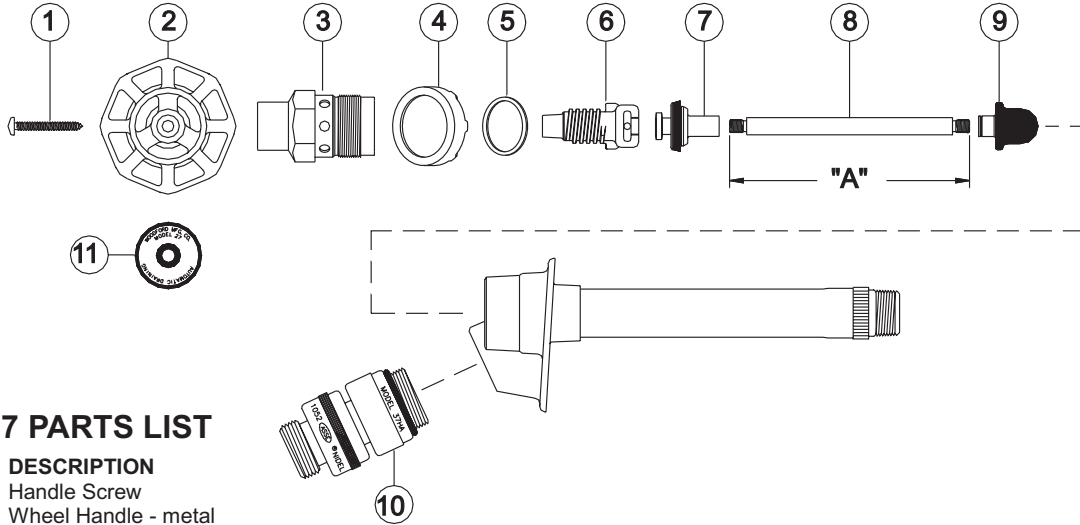

WOODFORD

MODEL 27 PARTS LIST

ITEM	PART #	DESCRIPTION
1	30234	Handle Screw
2	30239	Wheel Handle - metal
3	30241	Head Nut - brass
4	30236	Drain Guard
5	30245	Head Nut Gasket
6	30238	Stem Screw
7	35280	Drain Valve Assembly
8	303XX	Operating Rod (See chart below)
9	30230	Plunger Assembly
10	55056	37HA Backflow Preventer - brass
11	30439	Model 27 I.D. Ring

RK-25 Repair Kit (Includes Items 1-7 & 9)

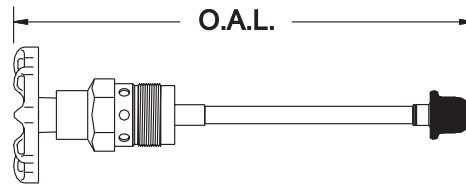

OPERATING ROD DIM. "A"		
Wall Thickness	Length	Part No.
CC	1 7/16"	30301
4	4 7/16"	30304
6	6 7/16"	30306
8	8 7/16"	30308
10	10 7/16"	30310
12	12 7/16"	30312
14	14 7/16"	30314
16	16 7/16"	30316
18	18 7/16"	30318
20	20 7/16"	30320
22	22 7/16"	30322
24	24 7/16"	30324

OPERATING ROD ASSEMBLY INCLUDES ITEMS 1 THRU 9		
Wall Thickness	O.A.L.	Part No.
CC	5"	35501
4	8"	35504
6	10"	35506
8	12"	35508
10	14"	35510
12	16"	35512
14	18"	35514
16	20"	35516
18	22"	35518
20	24"	35520
22	26"	35522
24	28"	35524

Manufactured under one or more of the following patents: U.S. Patents: 3,414,001; 4,178,956; 4,316,481; 4,532,954
D216,790; D216,791; D277,365; D277,366; Canada Patents: 852,529; 865,995; 1,146,438

For more information contact...

WOODFORD MANUFACTURING COMPANY

2121 Waynoka Road, Colorado Springs, Colorado 80915 Phone: (719) 574-1101 Fax: (719) 574-7621

To view our complete product line visit: www.woodfordmfg.com