



**T&S BRASS AND BRONZE WORKS, INC.**

2 Saddleback Cove / P.O. Box 1088  
 Travelers Rest, SC 29690



REG. #A2601  
 ISO #9001

Model No.

**B-0674-POL**

Item No.

Travelers Rest, SC: 800-476-4103 • Simi Valley, CA: 800-423-0150 • Fax: 864-834-3518 • www.tsbrass.com

ITEM NO.	SALES NO.	DESCRIPTION
1	002712-40	Eterna Cartridge - RTC
2	002711-40	Eterna Cartridge - LTC
3	B-0969	1/2" NPT Vacuum Breaker
4	002534-25	Close Nipple, 1/2"
5	00AA	1/2" NPT Coupling Flange
6	001019-45	Coupling Nut Washer
7	001638-45	Lever Handle
8	001660-45	Blue Index-CW
9	001661-45	Red Index-HW
10	000922-45	Lever Handle Screw
11	000270-40	Polished Chrome Spout w/ Garden Hose Outlet
37	000270-40	Polished Chrome Spout w/ Garden Hose Outlet

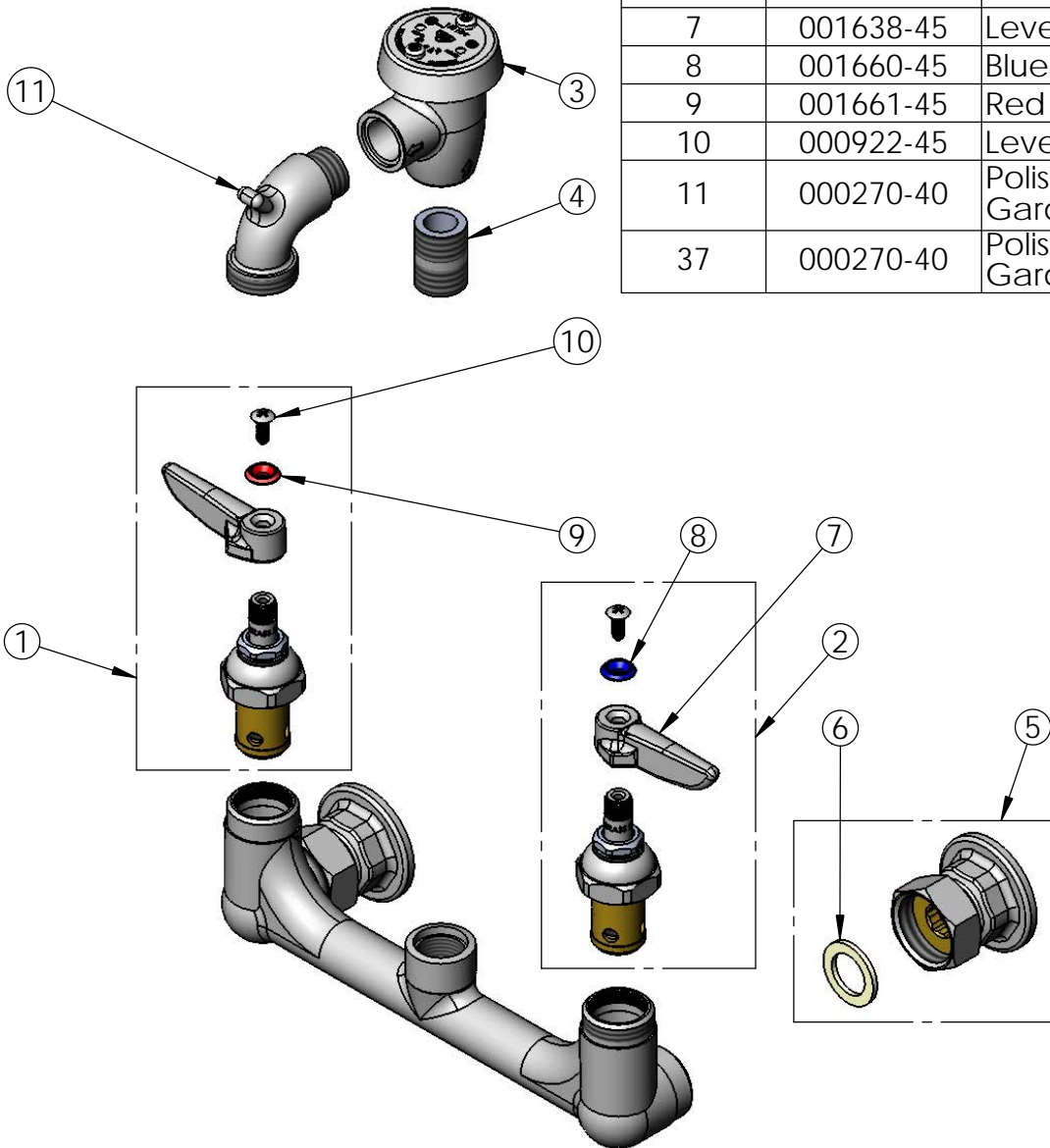

Product Specifications:  
 Polished Chrome Service Sink, Eterna Cartridges  
 w/ Spring Checks, Lever Handles

Drawn <b>DHL</b>	Checked <b>KJG</b>	Approved <b>JHB</b>
Scale: <b>NTS</b>		Date: <b>09/22/11</b>