



# T&S BRASS AND BRONZE WORKS, INC.

2 Saddleback Cove / P.O. Box 1088  
Travelers Rest, SC 29690



REG. #A2601  
ISO #9001

Model No.  
**B-0662**

Item No.

Travelers Rest, SC: 800-476-4103 Simi Valley, CA: 800-423-0150 Fax: 864-834-3518 www.tsbrass.com

ITEM NO.	SALES NO.	DESCRIPTION
1	B-0969	Vacuum Breaker, 1/2"
2	001661-45	Red Index-HW
3	012443-40	Hot Eterna Spindle Assembly w/ Spring Check
4	001660-45	Blue Index-CW
5	002712-40	Hot Eterna Spindle Assembly w/ Spring Check, Handle, Index & Screw
6	000922-45	Lever Handle Screw
7	001605-45	Cap
8	001638-45	Lever Handle
9	002892-40	Spindle Asm w/ Cap
10	000763-20	Seat
11	012442-40	Cold Eterna Spindle Assembly w/ Spring Check
12	002711-40	Cold Eterna Spindle Assembly w/ Spring Check, Handle, Index & Screw
13	B-0110	Bracket Asm., 6" Wall
14	00JJ	Flange w/ Integral Stop Asm, 1/2" NPT Female Inlet
15	001019-45	Coupling Nut Washer
16	002534-25	Close Nipple, 1/2" x 1 5/32" Rough Chrome

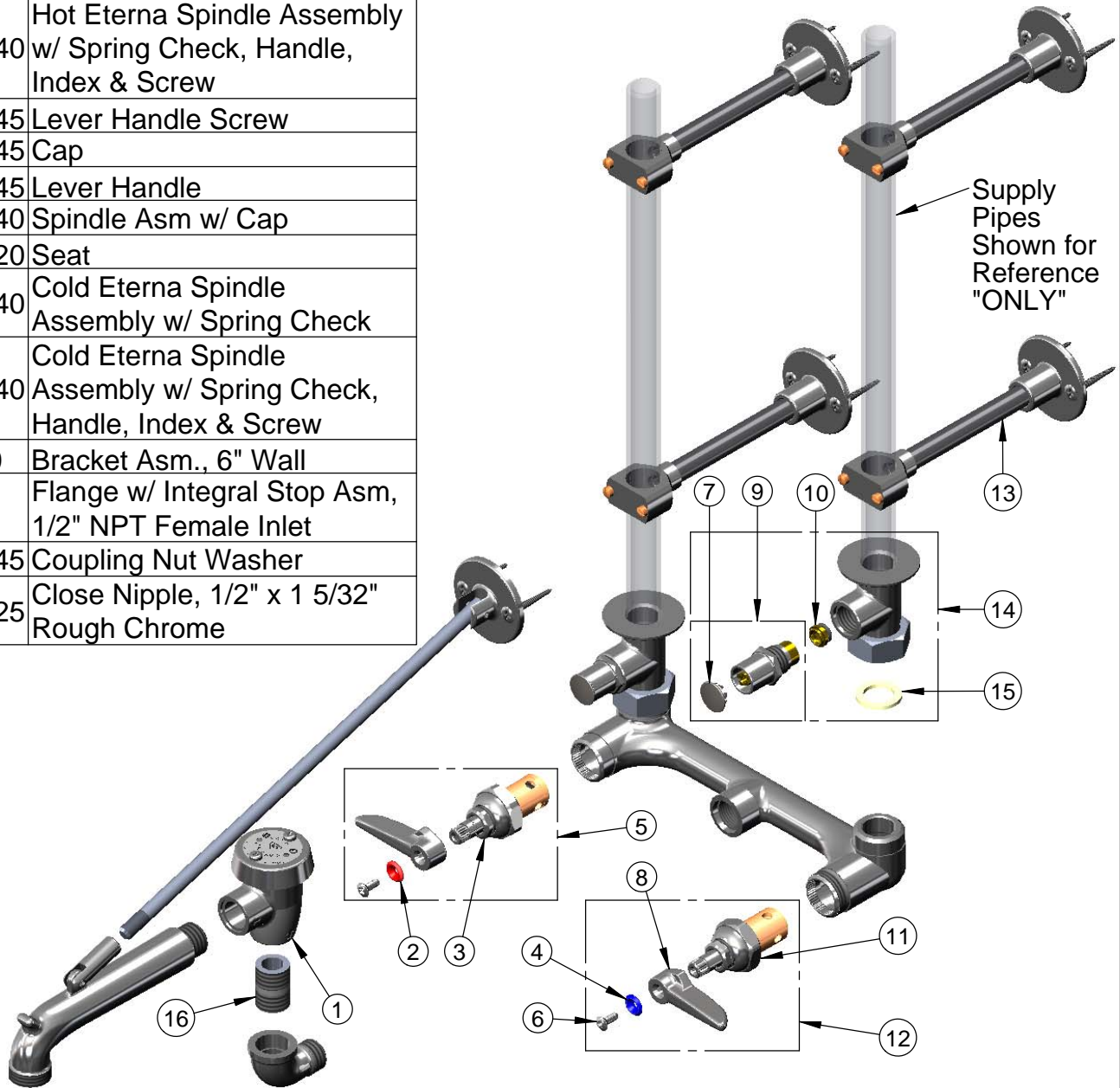

**Product Specifications:**

Service Sink Faucet, Polished Chrome Finish, Integral Stops w/ 1/2" NPT Female Inlets, Vacuum Breaker & Wall Brace Assembly, (Designed for Exposed Ceiling Supply Lines)

Drawn <b>DHL</b>	Checked <b>GEF</b>	Approved <b>JHB</b>
Scale: <b>1:4</b>		Date: <b>9/11/2009</b>