

# B-2867, B-2867-04

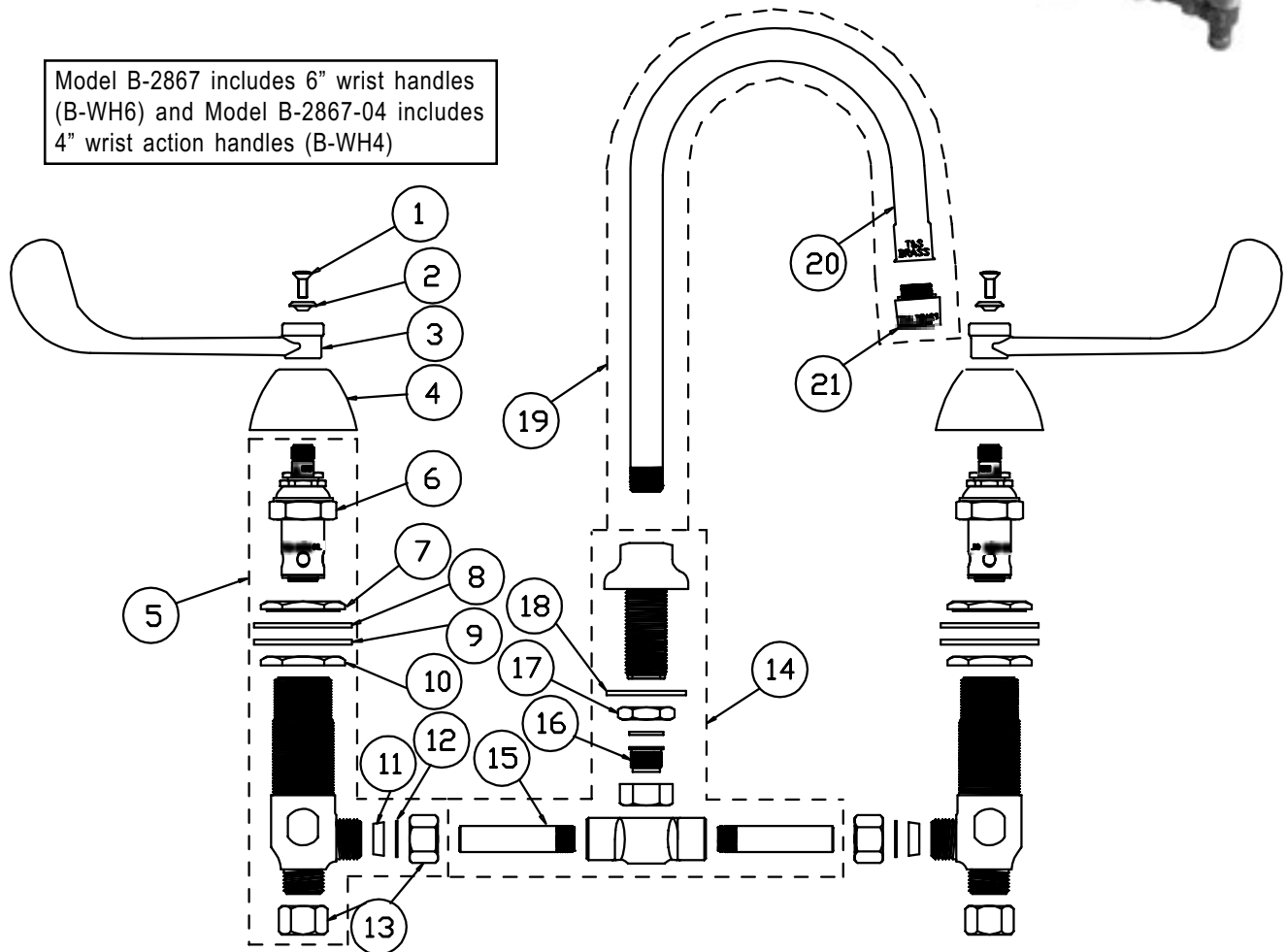

Model B-2867 includes 6" wrist handles (B-WH6) and Model B-2867-04 includes 4" wrist action handles (B-WH4)



## Medical Commercial Faucet Assembly

1	Screw, Handle	000922-45	10	Locknut, Body Bottom	000960-20
2	Index, Button, Blue/Cold	001660-45	11	Washer, Yoke	001091-45
	Index, Button, Red/Hot	001661-45	12	Washer	000981-45
3	Handle, Wrist Action, 6" (B-2867)	B-WH6	13	Nut, Coupling	000958-20
	Handle, Wrist Action, 4" (B-2867-04)	B-WH4	14	Asm, Center Body	006217-40
4	Escutcheon	001257-40	15	Nipple	000342-20
5	Asm, Body - Cold	161A	16	Insert	003700-45
	Asm, Body - Hot	162A	17	Locknut	002954-45
6	Asm, Spindle Eterna - LH/Cold	006477-40	18	Washer	000999-45
	Asm, Spindle Eterna - RH/Hot	006478-40	19	Asm, Rigid Gooseneck	120X
7	Locknut, Body Top	000959-20	20	Gooseneck	000398-40
8	Washer, Body	002290-45	21	Aerator	B-0199-02
9	Washer, Nipple	001006-45			

