

NOTES:

1. PLUMBER REQUIRED TO APPLY TEFLON TAPE.

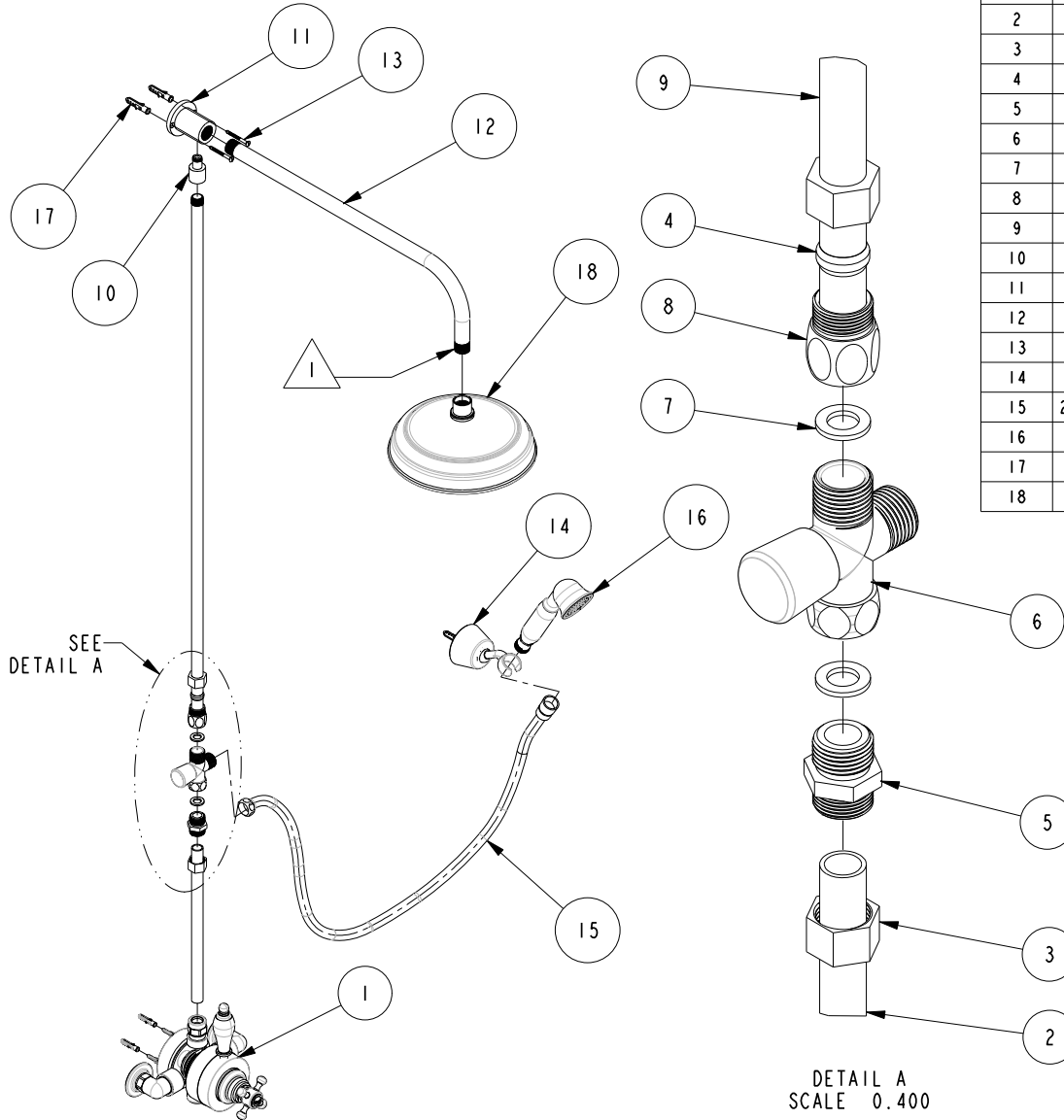

BILL OF MATERIAL (CURRENT LEVEL)

| ITEM | PT/ASSY | DESCRIPTION | TYPE | QTY. |
|------|-------------|------------------------------|----------|------|
| 1 | 3-203 | EXPOSED THERMO VALVE ASM | ASSEMBLY | 1 |
| 2 | 10976 | LOWER RISER TUBE - 10.0" | PART | 1 |
| 3 | 50678 | COMP NUT 1/2" Cu PIPE | PART | 2 |
| 4 | 50362 | COMPRESSION RING | PART | 2 |
| 5 | 10979 | ADAPTER 1/2" MPS X 5/8" COMP | PART | 1 |
| 6 | 286 | DIVERTER VALVE FOR SHOWER | ASSEMBLY | 1 |
| 7 | 91153 | WSHR .438 X .738 | PART | 1 |
| 8 | 10978 | ADAPTER 1/2" FPS X 5/8" COMP | PART | 1 |
| 9 | 10977 | UPPER RISER TUBE - 34.5" | PART | 1 |
| 10 | 10861 | ELBOW ADAPTER | PART | 1 |
| 11 | 10860 | WALL ELBOW | PART | 1 |
| 12 | 2021 | 90° 1/8" SHWR ARM | PART | 1 |
| 13 | 92051 | SCREW #8 X 1-3/4 | PART | 2 |
| 14 | 287 | COMPL. BRACKET - HANDSHOWER | ASSEMBLY | 1 |
| 15 | 284.FIG1017 | 59" HOSE | PART | 1 |
| 16 | 281 | HANDSHOWER ASM | ASSEMBLY | 1 |
| 17 | 91369 | WALL ANCHOR PLASTIC | PART | 2 |
| 18 | 2091 | 8" SHOWERHEAD | ASSEMBLY | 1 |

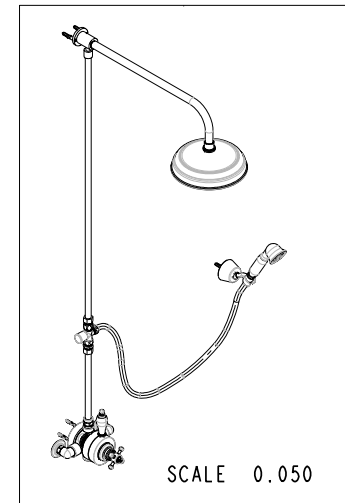

COPYRIGHT 2005 BRASSTECH, INC. THESE DRAWINGS AND THE DESIGNS DEPICTED HEREIN ARE THE PROPRIETARY PROPERTY OF BRASSTECH. ANY USE OR REPRODUCTION IS SUBJECT TO THE EXPRESS APPROVAL OF BRASSTECH. UNAUTHORIZED USE IS STRICTLY PROHIBITED. ALL RIGHTS RESERVED.

BRASSTECH
INCORPORATED
2001 E. CARNEGIE AVE.
SANTA ANA, CA 92705
(949) 417-5207

SHOWER SET-EXPOSED

ASSY. NO. 1016

SCALE 0.100

REF. -

SHEET 1 OF 2

| | | |
|-----|----------|----------|
| D | EN-1551 | 05/06/10 |
| C | EO-0671 | 05/09/06 |
| B | EO-0372 | 06/09/04 |
| A | EO-0318 | 02/13/04 |
| - | RELEASED | 11/04/03 |
| REV | REV DESC | DATE |