

# TA VALVE PARTS

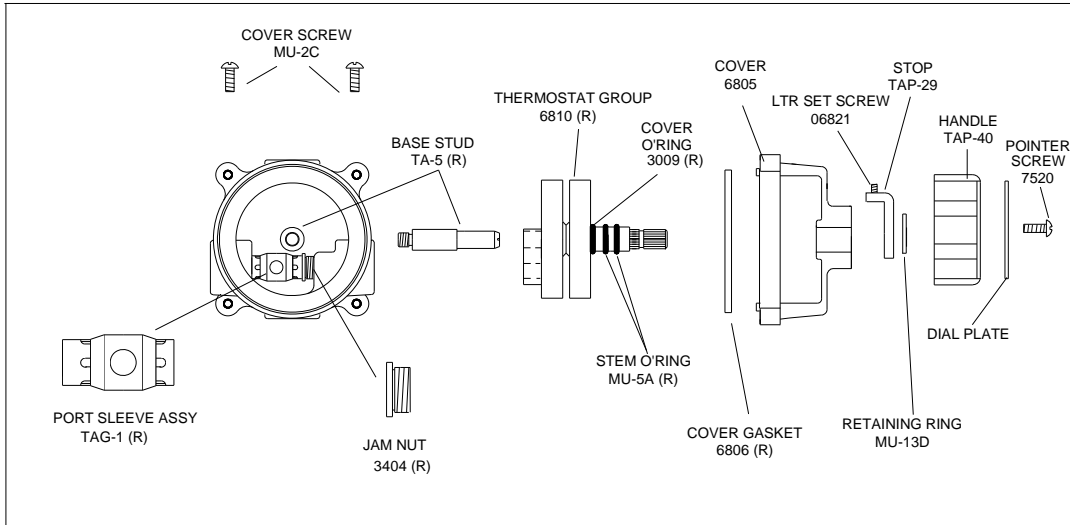

(R) KIT R/TA/N

## CHECKSTOP PARTS

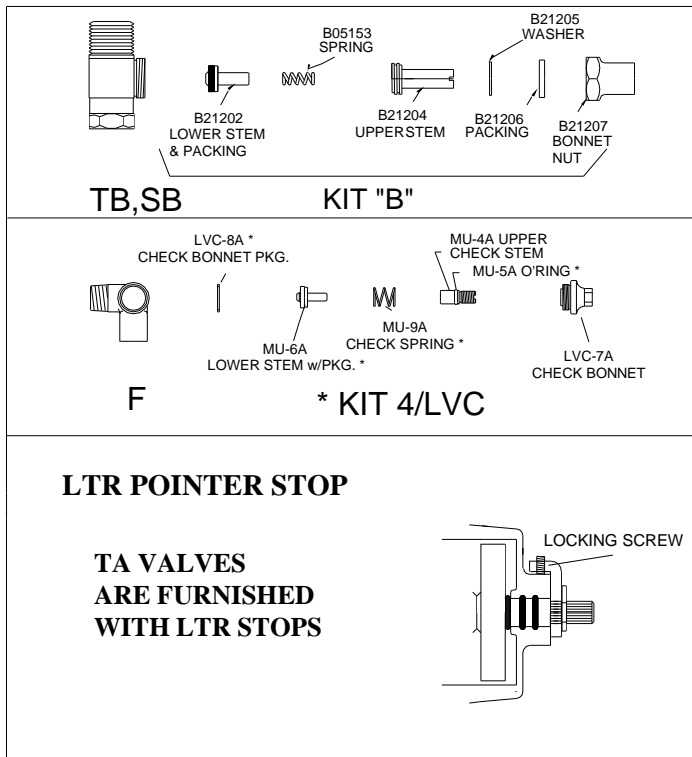

## REPAIR KIT

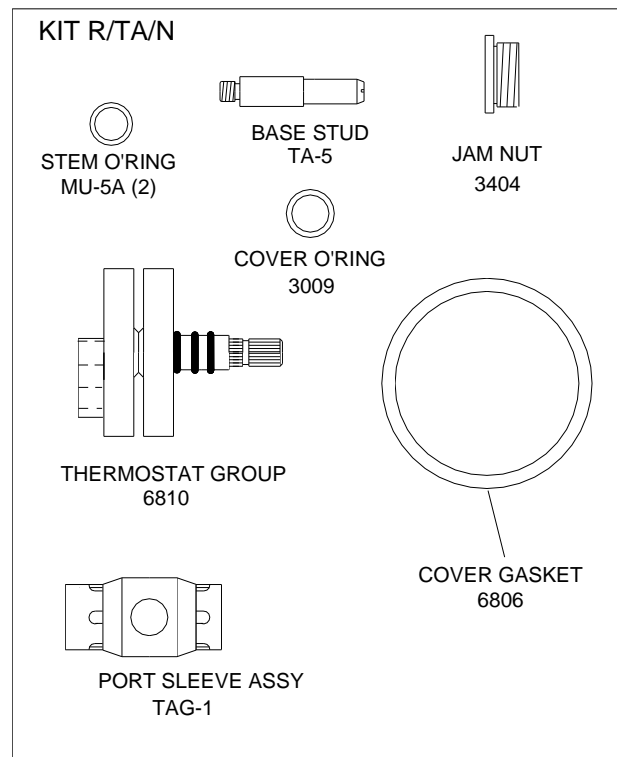

**REMEMBER!** THIS IS A CONTROL DEVICE WHICH MUST BE CLEANED AND MAINTAINED ON A REGULAR BASIS (SEE MAINTENANCE GUIDE AND RECORD, MGR-1000).

**NOTE:** AFTER INSTALLING NEW PARTS IT WILL BE NECESSARY TO RESET THE ADJUSTABLE HIGH TEMPERATURE LIMIT STOP (SEE PAGE 3).

# MODEL TA FLOW CAPACITIES

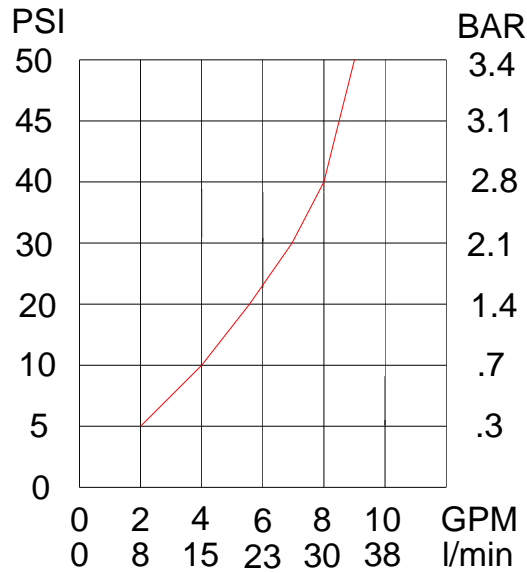

**CAUTION!** All thermostatic water mixing valves have limitations. They will not provide the desired accuracy outside their flow capacity range. Consult the capacity chart and **DO NOT OVERSIZE**. Flow must not be greater or less than as shown below.

MODEL	IN	OUT	MINIMUM FLOW (GPM)	PRESSURE DROP							PSI
				5	10	20	30	40	45	50	
TA	1/2"	1/2"	0.5	2.0	4	5.5	7	8	8.5	9.0	GPM
			1.9	7.6	15	21	26	30	32	34	L\MIN

## LIMITED WARRANTY

Leonard Valve Company (hereinafter, "Leonard") warrants the original purchaser that products manufactured by Leonard will be free from defects in material or workmanship under normal conditions of use, when properly installed and maintained in accordance with Leonard's instructions, for a period of one year from the date of shipment. During this period, Leonard will at its option repair or replace any product, or part thereof, which shall be returned, freight prepaid, to the Leonard factory and determined by Leonard to be defective in materials or workmanship. Leonard provides no warranty, express or implied, which extends beyond the description contained herein. LEONARD SPECIFICALLY DISCLAIMS ANY AND ALL IMPLIED WARRANTIES OF MERCHANTABILITY OR OF FITNESS FOR A PARTICULAR PURPOSE. Nonetheless, some jurisdictions may not allow the disclaimer of certain implied warranties, in which case Leonard hereby limits such implied warranties to the duration of the limited warranty period contained herein. Some jurisdictions may not allow limitations on how long an implied warranty lasts, so the foregoing durational limitation may not apply to you. In no event will Leonard be liable for labor or incidental or consequential damages. Any alteration or improper installation or use of this product will void this limited warranty. If any provision of this limited warranty is prohibited by law in the applicable jurisdiction, such provision shall be null and void, but the remainder of this limited warranty shall continue in full force and effect.



1360 Elmwood Avenue, Cranston RI 02910 USA  
 Phone : 401-461-1200, Fax: 401-941-5310  
 Email: [info@leonardvalve.com](mailto:info@leonardvalve.com)  
 Web Site: <http://www.leonardvalve.com>