

# BRONZE GLOBE VALVE

I.P.S.



**MODEL T-421**

**LEGEND MODEL T-421** bronze globe valves have a screwed bonnet, rising stem, integral seat and swivel disc for accurate throttling and flow control. The body and bonnet are constructed of heavy duty bronze. Recommended for heavy industrial use when the valve is to be operated frequently

MATERIAL SPECIFICATION	
PART	MATERIAL
BODY	BRONZE
BONNET	BRONZE
STEM	FORGED BRASS
PACKING NUT	BRASS
DISC	BRASS
HAND WHEEL	ALUMINUM
WHEEL NUT	BRASS
GLAND	BRASS
GLAND PACKING	GRAPHITE/TEFLON*

**PRESSURE RATING**  
200 W.O.G. NON-SHOCK  
125 W.S.P.

\*DUPONT REG T.M.

DIMENSIONS IN INCHES			
VALVE SIZE	A (I.P.S.)	B	C
1/2"	1.96	2.81	1.97
3/4"	2.18	3.27	2.21
1"	2.56	3.90	2.36
1 1/4"	2.92	4.30	3.23
1 1/2"	3.29	4.94	3.34
2"	3.90	5.95	3.94

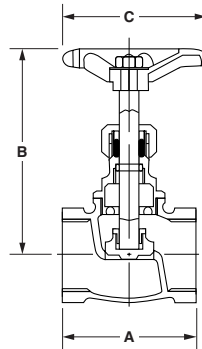

# BRASS SWING CHECK VALVE

I.P.S. AND CxX

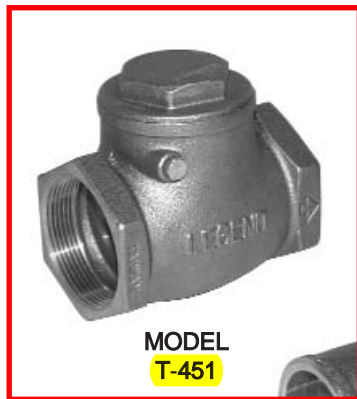

**MODEL T-451**

**MODEL S-451**

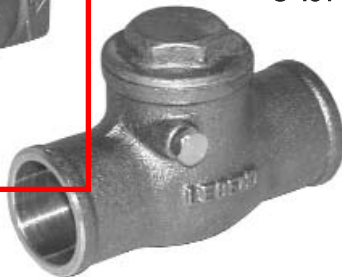

**LEGEND MODELS T-451/S-451** check valves are constructed of heavy duty brass. They have a screwed cap, swing type disc and integral seat. They prevent backflow while offering full flow performance with a minimum of turbulence or pressure loss. Recommended for residential and commercial applications.

MATERIAL SPECIFICATION	
PART	MATERIAL
CAP	BRASS
BODY	BRASS
DISC	BRASS
HINGE PIN	BRASS
SCREW	BRASS

**PRESSURE RATING**  
200 W.O.G. NON-SHOCK

DIMENSIONS IN INCHES			
VALVE SIZE	A (I.P.S.)	A (CxX)	B
3/8"	2.01		1.40
1/2"	2.01	2.44	1.34
3/4"	2.29	3.03	1.42
1"	2.48	3.74	1.54
1 1/4"	3.15	4.37	1.89
1 1/2"	3.47	5.12	2.17
2"	3.98	5.95	2.56
2 1/2"	5.16	6.90	2.96
3"	5.79	7.60	3.82
4"	6.86		3.94

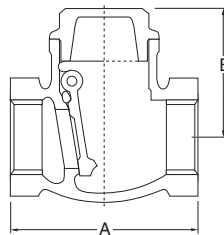

## SUBMITTAL SHEET

JOB NAME \_\_\_\_\_ ITEM TAG \_\_\_\_\_

JOB LOCATION \_\_\_\_\_ PART NUMBER \_\_\_\_\_

CONTRACTOR \_\_\_\_\_ DATE \_\_\_\_\_

ENGINEER APPROVAL \_\_\_\_\_ DATE \_\_\_\_\_

# LEAD FREE BRASS SWING CHECK VALVE

## T/S-451 No Lead

Durable, full-pattern cast brass body.  
Large, integral seat and disc sealing surfaces.  
Forged brass hinge pin assures smooth, non-binding disc operation.  
T-pattern body permits either vertical (upward flow only) or horizontal (assembly cap upright) installations.

**Working Pressure, Non-Shock (PSI)**  
Cold Water, Oil, Gas: 200 CWP  
Saturated Steam: Not suitable for steam service

- Complies with California and Vermont lead-free requirements, as certified by the Water Quality Association
- Threaded end connections comply with ANSI/ASME B1.20.1
- Sweat end connections comply with ANSI/ASME B16.18
- Manufactured in an ISO accredited facility



MATERIAL SPECIFICATION		
PART	MATERIAL	SPECIFICATION
1 Body	Lead free cast brass	UNS alloy C87850
2 Disc	Lead free Forged brass	UNS alloy C69300
3 Hinge pin	Forged brass	ASTM B16 UNS C36000
4 Pin retaining screw	Forged brass	ASTM B16 UNS C36000
5 Assembly cap	Lead free cast brass	UNS alloy C87850

DIMENSIONS				
Size	A (NPT)	A (CxC)	B (NPT)	B (CxC)
1/4"	2.11	—	1.52	—
3/8"	1.99	—	1.50	—
1/2"	2.07	1.61	1.50	1.50
3/4"	2.34	3.21	1.59	1.59
1"	2.58	3.54	1.69	1.69
1-1/4"	3.15	4.06	1.85	1.85
1-1/2"	3.48	4.49	2.17	2.17
2"	4.19	5.37	2.72	2.72
2-1/2"	5.16	6.88	2.95	2.95
3"	5.79	7.63	3.82	3.82
4"	6.85	—	3.94	—

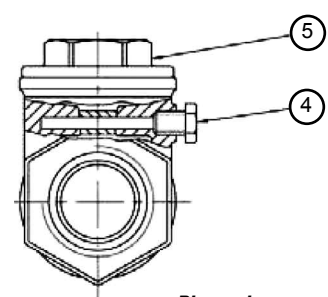
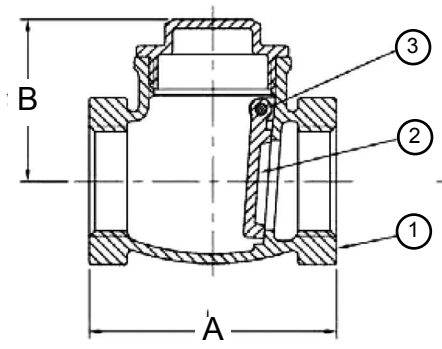

**Pictured**  
**T-451 No Lead**  
Cut-away view

## SUBMITTAL SHEET

JOB NAME	ITEM TAG
JOB LOCATION	PART NUMBER
CONTRACTOR	DATE
ENGINEER APPROVAL	DATE

# BRASS SWING CHECK VALVE

## T/S-451

Durable, full-pattern cast brass body.

Large, integral seat and disc sealing surfaces.

Forged brass hinge pin assures smooth, non-binding disc operation.

T-pattern body permits either vertical (upward flow only) or horizontal (assembly cap upright) installations.

1/2-P.S.I. cracking pressure. Less than 1 P.S.I. back-pressure required to facilitate the closure seal.

### Working Pressure, Non-Shock (PSI)

Cold Water, Oil, Gas: 200 CWP

Saturated Steam: Not suitable for steam service

- Threaded end connections comply with ANSI/ASME B1.20.1
- Sweat end connections comply with ANSI/ASME B16.18
- Manufactured in an ISO accredited facility



### MATERIAL SPECIFICATION

PART	MATERIAL	SPECIFICATION
1 Body	Cast brass	ASTM B584 UNS C85700
2 Disc	Forged brass	ASTM B124 UNS C37700
3 Hinge pin	Forged brass	ASTM B16 UNS C36000
4 Pin retaining screw	Forged brass	ASTM B16 UNS C36000
5 Assembly cap	Cast brass	ASTM B584 UNS C85700

### DIMENSIONS

Size	A (NPT)	A (CxC)	B (NPT)	B (CxC)
1/4"	2.11	—	1.52	—
3/8"	1.99	—	1.50	—
1/2"	2.07	1.61	1.50	1.50
3/4"	2.34	3.21	1.59	1.59
1"	2.58	3.54	1.69	1.69
1-1/4"	3.15	4.06	1.85	1.85
1-1/2"	3.48	4.49	2.17	2.17
2"	4.19	5.37	2.72	2.72
2-1/2"	5.16	6.88	2.95	2.95
3"	5.79	7.63	3.82	3.82
4"	6.85	—	3.94	—

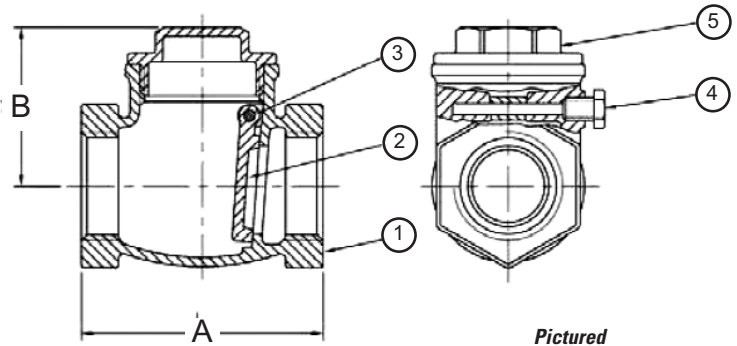

**Pictured  
T-451  
Cut-away**