

BRASS GATE VALVES

I.P.S. AND CxC

ISO-9002

**MODEL
T-401**

**MODEL
S-401**



LEGEND MODELS T-401/S-401 gate valves are constructed of heavy duty cast brass. Body and bonnet are connected with a tight metal to metal leakproof seat. The T401/S-401 have a screwed bonnet, non-rising stem, solid wedge disc, and integral seats. Recommended for non-steam use in residential and commercial applications. May be repacked while in service under pressure.

The T-401/S-401 is the finest valve in its class on the market.

MATERIAL SPECIFICATION	
PART	MATERIAL
BODY	BRASS
BONNET	BRASS
STEM	BRASS
PACKING NUT	BRASS
DISC	BRASS
HAND WHEEL	CAST IRON
WHEEL NUT	BRASS
LOCK NUT	BRASS
GLAND	BRASS
PACKING	ASBESTOS FREE GRAPHITE

PRESSURE RATING
200 W.O.G.
NON-SHOCK to 200 F

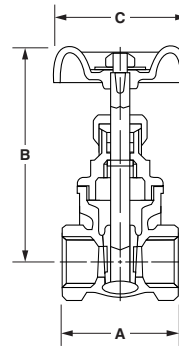
DIMENSIONS IN INCHES



VALVE SIZE	A (I.P.S.)	A (CxC)	B	C
1/4"	1.62		3.27	2.13
3/8"	1.62		3.29	2.13
1/2"	1.69	1.77	3.52	2.13
3/4"	1.85	2.33	4.02	2.13
1"	2.13	2.76	4.57	2.40
1 1/4"	2.40	2.88	5.38	2.96
1 1/2"	2.44	3.19	6.03	2.96
2"	2.84	3.90	7.50	3.19
2 1/2"	3.51	4.53	9.25	4.14
3"	3.98	5.18	10.75	4.45
4"	4.57		12.60	5.20

BRASS GATE VALVES

 COMPACT PATTERN
I.P.S. AND CxC

ISO-9002

**MODEL
T-400**

**MODEL
S-400**

LEGEND MODELS T-400/S-400 gate valves are constructed of cast brass. Body and bonnet are connected with a tight metal to metal leakproof seat. They have a screwed bonnet, non-rising stem, solid wedge disc and integral seats. Recommended for non-steam use in residential and commercial applications. They are an excellent competitive alternative where port size is not critical.

MATERIAL SPECIFICATION	
PART	MATERIAL
BODY	BRASS
BONNET	BRASS
STEM	BRASS
PACKING NUT	BRASS
DISC	BRASS
HAND WHEEL	CAST IRON
WHEEL NUT	BRASS
LOCK NUT	BRASS
GLAND	BRASS
PACKING	ASBESTOS FREE GRAPHITE

PRESSURE RATING
200 W.O.G.
NON-SHOCK to 200 F

DIMENSIONS IN INCHES

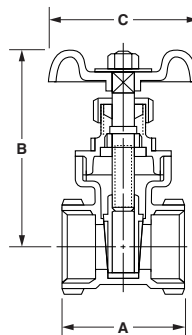

VALVE SIZE	A (I.P.S.)	A (CxC)	B	C
1/2"	1.54	1.62	2.72	2.13
3/4"	1.73	2.13	2.92	2.13
1"	1.85	2.48	3.31	2.13
1 1/4"	2.09	2.64	3.86	2.40
1 1/2"	2.25	2.96	4.57	2.96
2"	2.40	3.51	4.93	2.96
2 1/2"	2.80		6.03	3.19
3"	3.43		7.33	4.14
4"	3.96		8.67	4.41

SUBMITTAL SHEET

JOB NAME	ITEM TAG
JOB LOCATION	PART NUMBER
CONTRACTOR	DATE
ENGINEER APPROVAL	DATE

LEAD FREE BRASS NON-RISING STEM GATE VALVE T/S-401 NO-LEAD

Lead-free design is suitable for all California and Vermont potable water installations

Durable, all-brass body construction

Full-flow waterway reduces pressure drop

Non-rising stem design is compact and reliable

Solid, fully-guided disc-wedge opens completely out of the flow path

Integral seats are precision-ground to match each disc-wedge

Working Pressure, Non-Shock (PSI)

Cold Water, Oil, Gas: 200 CWP

Saturated Steam: Not suitable for steam service

- Complies with California and Vermont no-lead requirements: IAPMO file number 6372
- UPC/IAPMO certified to ANSI/NSF Standard 61 Annex G
- End connections comply with ANSI/ASME B1.20.1 and ASME B16.18
- Manufactured in an ISO accredited facility



MATERIAL SPECIFICATION			
PART	MATERIAL	SPECIFICATION	
1 Handwheel nut	Cadmium plated steel	AISI 1010	
2 Identification disc	Aluminum	ASTM B209-1100	
3 Handwheel	Cast iron	ASTM A48 Class 35	
4 Stem	Lead-free forged brass	Lead-free bismuth/boride alloy	
5 Packing nut	Brass	ASTM B16 UNS C36000	
6 Packing gland follower (sizes 1-1/4" to 2" only)	Brass	ASTM B16 UNS C36000	
7 Stem packing	NBR (Buna-N) rubber	Commercial grade: N81U	
8 Bonnet	Lead-free cast brass	Lead-free bismuth/boride alloy	
9 Stem locknut	Lead-free forged brass	Lead-free bismuth/boride alloy	
10 Disc wedge	Lead-free cast brass	Lead-free bismuth/boride alloy	
11 Body	Lead-free cast brass	Lead-free bismuth/boride alloy	

DIMENSIONS							
Size	A (IPS)	A (Swt)	B	C	D	Wt (lb.) IPS	Wt (lb.) Swt
1/4"	1.61		2.76	2.13	0.39	0.6	
3/8"	1.61		2.76	2.13	0.39	0.56	
1/2"	1.69	1.77	2.84	2.13	0.50	0.62	0.58
3/4"	1.85	2.32	3.31	2.13	0.75	0.82	0.76
1"	2.13	2.76	3.86	2.40	0.95	1.24	1.17
1-1/4"	2.40	2.87	4.57	3.03	1.25	1.84	1.67
1-1/2"	2.56	3.27	4.92	3.03	1.48	2.21	2.06
2"	2.84	3.90	6.02	3.27	1.94	3.22	3.52

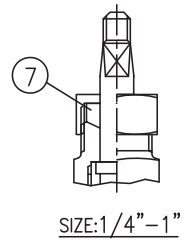
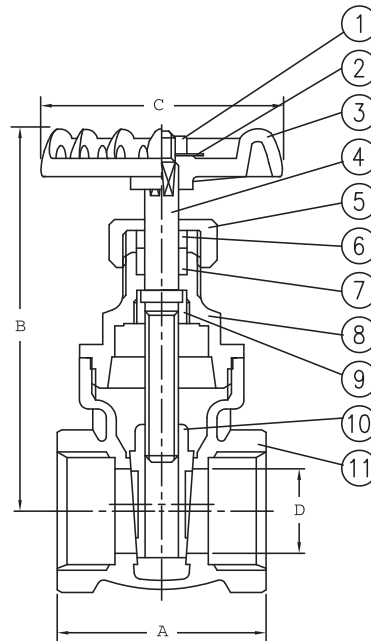

Pictured
T-401 No Lead
Cut away view

SUBMITTAL SHEET

JOB NAME	ITEM TAG
JOB LOCATION	PART NUMBER
CONTRACTOR	DATE
ENGINEER APPROVAL	DATE

BRASS NON-RISING STEM GATE VALVE

TS-401

Ideal for residential or commercial potable water applications
 Durable, all-brass body construction and heavy cast iron handwheel
 Electric-induction furnace casting process optimizes molten brass temperatures, resulting in superior cast body and bonnet components
 Inserted bonnet with large stem packing and forged packing nut
 Full-flow waterway reduces pressure drop, permitting consistent flow
 Non-rising stem design is compact and reliable
 Solid, fully-guided disc-wedge opens completely out of the flow path
 Integral seats are precision-ground to match each disc-wedge

- Truesdail Labs Certified to ANSI / NSF Standard 61-8
- End connections comply with ANSI / ASME B1.20.1 and ASME B16.18
- Manufactured in an ISO accredited facility



Working Pressure, Non Shock (PSI)

Cold working pressure (CWP): 200 psi
 Saturated steam (WSP): Not suitable for steam service

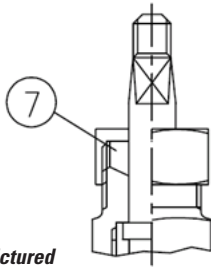

Pictured
1/4" to 1" stem packing detail
Cut-away

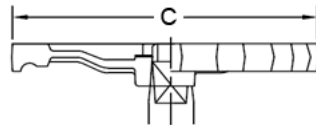

Pictured
4" T-401 handwheel
Cut-away

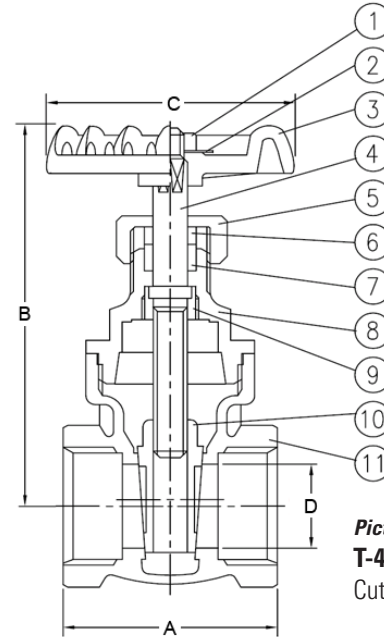

Pictured
T-401
Cut-away

MATERIAL SPECIFICATION

PART	MATERIAL	SPECIFICATION
1 Handwheel nut	Cadmium plated steel	AISI 1010
2 Identification disc	Aluminum	ASTM B209-1100
3 Handwheel	Cast iron	ASTM A48 Class 35
4 Stem	Brass, free-cutting	ASTM B16 UNS C36000
	Forged Brass <i>sizes 1-1/4" to 4" only</i>	ASTM B124 UNS C37700
5 Packing nut	Brass, free-cutting	ASTM B16 UNS C36000
	Cast Brass <i>sizes 1-1/4" to 4" only</i>	ASTM B584 UNS C85700
6 Packing gland follower <i>sizes 1-1/4" to 4" only</i>	Brass, free-cutting	ASTM B16 UNS C36000
7 Stem packing	NBR (Buna-N) rubber	Commercial grade: N81U
8 Bonnet	Cast Brass	ASTM B584 UNS C85700
9 Stem locknut	Brass, free-cutting	ASTM B16 UNS C36000
10 Disc wedge	Forged Brass	ASTM B124 UNS C37700
	Cast Brass <i>sizes 2-1/2" to 4" only</i>	ASTM B584 UNS C85700
11 Body	Cast Brass	ASTM B584 UNS C85700

DIMENSIONS

Size	A (IPS)	A (Swt)	B	C	D	Wt (lb.) IPS	Wt (lb.) Swt
1/4"	1.61	-	2.76	2.13	0.39	0.6	-
3/8"	1.61	-	2.76	2.13	0.39	0.56	-
1/2"	1.69	1.77	2.84	2.13	0.50	0.62	0.58
3/4"	1.85	2.32	3.31	2.13	0.75	0.82	0.76
1"	2.13	2.76	3.86	2.40	0.95	1.24	1.17
1-1/4"	2.40	2.87	4.57	3.03	1.25	1.84	1.67
1-1/2"	2.56	3.27	4.92	3.03	1.48	2.21	2.06
2"	2.84	3.90	6.02	3.27	1.94	3.22	3.52
2-1/2"	3.50	4.61	7.32	4.13	2.48	6.67	6.17
3"	3.98	5.20	8.74	5.12	2.95	9.92	9.48
4"	4.57	-	10.16	6.77	3.62	17.48	-