



59 __ -PLGHDF __ __

Write purchase model number here for future reference

208623

208623

208623

208623

208623

208623

208623

208623

063129A
HDF Spout Assembly
for Proximity

060638A
Vandal Resistant Laminar Outlet
with Antimicrobial by Agion®
1.5 GPM (5.7 L/min)

060640A
Vandal Resistant Flow Control
Aerator and Wrench
1.5 GPM (5.7 L/min)

060642A
Flow Control Aerator
1.5 GPM (5.7 L/min)

RP31704
Vandal Resistant
Spray Outlet with Wrench
0.5 GPM (1.9 L/min)

060566A
Optional Spray Outlet with
Wrench - Vandal Resistant
1.0 GPM (3.8 L/min)

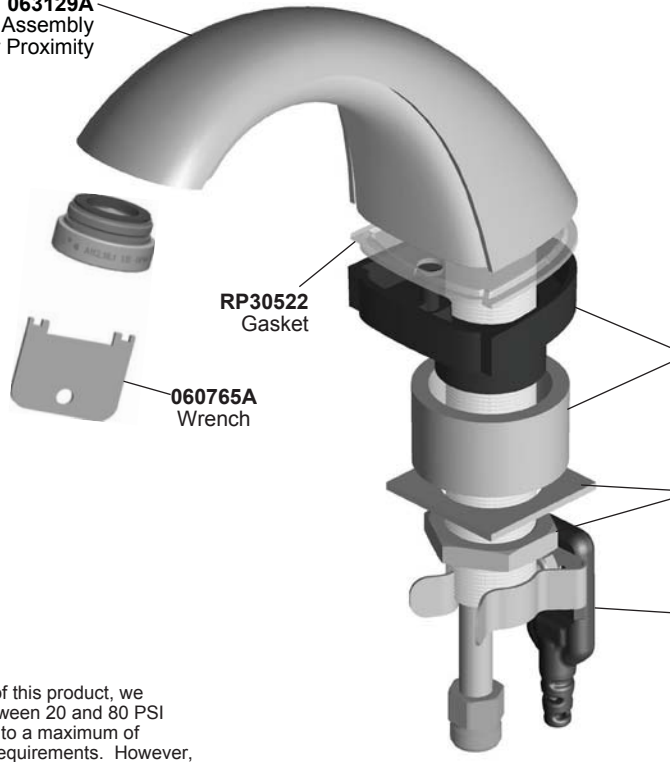

RP30522
Gasket

060765A
Wrench

061175A
Spacer package for
HDF Proximity

RP6087
Nut &
Washer

061206A
Proximity
Sensor
Module

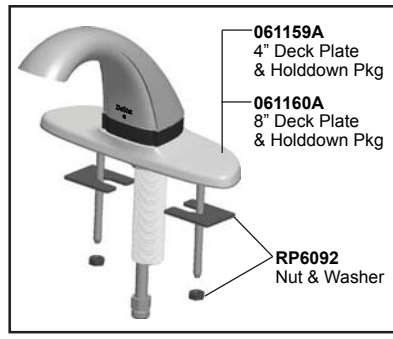

061159A
4" Deck Plate
& Holddown Pkg

061160A
8" Deck Plate
& Holddown Pkg

RP6092
Nut & Washer

NOTE: For optimum performance of this product, we recommend a system pressure between 20 and 80 PSI static. This product will operate up to a maximum of 125 PSI static per ANSI and CSA requirements. However, we do not recommend pressure above 80 PSI. Thermal expansion or leaking pressure reducing valves may require use of expansion tanks or relief valves to ensure your system never exceeds its maximum intended pressure setting.

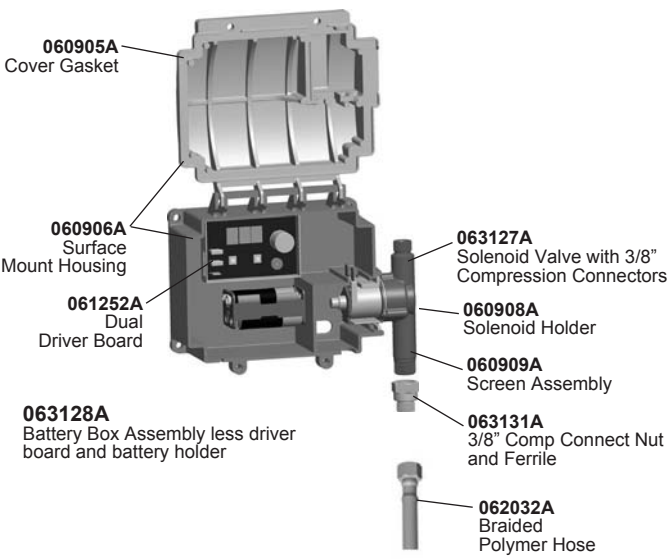

060905A
Cover Gasket

060906A
Surface
Mount Housing

061252A
Dual
Driver Board

063128A
Battery Box Assembly less driver
board and battery holder

063127A
Solenoid Valve with 3/8"
Compression Connectors

060908A
Solenoid Holder

060909A
Screen Assembly

063131A
3/8" Comp Connect Nut
and Ferrile

062032A
Braided
Polymer Hose

060683A
24VAC to 6VDC Converter

061259A
Ground Wire Kit (for hardwire models)

061047A
24VAC to 6VDC Converter with
Battery Backup

OPTION LIST	
	061255A Battery Holder - Square (4 "AA")
TRANSFORMERS	
	060704A Transformer 110 to 24 VAC 20VA up to 5 Electronic Valves
	060771A Transformer 110 to 24 VAC 40VA up to 10 Electronic Valves
	060772A Transformer 110 to 24 VAC 100VA up to 25 Electronic Valves
DECK PLATES	
	061159A 4" Deck Plate & Holddown Pkg.
	061160A 8" Deck Plate & Holddown Pkg.

PLEASE LEAVE this M&I Sheet with the owner, maintenance plumber, etc. as items relating to ongoing maintenance suggestions and procedures are included.