

23C \_ \_ \_ 23T \_ \_ \_

Write purchase model number here for future reference  
 Escriba el número del modelo comprado aquí para referencia futura  
 Pour référence future, inscrivez ci-dessus le N° de modèle du produit acheté

## WIDESPREAD LAVATORY FAUCET

#	PART #	DESCRIPTION	#	PART #	DESCRIPTION
1	060794A	5 Fluted Handle with Screw, Red and Blue Index	16	060726A	VR 0.5 GPM Flow Control & Wrench (Female)
2	060022A	Handle Screws and Index Kit (includes short and long handle screws, red and blue index washers)		060686A	Insert only (12/pkg) (0.5 USGPM / 1.9 L/min)
	060441A	No. 3 Scrulox Drive Bit	17	060765A	Wrench for VR Outlets
3	060543A	4" Hooded Blade Handle with Screw, Red and Blue Index and Alignment Insert (1 of each)	18	060026A	Gooseneck Spout Repair Kit (includes retaining rings, O-rings, swivel & rigid collars and spout nut)
	063121A	Retrofit Package - Two 4" Hooded Blade Handles with Screws, Red & Blue Index, 2 Alignment Inserts, 1 RH & 1 LH CER-TECK® Cartridge	19	063049A	Gooseneck Spout Adaptor and Flange
4	060544A	Alignment Insert (12/pkg)	20	060638A	VR Laminar Outlet and Wrench with Agion® Antimicrobial (Male) (1.5 USGPM / 5.7 L/min)
5	060599A	3" Hooded Lever Handle with Screw, Red and Blue Index and Alignment Insert (1 of each)		060688A	Antimicrobial Laminar Flow Insert only (1.5 USGPM / 5.7 L/min) (12/pkg)
	063107A	Retrofit Package - Two 3" Hooded Lever Handles with Screws, Red & Blue Index, 2 Alignment Inserts, 1 RH & 1 LH CER-TECK® Cartridge	21	060642A	Flow Control Aerator (Male) (1.5 USGPM / 5.7 L/min)
6	060602A	4" Blade Handle with Screw, Red & Blue Index & Alignment Insert (1 of each)	060689A	Insert only (1.5 USGPM / 5.7 L/min) (12/pkg)	
	063108A	Retrofit Package - Two 4" Blade Handles with Screws, Sani-Guards, Red and Blue Index, 2 Alignment Inserts, 1 RH & 1 LH CER-TECK® Cartridge	22	060640A	VR Flow Control Aerator & Wrench (Male) (1.5 USGPM / 5.7 L/min)
7a	060032A	Springs for Self-Close Handles (LH) (4/pkg)	060689A	Insert only (1.5 USGPM / 5.7 L/min) (12/pkg)	
7b	060033A	Springs for Self-Close Handles (RH) (4/pkg)	23	RP31704	VR 0.5 GPM Flow Control & Wrench (Male)
8	060037A	Sani-Guards (2/pkg)	060686A	Insert only (0.5 USGPM / 1.9 L/min) (12/pkg)	
9	063000A	(RH) Right-hand CER-TECK® Cartridge (23C only)	24	060444A	Locknut
	063001A	(LH) Left-hand CER-TECK® Cartridge (23C only)	25	060365A	O-Ring Kit (6 of each/pkg)
	063054A	CER-TECK® Retrofit Package (1 RH and 1 LH each) (also see #10) (23C only)	26	063024A	Tee Assembly (10.5" long) includes 2 each of Compression Sleeves and Coupling Nuts
9a	060553A	Structure "O" Ring Kit (24/pkg) (23C only)	27	063027A	Cast Spout Assembly with Pop-Up Hole
9b	060554A	CER-TECK® Bottom Seal (24/pkg) (23C only)	063028A	Cast Spout Assembly less Pop-Up Hole	
10	063057A	CER-TECK® Widespread Seat (6/pkg) (23C only)	28	063029A	Inline Centre Body Assembly (10.5" long)
11	060445A	Deck Flange	29	060446A	Fibre Washer Kit (12/pkg)
12	063087A	Gooseneck Spout Complete with Outlet End A = 4.5"	30	060865A	6" Wrist Handle with Screw, Red and Blue Index (1 of each)
	060878A	Gooseneck Spout Complete with Smooth End A = 4.5"	31	060947A	(Hot and Cold Handles) 3" Hooded Lever Temperature Indicator Handles with Screw, Red and Blue Index and Alignment Insert
	060318A	Inlet Flow Control Kit for inside base of Smooth End Spout (6/pkg)	32	060949A	(Hot and Cold Handles) 4" Hooded Blade Temperature Indicator Handles with Screw, Red and Blue Index and Alignment Insert
13	060637A	VR Laminar Outlet and Wrench with Agion® Antimicrobial (Female) (1.5 USGPM / 5.7 L/min)	33	060948A	(Hot and Cold Handles) 4" Blade Temperature Indicator Handles with Screw, Red and Blue Index and Alignment Insert
	060688A	Antimicrobial Laminar Flow Insert only (1.5 USGPM / 5.7 L/min) (12/pkg)	34a	063002A	Structure Repair Parts Kit (includes 12 seat washers, 2 seat washer screws, 24 stem O-rings, 6 capnut O-rings, 18 capnut fibre gaskets, 4 renewable seats) (23T only)
14	060641A	Flow Control Aerator (Female) (1.5 USGPM / 5.7 L/min)		063005A	RH CP Brass Tuf-Teck® Structure with Gasket and Renewable Seat (23T only)
	060689A	Insert only (1.5 USGPM / 5.7 L/min) (12/pkg)		063006A	LH CP Brass Tuf-Teck® Structure with Gasket and Renewable Seat (23T only)
15	060639A	VR Flow Control Aerator & Wrench (Female) (1.5 USGPM / 5.7 L/min)	34b	060139A	Seat Washer Package (6/pkg) (23T only)
	060689A	Insert only (1.5 USGPM / 5.7 L/min) (12/pkg)	35	063041A	Long Renewable Seat (23T only)

WIDESPREAD LAVATORY FAUCET  
 ROBINET DE GRANDE ÉTENDUE  
 CHORRO LAVATORIO/LAVAMANOS EXTENSIBLE

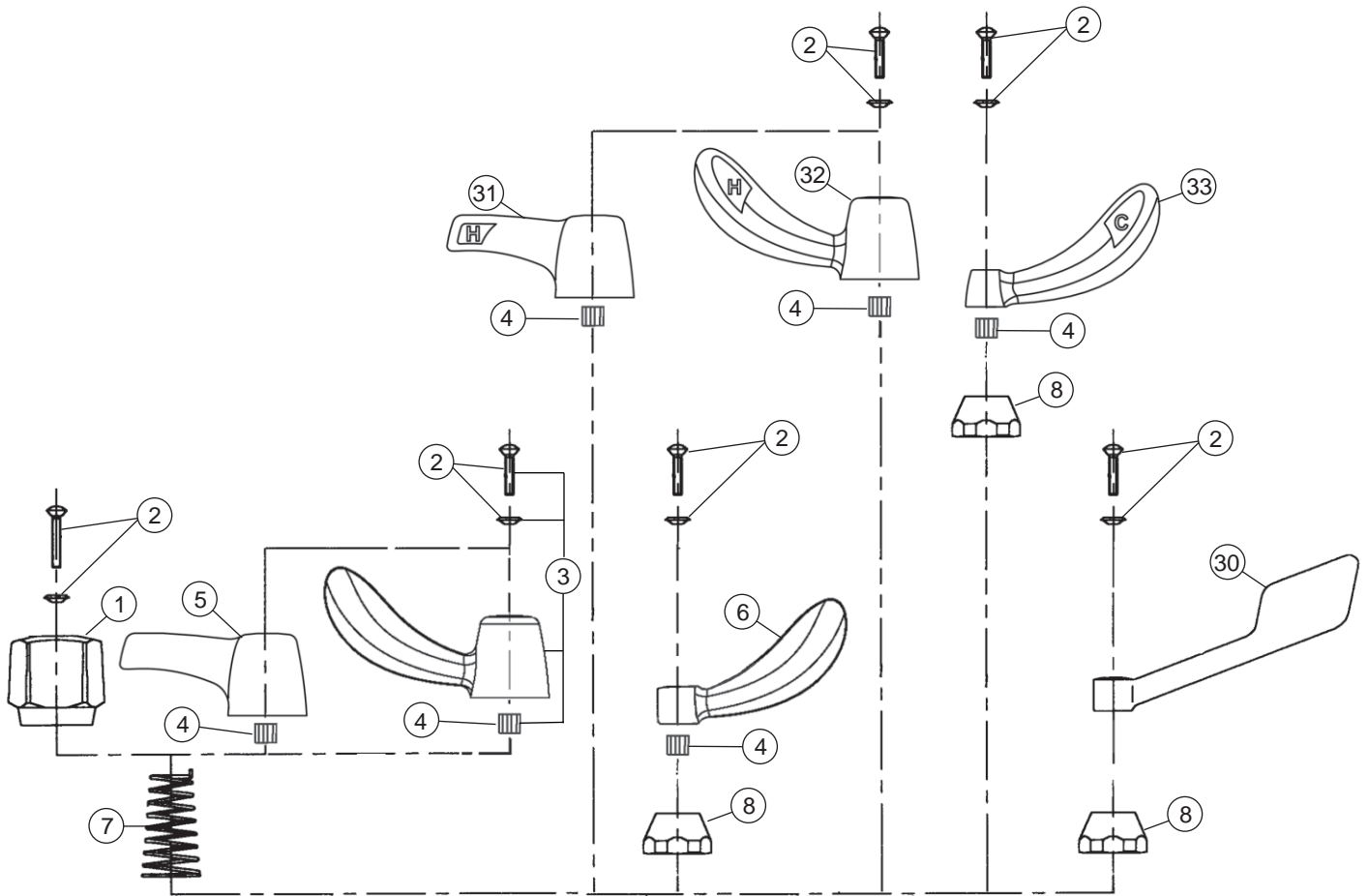

“C” Series

“T” Series

• Note: Alignment inserts are standard with handles where required.

• Remarque : Les inserts d'alignment sont offerts avec les manettes lorsque requis.

• Nota: Los insertos de alineación son estándar con manijas donde sean requeridas.

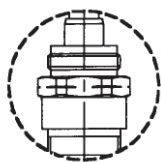

- Left Hand Identification Groove
- Rainure d'identification pour main gauche
- Ranura de identificación para la izquierda

