

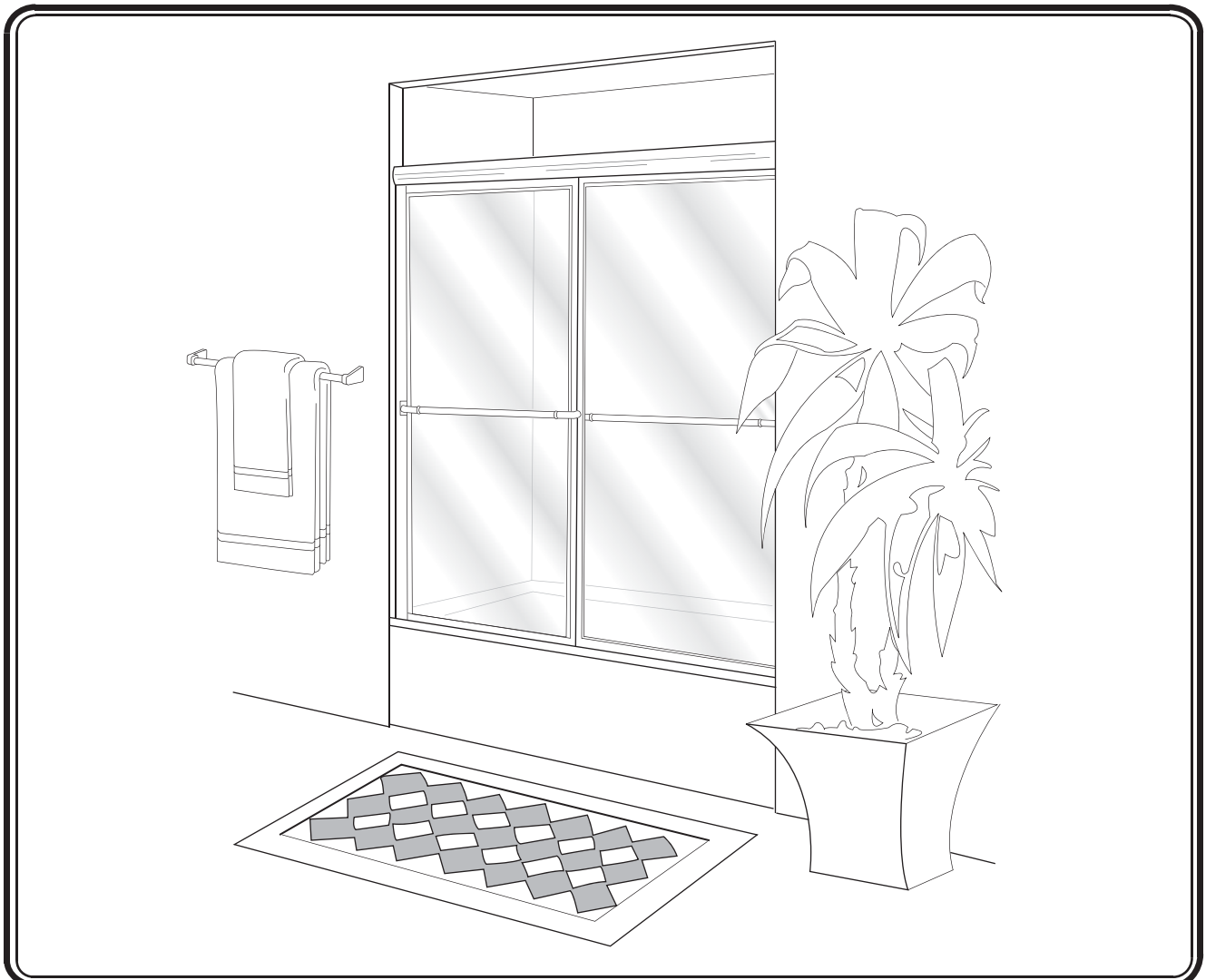

INSTALLATION INSTRUCTIONS

UNIT NO. 2150/3150 SUPREME BATH ENCLOSURE



MAINTENANCE: Two primary materials are used to manufacture your new Basco enclosure: tempered glass and anodized aluminum. To assure a long lasting finish on the enclosure, wipe it down with a towel after each use. Never use a scouring agent to clean the aluminum.

For occasional, more concentrated cleaning efforts, we find that Lysol *Bathroom Cleaner* works extremely well. Be sure that any over spray falling on the aluminum frame is rinsed thoroughly and dried. Many over-the-counter cleaners, if applied to the aluminum and left on, will harm the metal finish and cause permanent damage, even though their directions indicate safe use on shower doors.

INSTALLATION NOTES: Unpack your unit carefully and inspect for freight damage. Layout and identify all parts using the instruction sheets as a reference. Before discarding the carton, check to see that no small hardware parts have fallen to the bottom of the box. If any parts are damaged or missing, refer to the descriptions noted in the instructions when contacting your dealer for replacements.

Handle the glass panels carefully and protect the edges.

Please wear safety glasses whenever drilling or cutting. When drilling holes in the ceramic tile or marble, use a center punch and hammer to carefully break the surface glaze so the drill can start without skidding.

To install your BASCO Shower Door you will need the following: tape measure, level, #2 Phillips screwdriver, 3/16" wrench, drill, 1/8" and 3/16" drill bits, hacksaw, pencil, and caulking (clear silicone recommended). Optional tools include a miter box for cutting parts to length, files, center punch, and masking tape.

NOTE: Tempered glass cannot be cut.

Although safety tempered glass is very resistant to breakage, the glass can still break if unequal pressure is placed on it during installation. Use caution. In addition, the sharp corners of the panels can damage tile and floor surfaces, so it is best to handle the glass panels carefully and protect the edges.

2150/3150 PARTS LIST

- A. 2 Wall Jamb
- B. 1 Tub Track
- C. 6 Plastic Wall Anchors
- D. 6 #8 x 1 1/2" Truss Head Screws
- E. 2 Nylon Spacers
- F. 2 Stainless Bumper Inserts
- G. 2 Clear PVC Jamb Bumpers
- H. 2 Nylone T-Locks
- J. 1 Header
- K. 2 Glazed Panels
- L. 4 HD Roller Bearings
- M. 4 #8-32 x 3/8" Hex Head Screws

- N. 2 Towel Bar Center Tubes
- P. 4 Plugs with Threaded Stud
- R. 4 Towel Bar Ferrules
- S. 4 90 Deg. Towel Bar End Sections
- T. 4 #10 x 1 1/8" Flat Head Screws
- U. 2 Clear Towel Bar Caps
- V. 2 Clear Finger Pulls
- W. 4 Basco Decals
- X. 3 Clear Bottom Guides
- Y. 3 #6 x 3/8" Pan Head Screws
- AA. 2 Nylon Jamb Covers

****NOTE : Due to sizing, your unit may have a 1 piece tubular towel bar.****

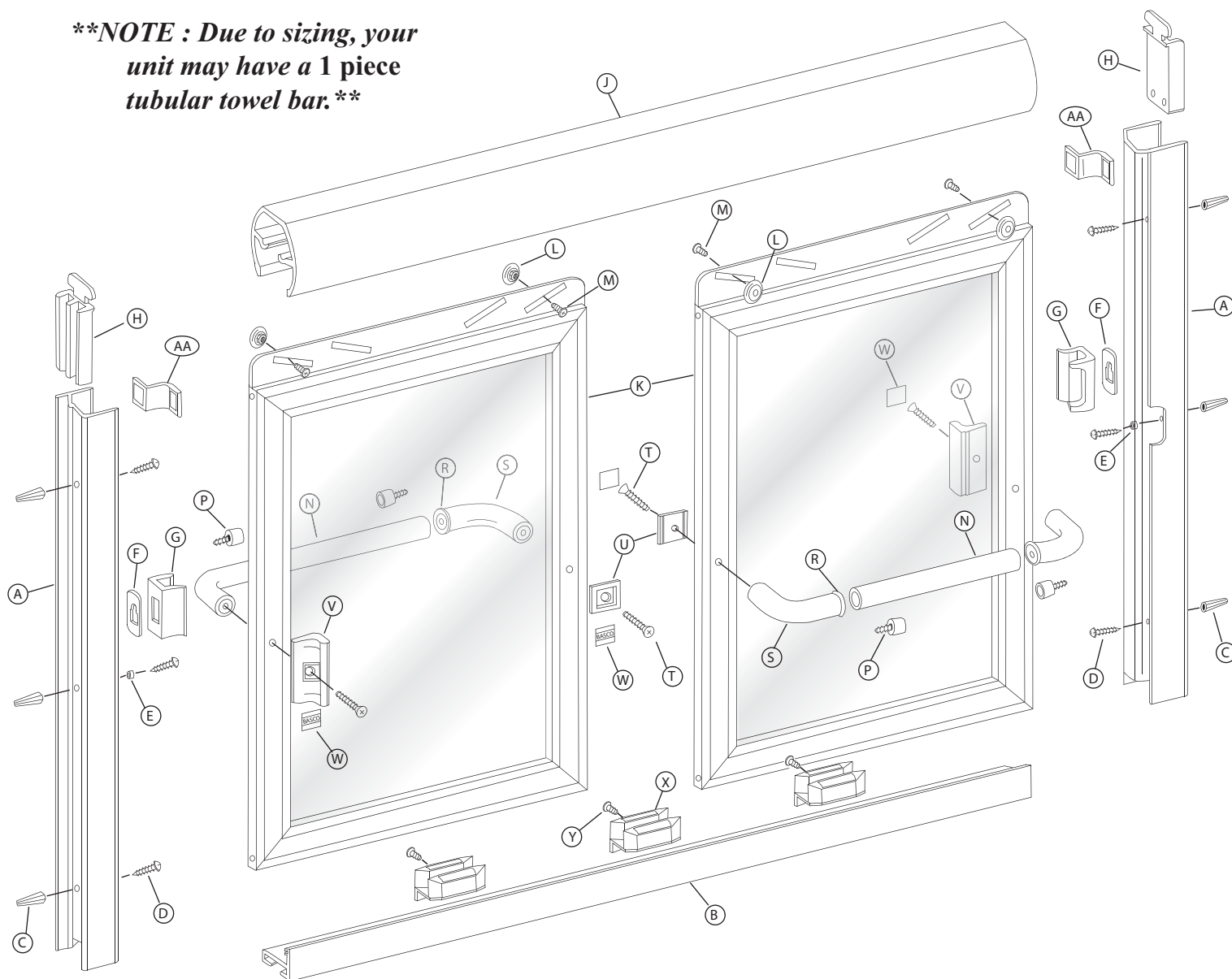

1 The 2150/3150 Supreme Bypass Bath Enclosure is supplied with reversible pocketed wall jambs [A]. The jambs are notched on both ends to fit over the tub track [B]. It is important to determine the proper orientation of the unit before marking and drilling the walls for the wall jamb attachment screws. For maximum waterproofing, position the interior panel closest to the shower head, as shown in the illustration.

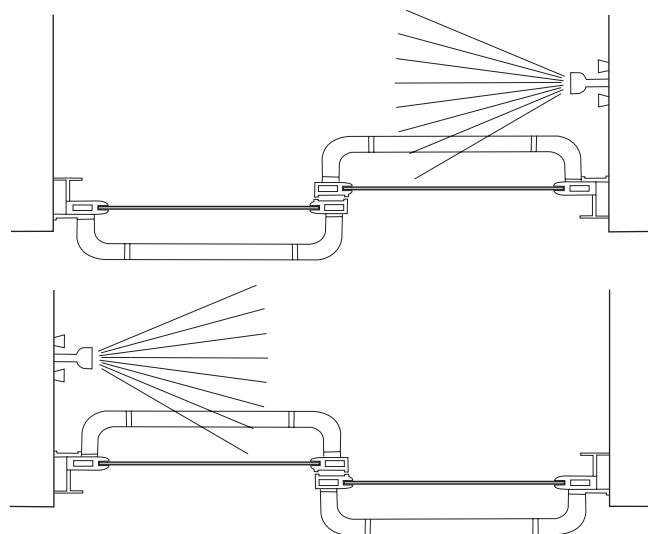

2 Measure the wall-to-wall opening along the center of the bath sill. Cut the tub track [B] 1/16" short of this dimension. An inexpensive miter box (available at your local hardware store) will help you get clean square cuts.

Position the tub track in the center of the tub rim with the tall leg to the exterior. It may be necessary to file a radius on the ends of the tub track and wall jambs to match the corners of the enclosure.

Press both wall jambs [A] into position over the tub track. Masking tape can be used to hold the parts in place temporarily.

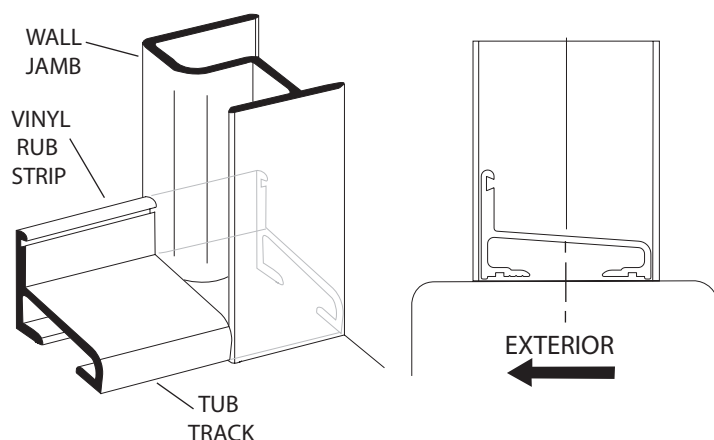

3 Use a level to plumb both wall jambs [A] then mark the pre-drilled hole locations on the wall. Lightly mark along both sides of the tub track [B] with a pencil, then remove all parts.

For tile or marble walls, drill six 3/16" diameter holes and insert the plastic wall anchors [C]. Attachments to fiberglass or acrylic units can be made in two ways. If reinforcement is built into the wall of unit, drill six 1/8" holes and install mounting screws directly into the reinforcement. If walls are not reinforced, drill six 3/16" holes and install plastic wall anchors or toggle bolts (toggle bolts not supplied by Basco).

CAUTION: The track should never be screwed to the tub. This will damage the tub and cause leakage.

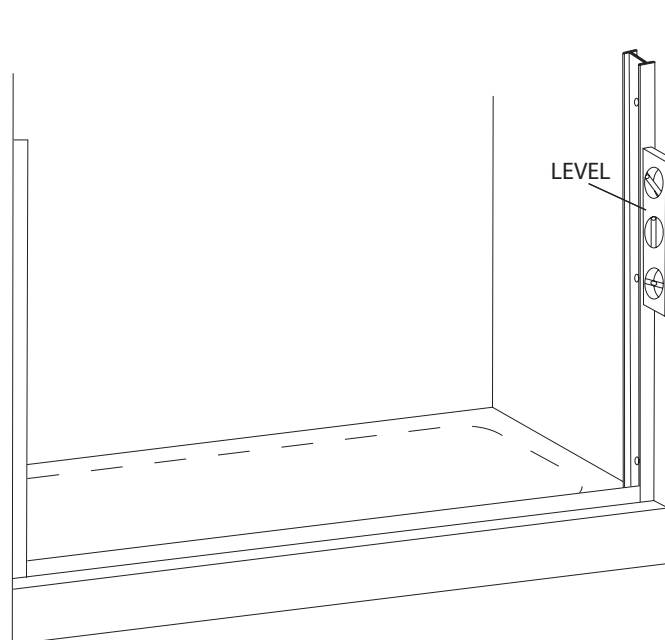

4

Before replacing the tub track [B], force a slight downward bow in the extrusion. This will ensure the track fits tight to the sill. Run a bead of caulk on both flat surfaces on the bottom of the tub track. Then replace the track on the bath sill in the exact position marked in Step #3 and with the tall leg to the exterior of the bath. Seat the tub track firmly.

NOTE: Improper caulking will result in leaks.

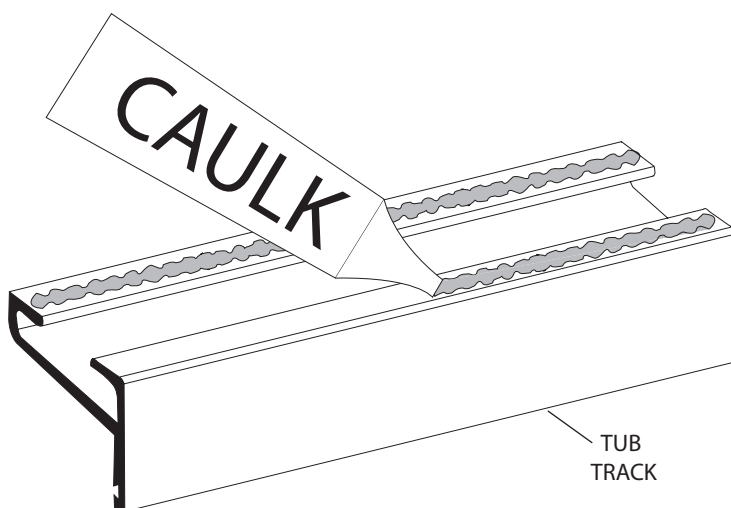

5

Replace one wall jamb [A] and attach it to the wall with two #8 x 1 1/2" truss head screws [D] inserted through the top and bottom holes. Slip a nylon spacer [E] over a #8 x 1 1/2" truss head screw and install in the center hole of the wall jamb. Check jamb for plumb and tighten screws. Repeat for the other wall jamb.

NOTE: Do not over-tighten the jamb screws.

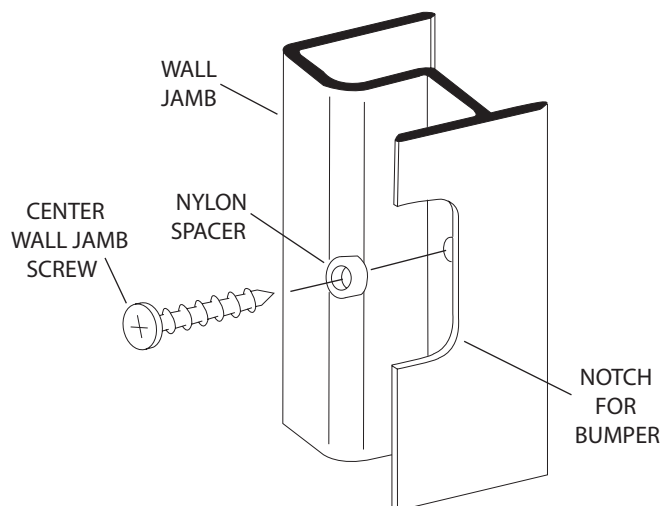

6

Slide the stainless steel bumper insert [F] into one of the clear molded jamb bumpers [G]. Slip the bumper into the upper portion of the notch in one of the wall jambs and snap it downward over the wall jamb screw [D] with the spacer [E].

Repeat with the other bumper on the opposite wall jamb.

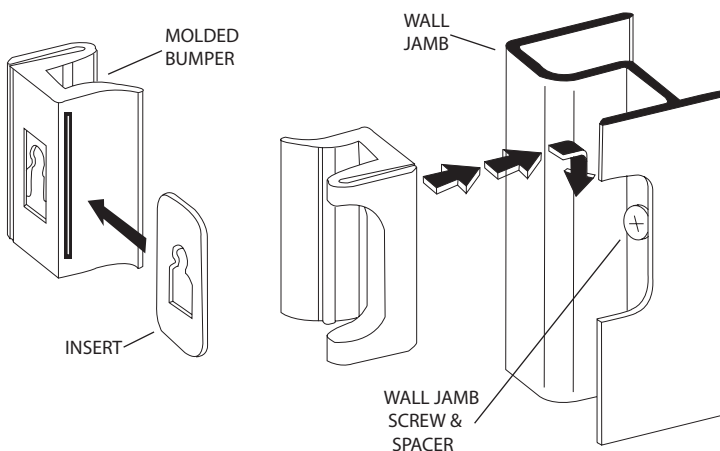

7

This bath enclosure is equipped with molded nylon T-locks [H] for safety. When properly installed, the header [J] is locked to the wall jambs [A] and cannot be accidentally dislodged.

Measure the wall-to-wall opening at the top of the wall jambs and cut the header 1/16" short of this dimension. Check the header for fit.

Slide the two T-locks into each end of the header as shown. Set the header down onto the wall jambs with the T-locks fitting into the space behind the wall jamb. Remove the top wall jamb screws [D]. Pull the header and T-locks downward until the top wall jamb screws can be reinstalled and tightened.

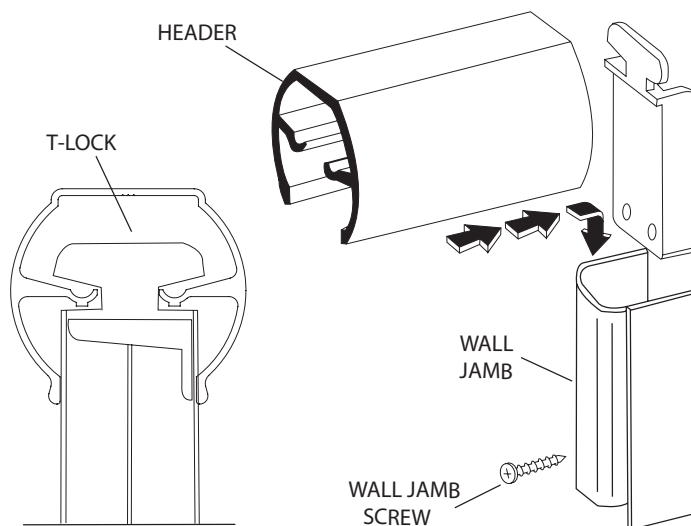

8

NOTE: Obscure glass doors should be installed with the rough surface of the glass to the exterior of the unit.

On doors with obscure or etched glass, there is an interior and exterior glazed door panel [K] as determined by the position of the top bearing fin. Door panels with clear glass are interchangeable.

Attach the four heavy-duty roller bearings [L] to the door panels as shown, using #8-32 x 3/8" hex head screws [M] centered in the outside slots in the top bearing fins.

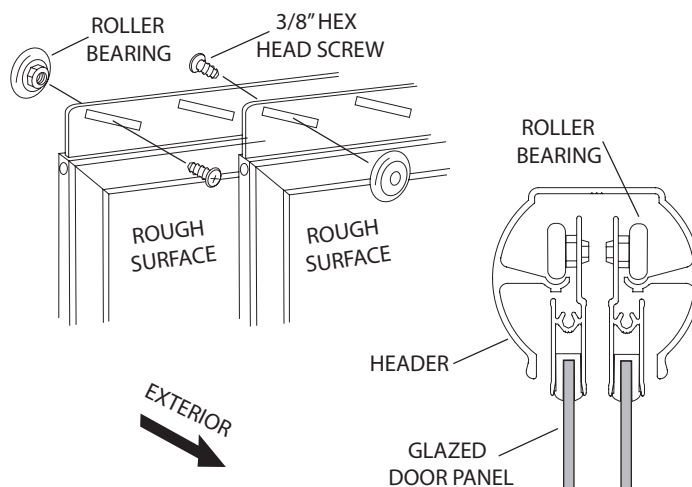

9

Lift the interior door panel [K] (rough surface away from the fin) into position with the roller bearings [L] engaging the roller slot in the header [J]. If the door panel is not parallel to the wall jambs, remove and adjust the roller bearings up or down to compensate.

Repeat for the exterior door panel (rough surface closest to the fin).

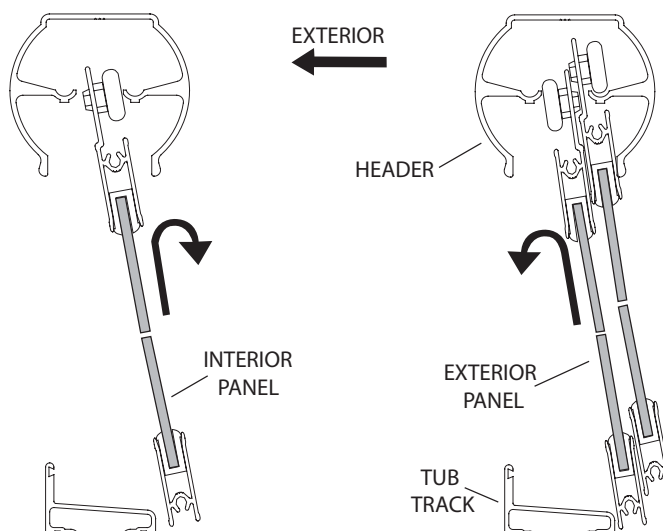

10

The two straight towel bar center tubes [N] should be cut 7 1/8" shorter than the length of the door panel's [K] bottom rail. The tubes must be cut square and the ends de-burred. Handle the tubes carefully to prevent scratching.

Drive a plug [P] (with threaded stud) into each end of the towel bar tubes until the spring steel locking ring is seated inside the tube 1/16" below the end of the tube. Fit a brass-colored ferrule [R] over each tube end. Screw the threaded studs into the towel bar 90° end sections [S] and tighten until the towel bar ends are aligned.

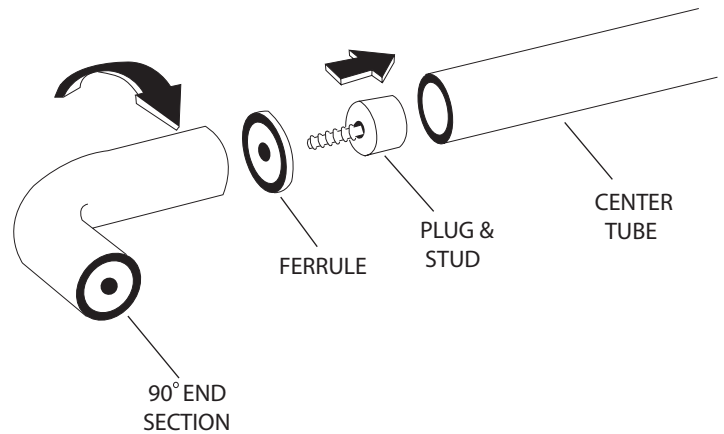

11a

FOR 5 PIECE TOWEL BAR

Attach one of the towel bar assemblies to the interior door panel with a #10 x 1 1/8" flat head screw [T] through a clear towel bar cap [U] and the inner rail. Insert a second #10 x 1 1/8" screw through a clear finger pull [V] and the outer rail and into the other end of the towel bar. Peel the backing from two of the Basco decals [W] and press them into the recesses in the towel bar cap and finger pull.

Repeat for the exterior door panel.

NOTE: Do not over-tighten the towel bar screws.

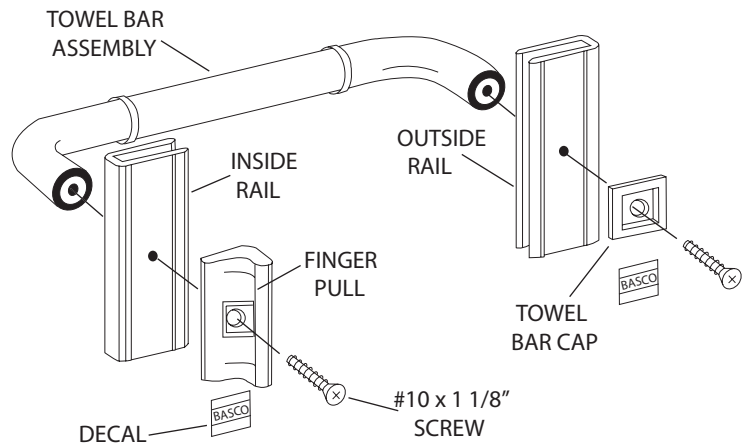

11b

FOR 1 PIECE TOWEL BAR

Attach one of the towel bars to the interior door panel with a #10 x 1 1/8" flat head screw [T] through a clear towel bar cap [U] and the inner rail. Insert a second #10 x 1 1/8" screw through a clear finger pull [V] and the outer rail and into the other end of the towel bar. Peel the backing from two of the Basco decals [W] and press them into the recesses in the towel bar cap and finger pull.

Repeat for the exterior door panel.

NOTE: Do not over-tighten the towel bar screws.

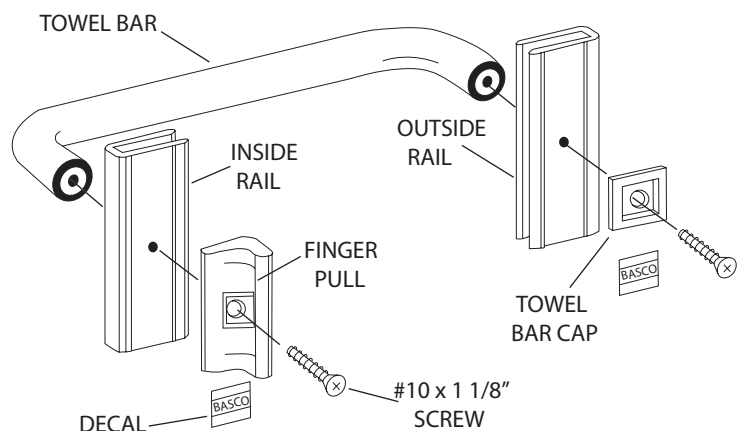

12

Locate one of the clear panel guides [X] in the middle of the tub track [B] with the door panels in the position shown. With a 7/64" bit, drill a hole into the V-groove through the mounting hole in the guide. Attach the center panel guide with a #6 x 3/8" pan head screw [Y] thru the drilled hole.

OPTION: Included in your hardware kit are two extra panel guides and screws that can be used in the center of each opening if desired.

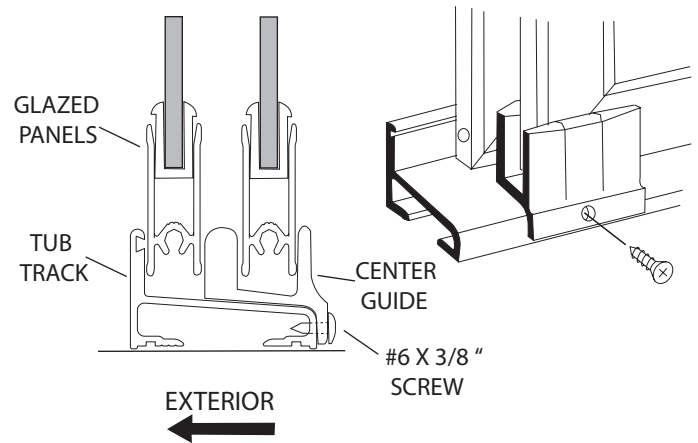

13

Peel the protective backing from the self-stick tape on the molded jamb covers [AA]. Attach the jamb covers to the upper end of the wall jambs [A] as shown to cover the tooling notches.

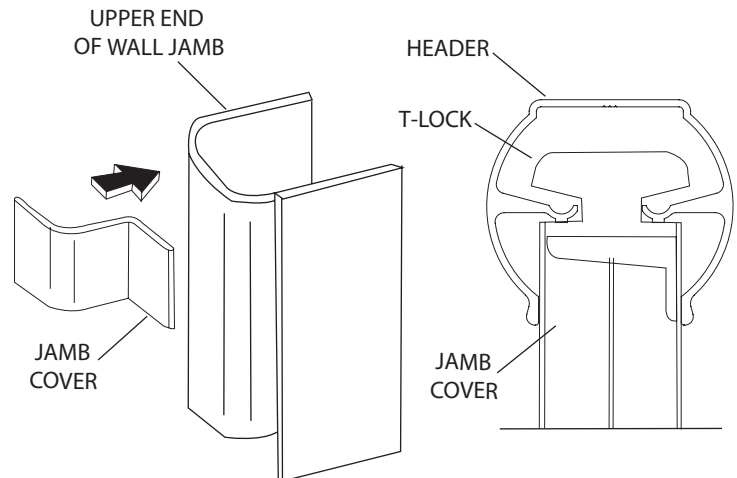

14

Neatly caulk each end of the tub track [B] where it meets the wall jambs [A] and along the interior edge of the wall jambs as shown. Run a bead of caulking along the interior edge of the tub track.

NOTE: The caulking should be allowed to cure for twenty-four hours before using your new bath enclosure.

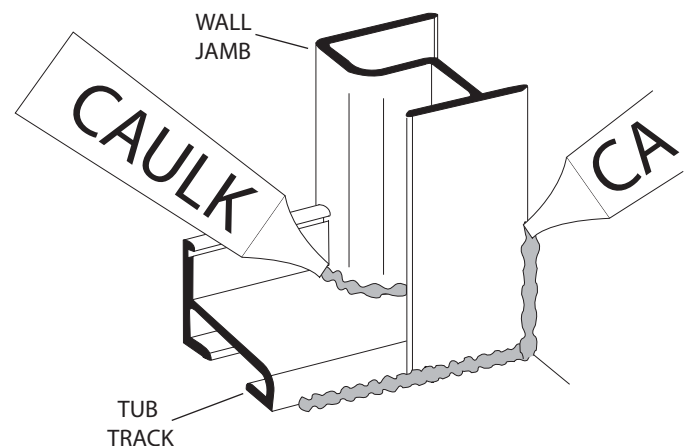

THRU-GLASS TOWEL BAR SUPPLEMENT

Slide one of the clear plastic discs [J], then a glass hole sleeve [K] onto the back plate [I]. Push the assembly through the hole in the glass panel, so that the glass hole sleeve is flush with the other side of the panel. Slide the other clear plastic disc onto the protruding end of the back plate, and then slide on the front plate [L]. Repeat this for the second hole on the panel. While holding the towel bar [N] in place, and screw the back plates into the towel bar.

I.	4	SC4581 Back Plates
J.	8	SC4582 Clear Plastic Discs
K.	4	SC4582 Glass Hole Sleeves
L.	4	SC4580 Front Plates
N.	2	Towel Bars
X.	1	SC5115 Allen Wrench

NOTE: Outer panel has towel bar facing Out.
In ner panel has towel bar facing In.

