

PARTNUMBER: luf80cseries-d ECN: REVISION: RELEASE DATE: 09/07/2005

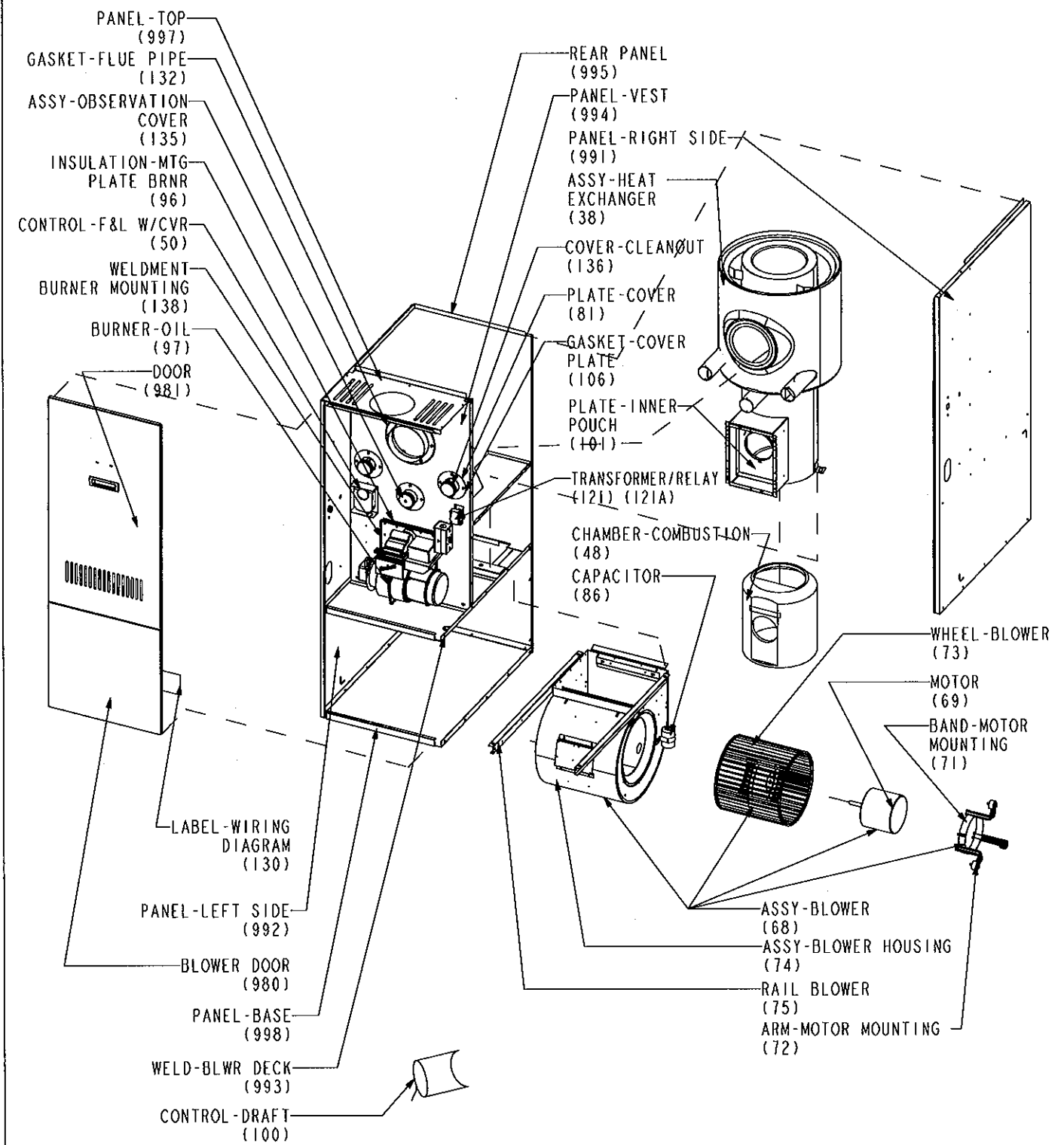

**Fastener/Screw Legend**

Motor Band Bolt	1/4-20 x 1.50 Grade 5 or Higher
Motor Leg Bolt	1/4-20 x 1.25 w/washer, Thread Forming
Flue Collar/Burner Mount Screws	#10 x .75 Type AB
Cleanout Cover Screws	#8 x .50 Type AB S.S.
Standard Cabinet Screws	#8 x .50 Type AB S.M.

**LUF80CSERIES-D**

The following parts are in 1.201035 RLUF80C112/125D20-2:						
Ref #	Part #	Description	Status	Qty	Price	Additional Info
	06428D398	KIT-HEAT SINK ASINK588-1	Call for Status	1	<input type="checkbox"/>	
38	R42510-004	HEAT EXCHANGER	Active	1	<input type="checkbox"/>	
48	35K71	R41924-002 COMBUSTION CHAMBER	Active	1	<input type="checkbox"/>	
50	11M40	R02379A006 FAN - LIMIT CONTROL	Active	1	<input type="checkbox"/>	
68	R44554-011	ASSY-BLOWER 12 X 11 3/4HP	Active	1	<input type="checkbox"/>	
69	33H45	R47466-001 MOTOR 3/4HP1PH115V	Active	1	<input type="checkbox"/>	
71	33H39	R38180C001 BAND-MOTOR	Active	1	<input type="checkbox"/>	
72	46K05	R07408B008 ARM-MTR MTG	Active	4	<input type="checkbox"/>	
73	45M06	R02592A034 WHEEL-BLOWER	Active	1	<input type="checkbox"/>	
74	R44777-008	ASSY-BLOWER HOUSING	Active	1	<input type="checkbox"/>	
75	R33328C017	RAIL-BLOWER SUPPORT	Active	2	<input type="checkbox"/>	
81	R41804-001	PLATE-COVER	Active	3	<input type="checkbox"/>	
86	RS39232D008	12.5MFD@370V CAP. & BOOT	Active	1	<input type="checkbox"/>	
96	33H06	R37818B001 GASKET	Active	1	<input type="checkbox"/>	
97	R100195-03	BURNER-OIL ARM1803	Active	1	<input type="checkbox"/>	
100	R01207B001	CONTROL-DRAFT	Active	1	<input type="checkbox"/>	
101	R32227B000	PLATE-INNER POUCH	Active	1	<input type="checkbox"/>	
106	35K72	GASKET	Active	3	<input type="checkbox"/>	
121	22W04	R07489B001 RELAY-BLOWER DPST	Active	1	<input type="checkbox"/>	
130	R46563-003	LABEL-WIRING DIAGRAM	Call for Status	1	<input type="checkbox"/>	
132	35K56	R38937B001 GASKET	Active	1	<input type="checkbox"/>	
135	R41812-001	COVER-OBSERVATION	Active	1	<input type="checkbox"/>	
136	R41811-001	COVER-CLEANOUT	Active	2	<input type="checkbox"/>	
138	R41821-001	WELDMENT-BURNER MTG	Active	1	<input type="checkbox"/>	
980	R42087-002L	PANEL-BLOWER DOOR	Active	1	<input type="checkbox"/>	
981	RS41789-002L	PANEL-FRONT ACCESS	Active	1	<input type="checkbox"/>	
991	R43083-003L	PANEL-RIGHT SIDE	Not Available	1	<input type="checkbox"/>	
992	R43083-004L	PANEL-LEFT SIDE	Not Available	1	<input type="checkbox"/>	
993	R41797-004	BLOWER DECK	Call for Status	1	<input type="checkbox"/>	
994	R41796-002	PANEL-VEST	Call for Status	1	<input type="checkbox"/>	
995	R41795-002L	REAR PANEL	Not Available	1	<input type="checkbox"/>	

997	R41794-002L	PANEL-TOP	Active	1	<input type="checkbox"/>	
998	R41792-002	PANEL-BASE	Active	1	<input type="checkbox"/>	